

Verschiedene Maurerarbeiten.

Geböschte Mauern.

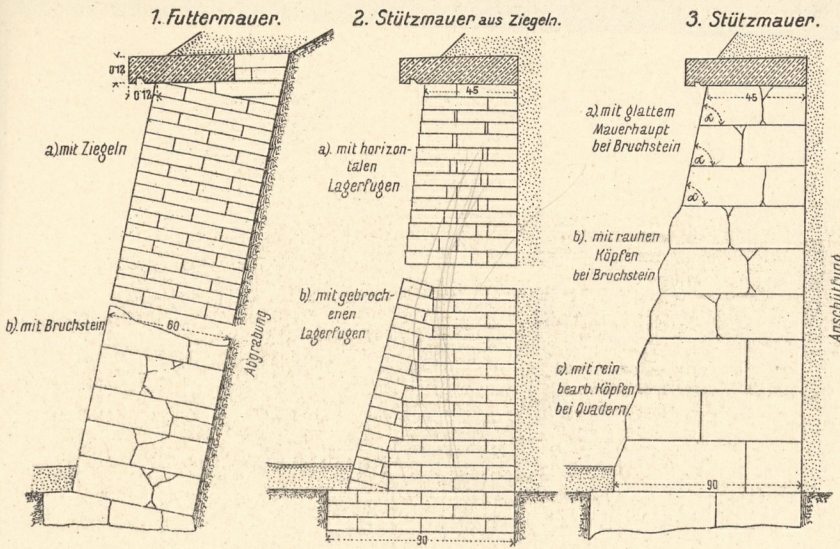

4. Pisee-Mauerwerk mit Kastenformen.

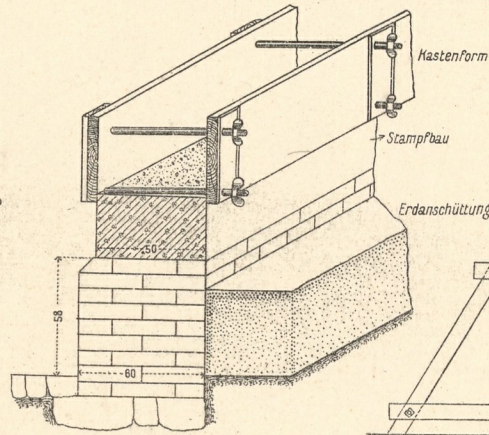

5. Betonmauerwerk mit Einschalung.

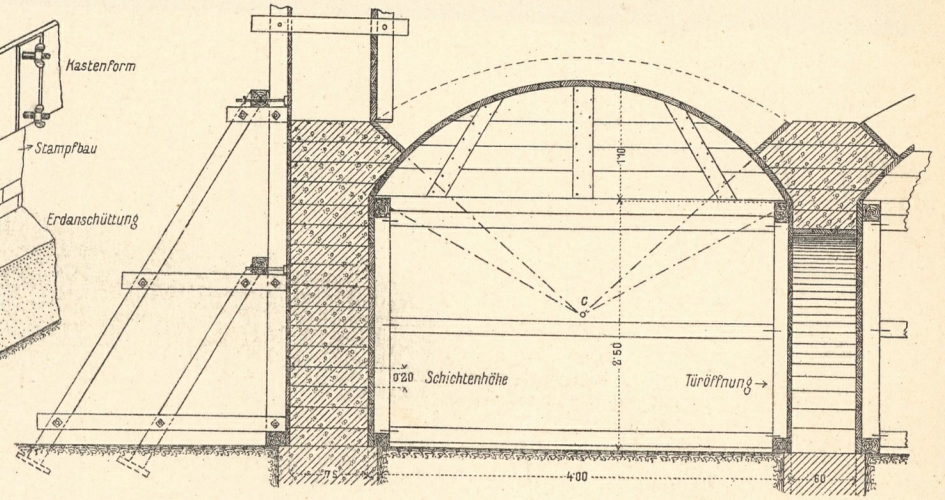

8. Betonmischapparate.

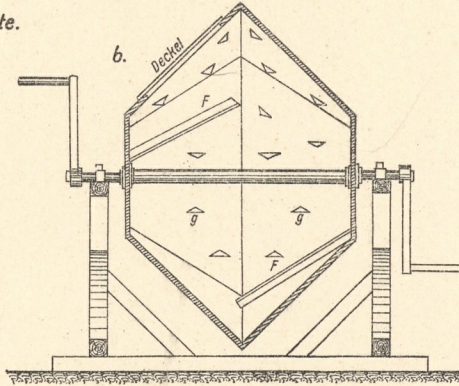
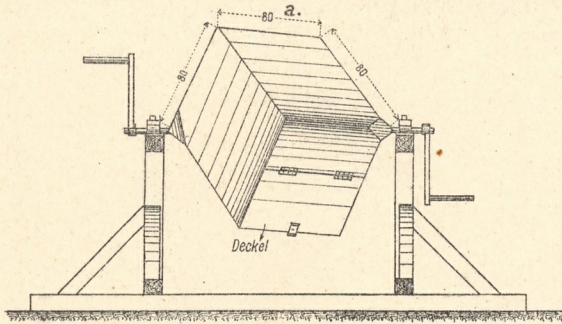

6. Einschalung für Betonmauern bei unhaltbarem Erdreiche.

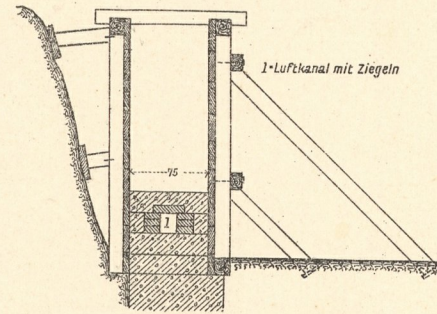

7. Betonierung von Rauch- und Ventilationschloten.

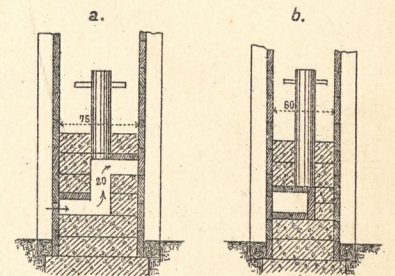

9a. Teil eines Fensters.

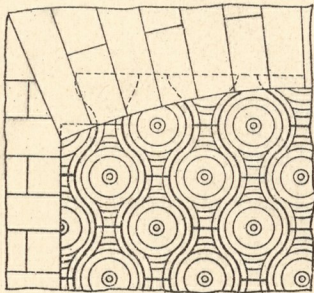

b. Glasbaustein Type 8.

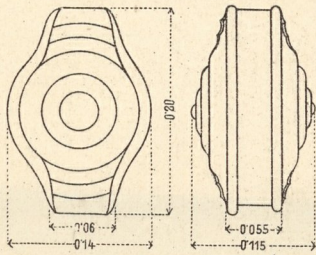

10a. Teil einer Wand.

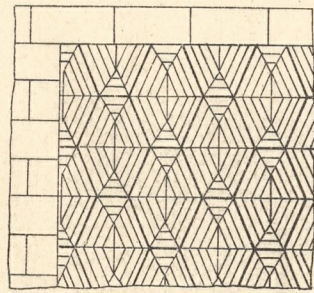

b. Glasbaustein Type 9.

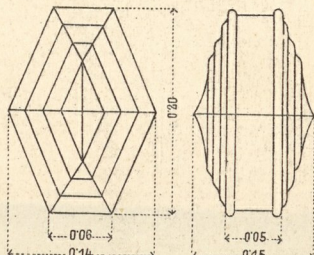

Wände und Decken aus Glasbausteinen.

11a. Teil einer Wand.

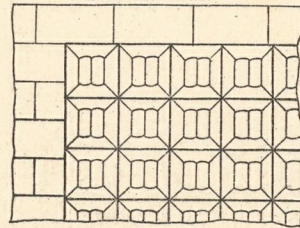

b. Glasbaustein Type 6.

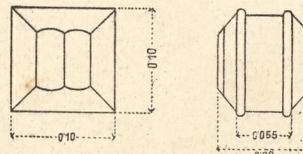

12a. Teil einer gewölbten Decke.

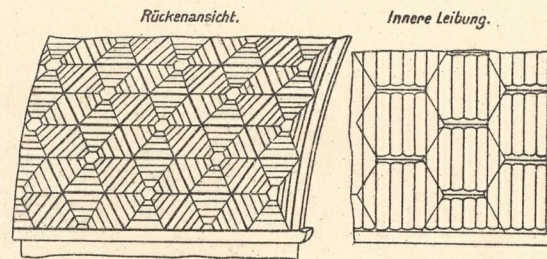

b. Glasbaustein Type 7a.

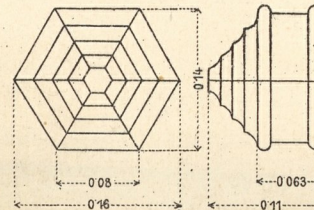

13. Querschnittsdimensionen.

