

1. Abgesetzter Zapfen. 2. Teufelsschluß. 3. Fugen mit Einschubleisten.

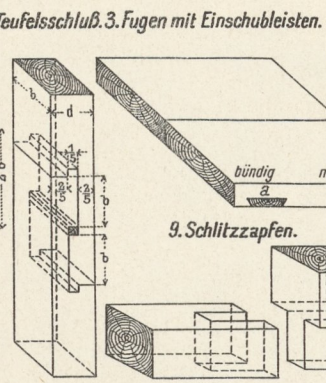

4. Verbindung mit Hirnleisten.

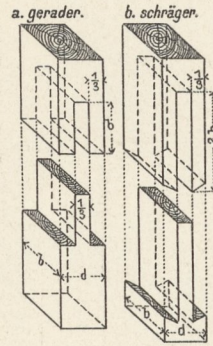
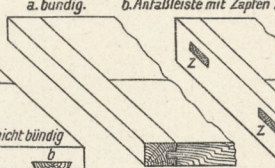

5. Verbindung mit Rahmen, Fries und Füllungen.

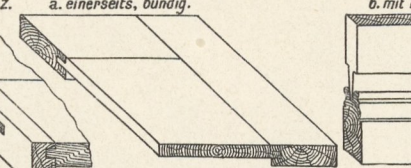

6. Verzinkung.

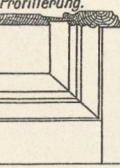

7. Verzapfung.



8. Vergabelung.

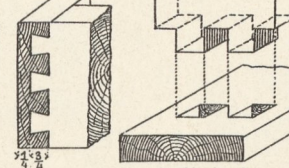

9. Schlitzzapfen.

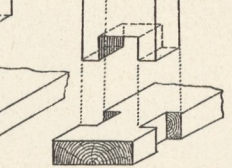

15. Nutzapfen mit Keil.

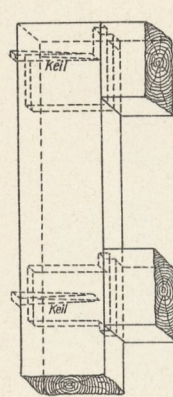

16. Ordinärer Fußboden.

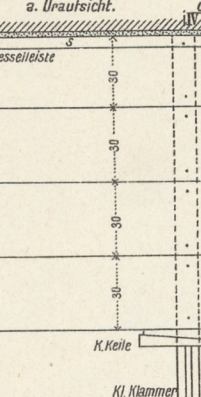

17. Schiffboden.

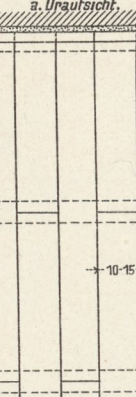

18. Friesboden (Brettboden).



14. Brettelboden in Asphalt gelegt.



19. Dessinfriesboden.

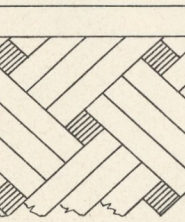

20. Parkettboden.

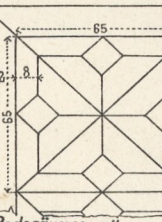

21. Detail der Sesselleisten.

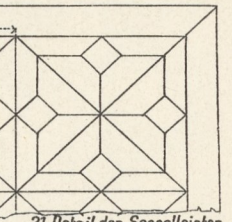

22. Wandvertäfelung.

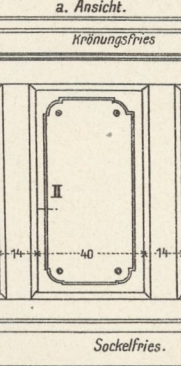

23. Wandvertäfelung.

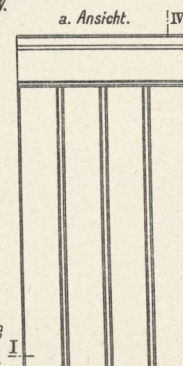

24. Abteilungswand mit Verglasung.

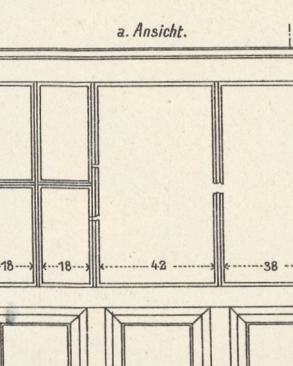

25. Wandverkleidung in Bäderräumen.

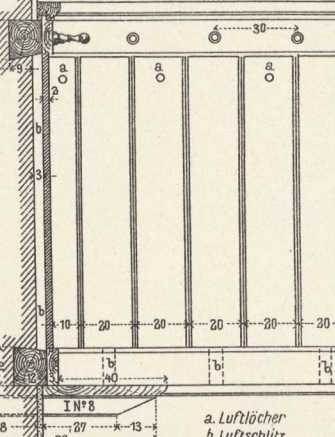

26. Abortsitzspiegel.

