



Abb. 1. Haus Prot in Westerland. Pesel.



Abb. 5. Haus Prot. Ecke der Osterstube.



Abb. 4. Haus Prot in Westerland.

a Schrank  
b Schornstein  
c Speisekammer  
d Bilegger

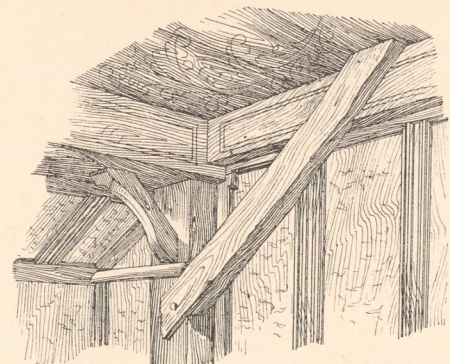

Abb. 18. Haus Hansen in Morsum auf Sylt.

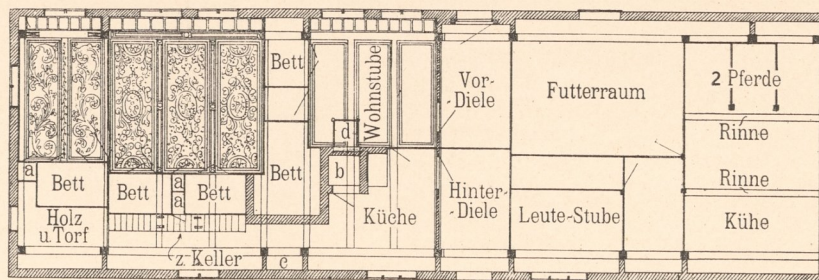

Abb. 26. Handtuchhalter aus Niebüll.



Abb. 27. Wandbracket aus Niebüll.

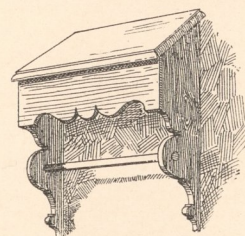

Abb. 13. Thüranker aus Nieblum.

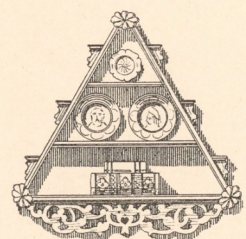

Abb. 3. Haus Prot. Schnitt durch den Pesel.

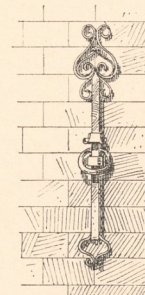

Abb. 28. Haus Hansen in Keitum. Spreize im Dachstuhl.

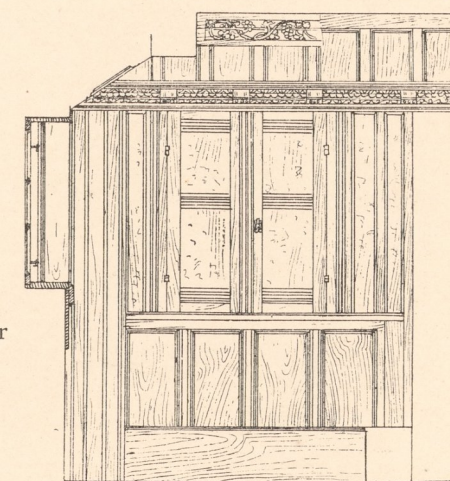

Abb. 8.

Aus Haus Prot. Peselgesims der Wandbekleidung.

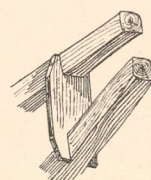

Abb. 6.

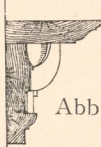

Abb. 2. Haus Prot in Westerland auf Sylt.

Masstab zu Abb. 2, 14, 15 u. 16.

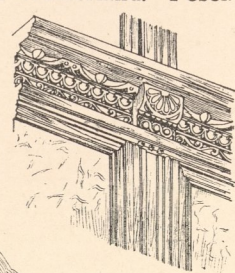

Abb. 29. Aus Haus Hansen in Keitum.

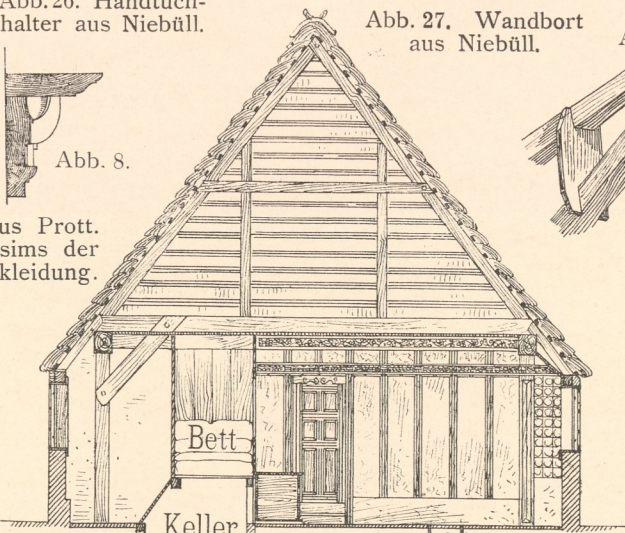

Abb. 17. Aus Lindholm.

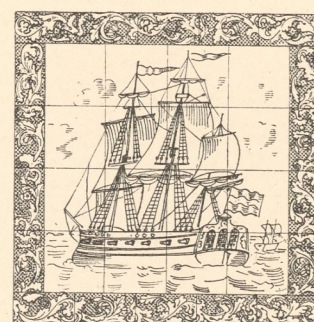

Abb. 11 und 12.

Hallig Hooge. Hanswarf.

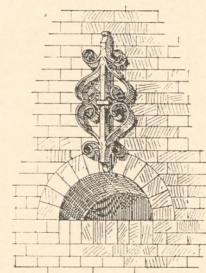
Masstab zu Abb. 9-12.

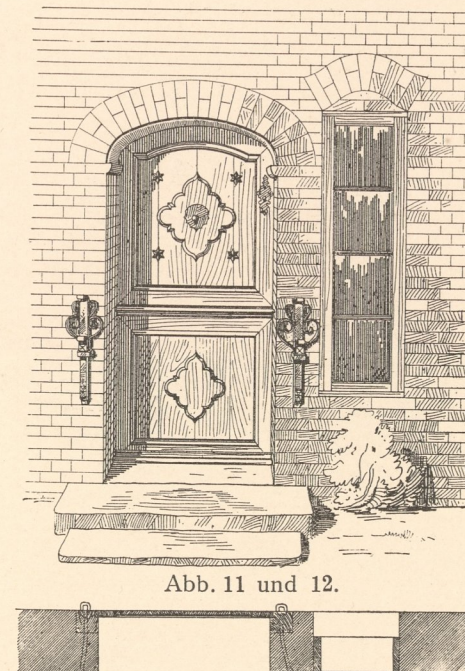

Abb. 9 und 10.



Hausthor Bundes in Wenningstedt auf Sylt.

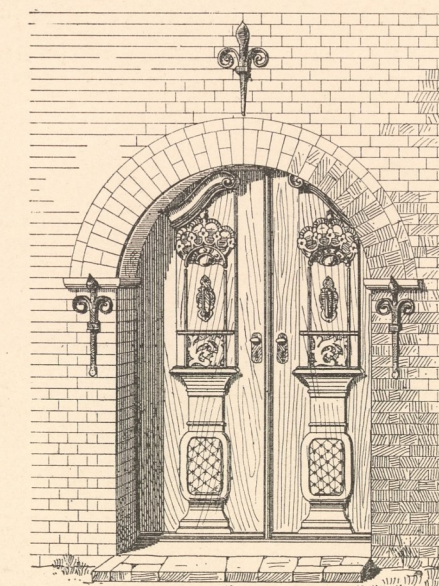
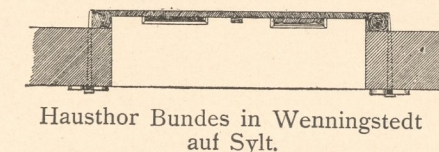

Abb. 16. Giebel aus Nieblum auf Föhr. 1637.



Abb. 14. Vom Hause Thiessen in Morsum auf Sylt.

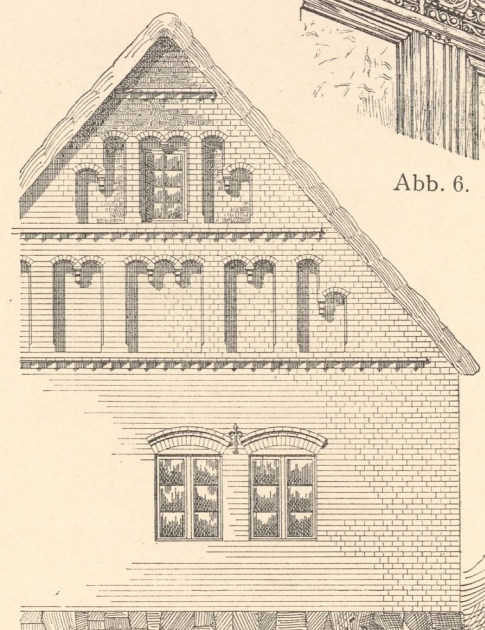

Abb. 25. Aus dem Königspesel auf Hallig Hooge. 1767.

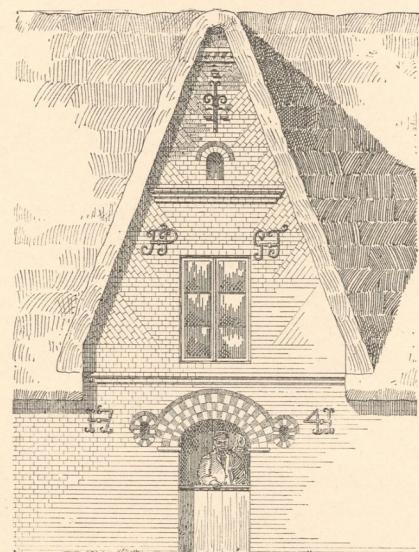

Abb. 15. Vom Hause Petersen in Amrum.

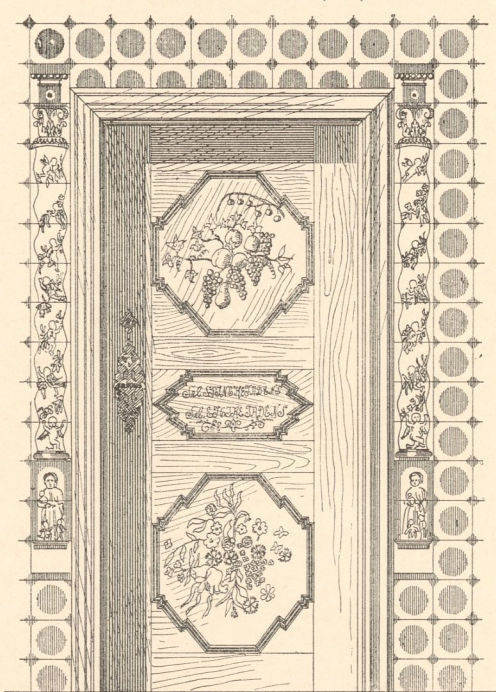

Abb. 20. Wick auf Föhr. Haus am Sandwall.

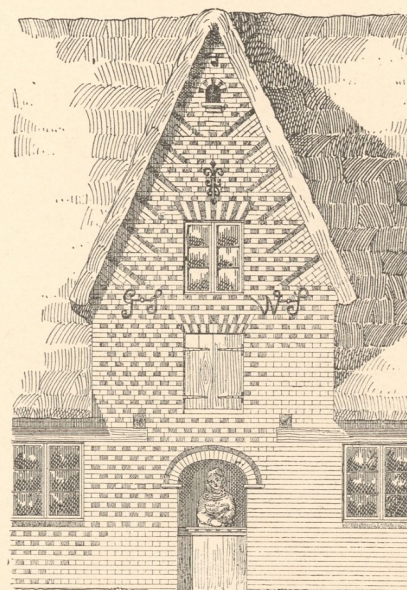

Abb. 21. Profila in Abb. 20.

Abb. 23.

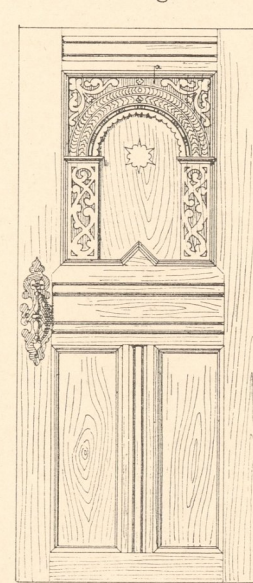
Abb. 23 u. 24. Details zu Abb. 22. Abb. 24.

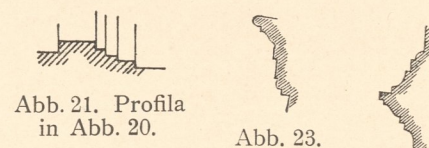

Abb. 22. Peselecke aus Süddorf auf Amrum.



Abb. 19. Haus Nanning Arften in Boldixum. Peselthür.

Aufgen. von Stoffers und Mühlke.

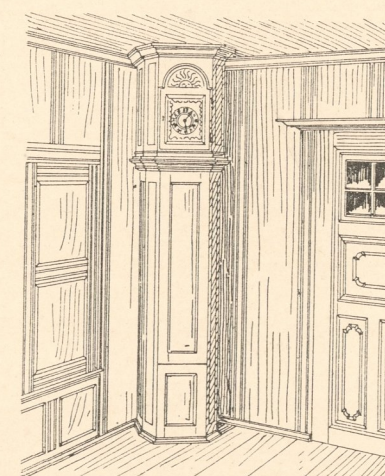
Zinkhochätzung von Albert Frisch, Berlin W.

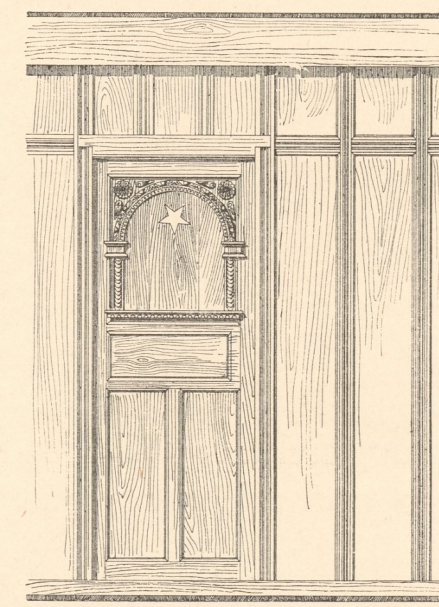
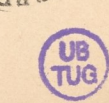

inventar  
Abb. 1  
Nr. 1204