

Abb. 1. Haus Schlappkohl. Nordgiebel.



Abb. 2. Haus Schlappkohl. Südgiebel.



Abb. 3. Haus Schlappkohl. Querschnitt.

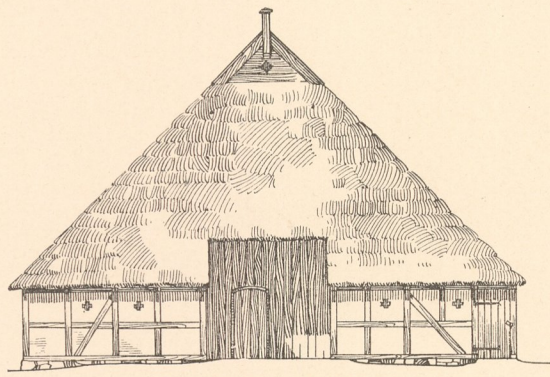

Abb. 14. Gut Hagen bei Probsteierhagen. Lageplan.

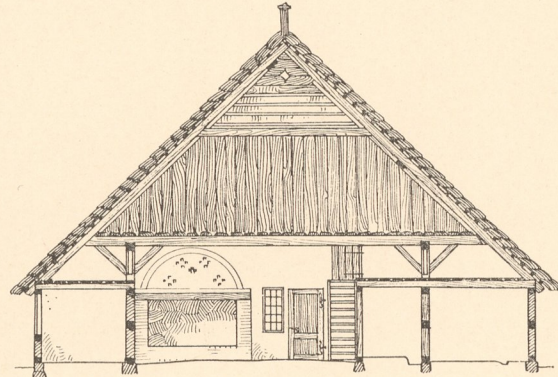

Abb. 6. Haus Schlappkohl in Toekendorf.

Massstab zu Abb. 6, 10 u. 13.

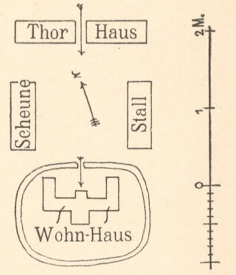

Abb. 9. Haus Hinrich Rix. Diele.

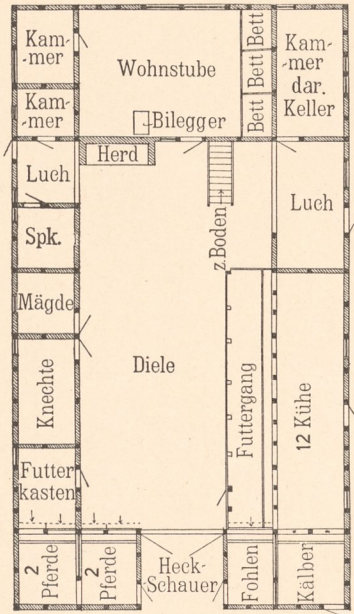

Abb. 5. Haus Schlappkohl. Längenschnitt.

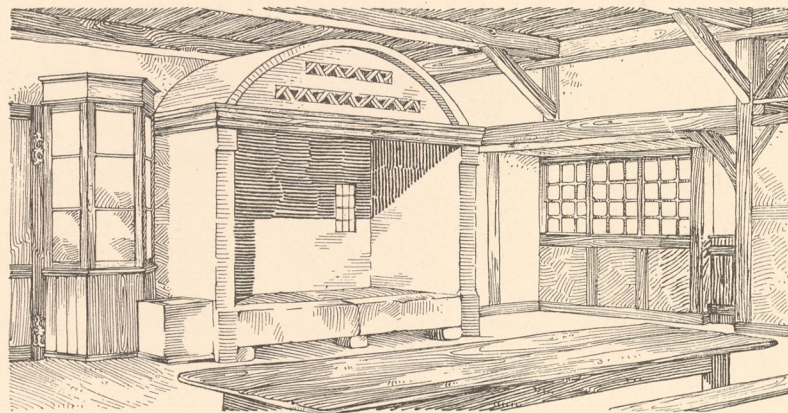

Abb. 4. Haus Schlappkohl. Lageplan.

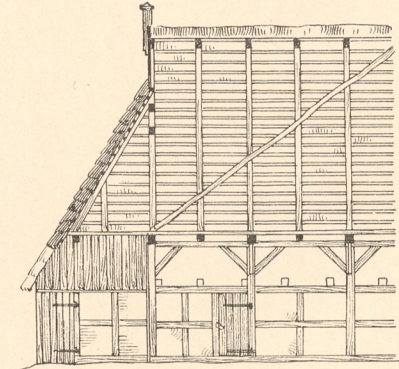

Abb. 23. Münsterdorf.

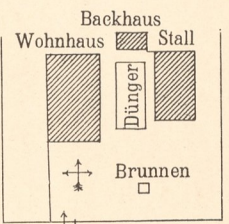

Abb. 24. Ziegelmuster von der Kieler Föhrde.

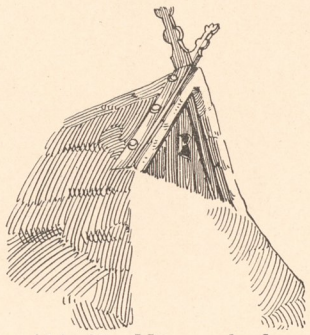

Abb. 11. Schönkirchen.

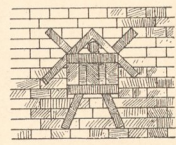

Abb. 7. Haus Schlappkohl. Kamin.

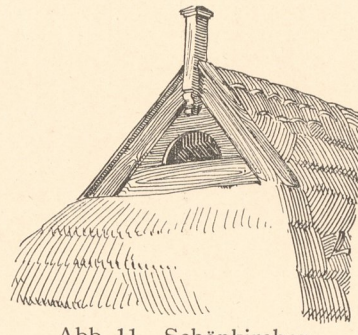

Abb. 20. Haus Storm in Daazendorf. 1634.

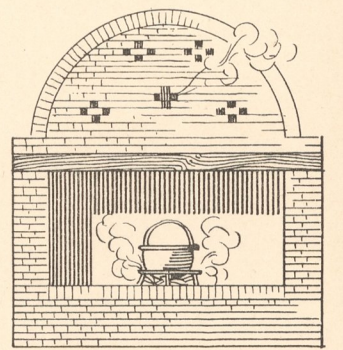

Abb. 13. Scheune auf Gut Hagen. Querschnitt.

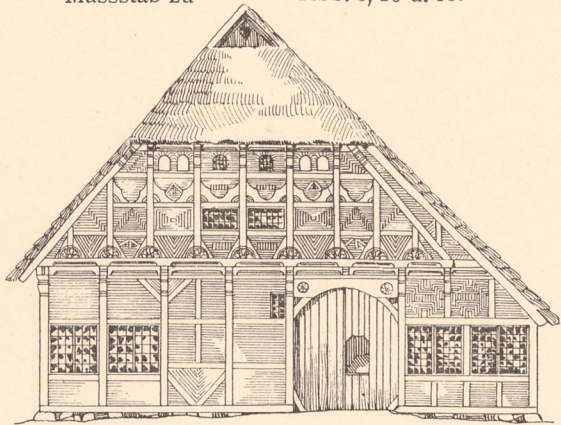

Abb. 8. Haus Hinrich Rix. Südgiebel.

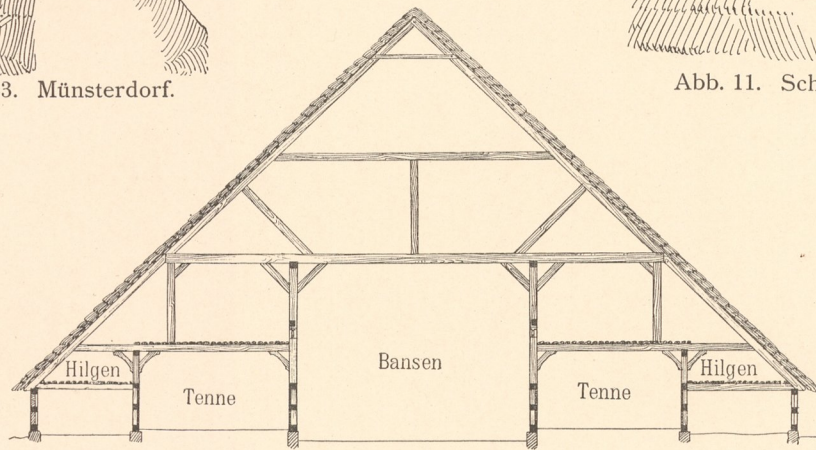

Abb. 15. Scheune auf Gut Hagen i. d. Probstei. 1:600.

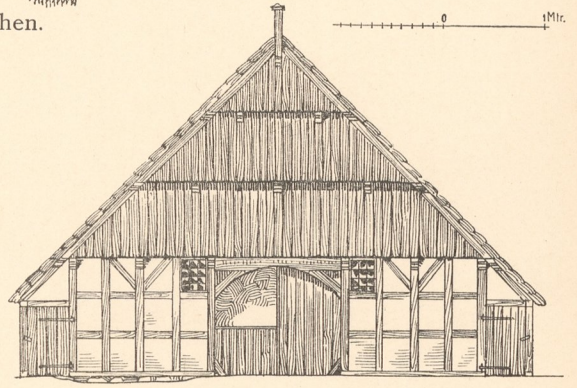

Abb. 17. Bansenwand aus der Scheune auf Gut Hagen.

Massstab zu Abb. 1, 2, 3, 5, 8, 16 u. 20.

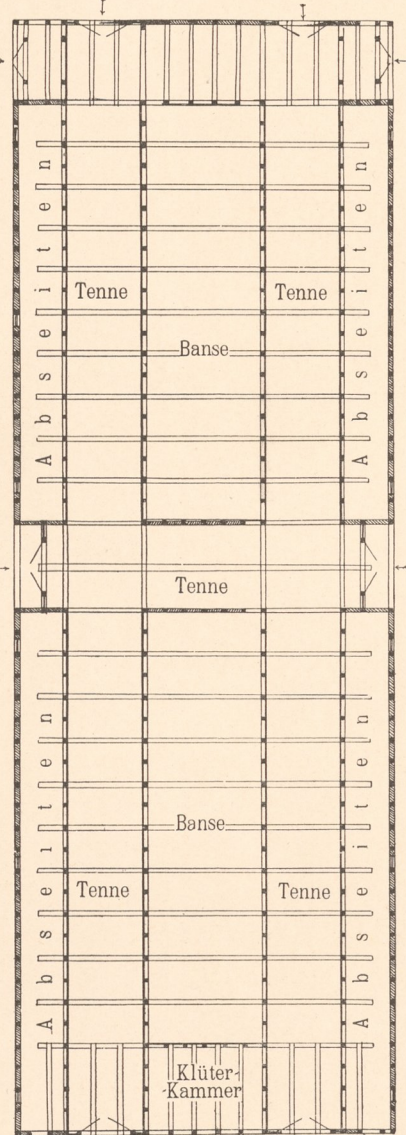
Abb. 21. Haus Storm. Giebelecke.

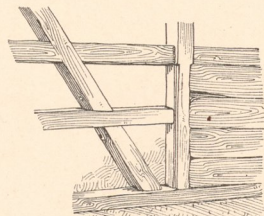

Abb. 16. Scheune auf Gut Hagen bei Probsteierhagen i. d. Probstei.



Abb. 10. Haus Hinrich Rix in Schönbeck. Grundriss.

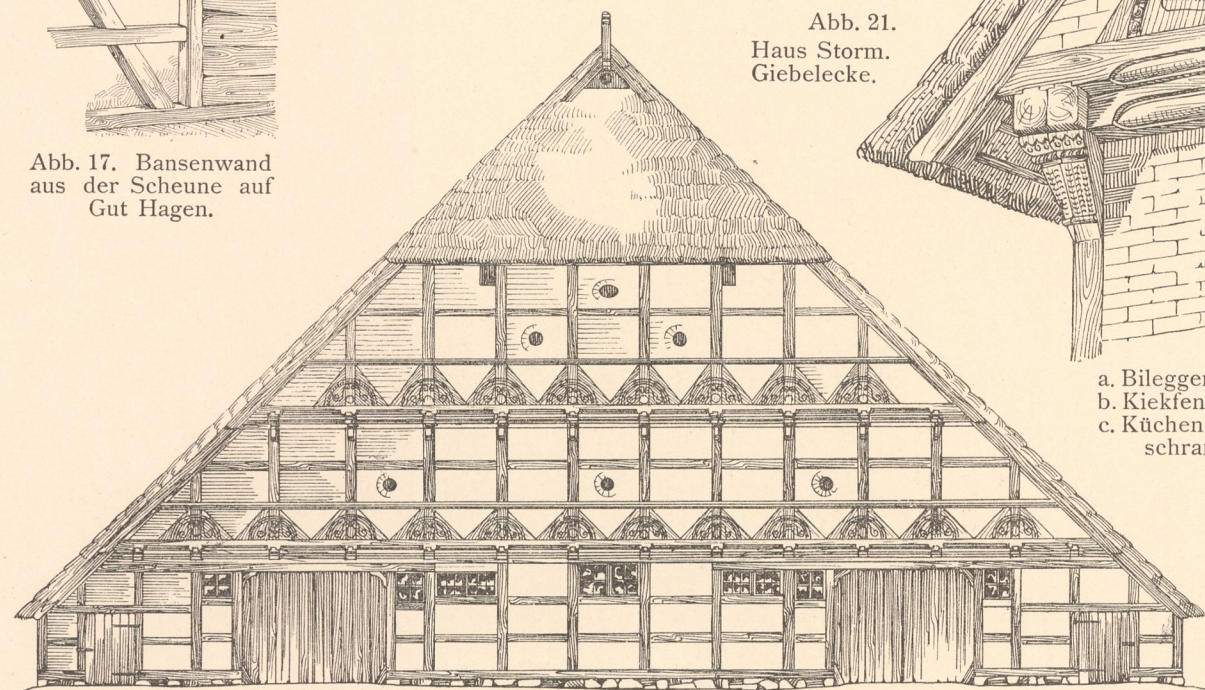

Abb. 18.

Abb. 19.

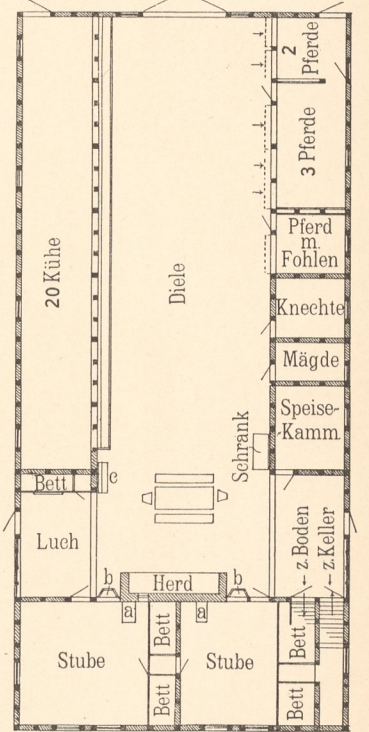
Abb. 18 u. 19. Einzelheiten zu Abb. 16.

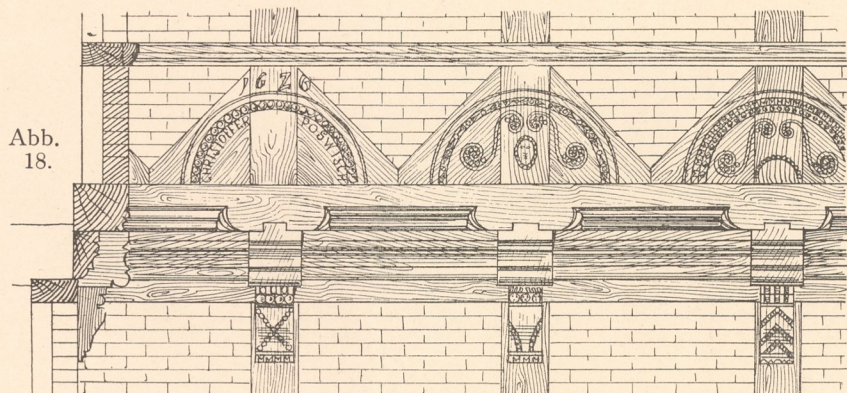

Abb. 22. Haus Storm. Rosette im Thorweg.



Abb. 12. Winseldorf.

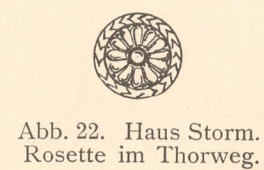