

Abb. 8. Hauberg bei Gaarding, gen. Stuckshof.



Abb. 1. Rother Hauberg. Ostansicht.



Abb. 7. Rother Hauberg. Lageplan.



Abb. 12. Hochdorfer Hauberg bei Gaarding-Tating. (1764.) Grundriss.

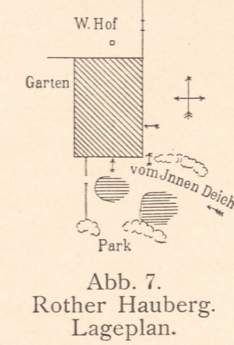

Abb. 4. Rother Hauberg. Querschnitt.

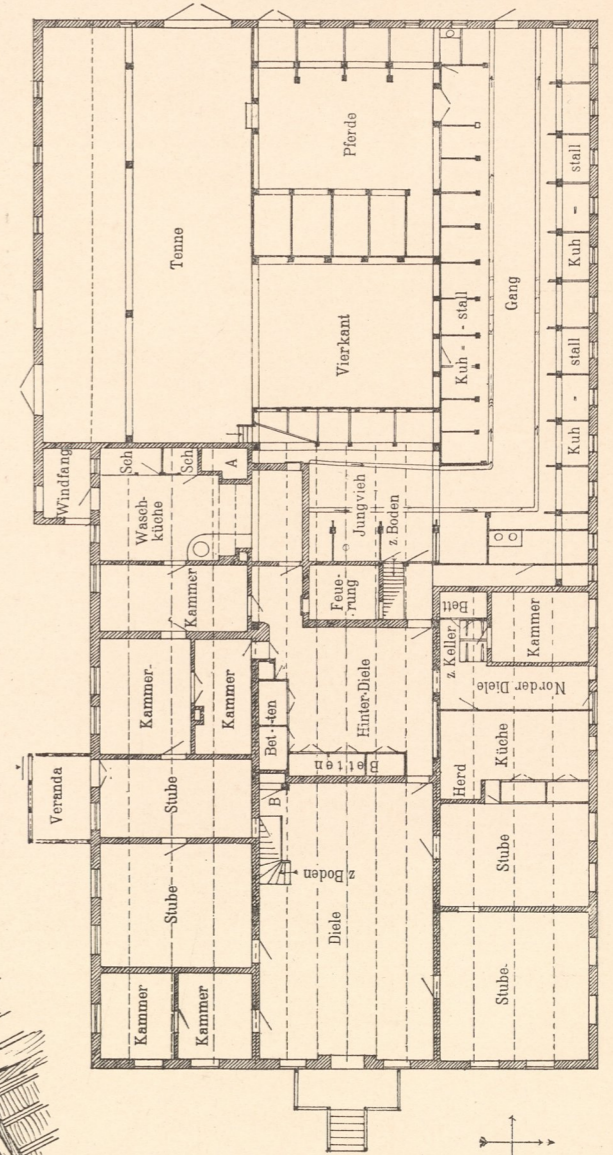

Abb. 2. Rother Hauberg. Nordansicht.

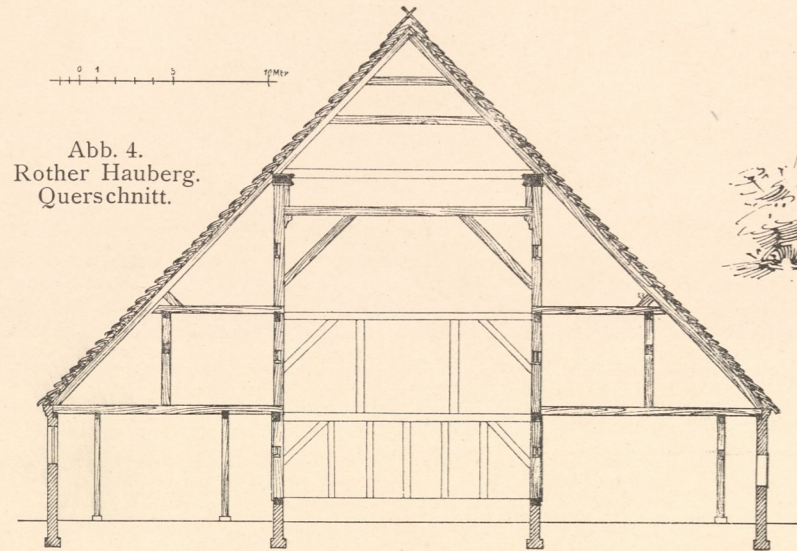

Abb. 5. Rother Hauberg. Eckstiel im Vierkant.

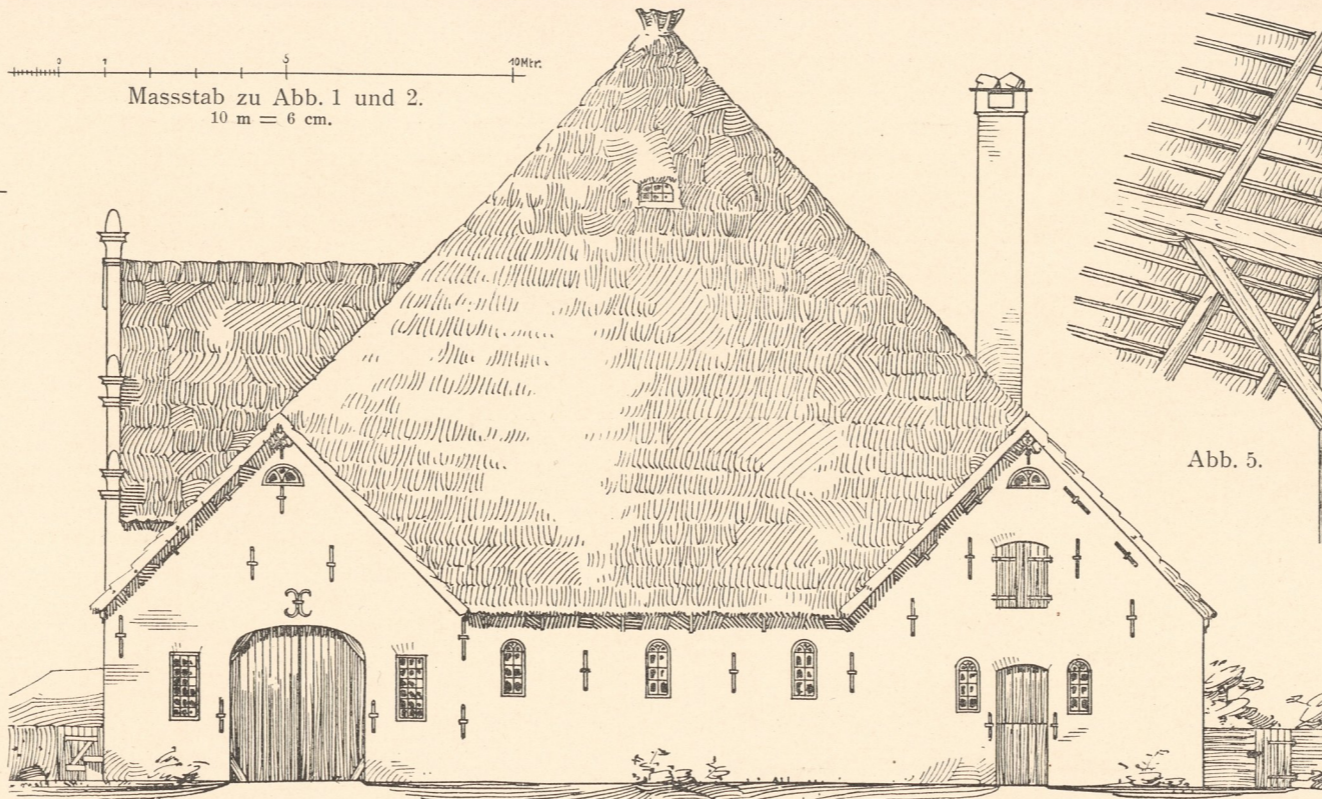

Abb. 9.

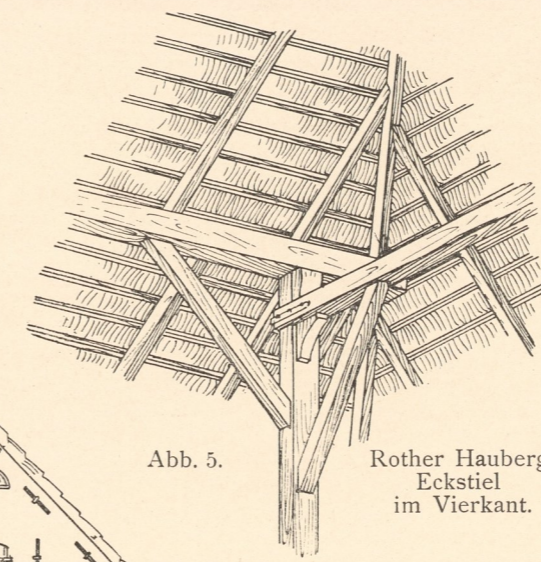

Abb. 10.

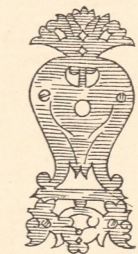

Abb. 3. Rother Hauberg. Grundriss.

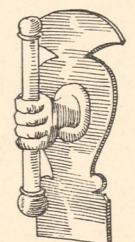

Abb. 13. Hochdorfer Hauberg. Längenschnitt.

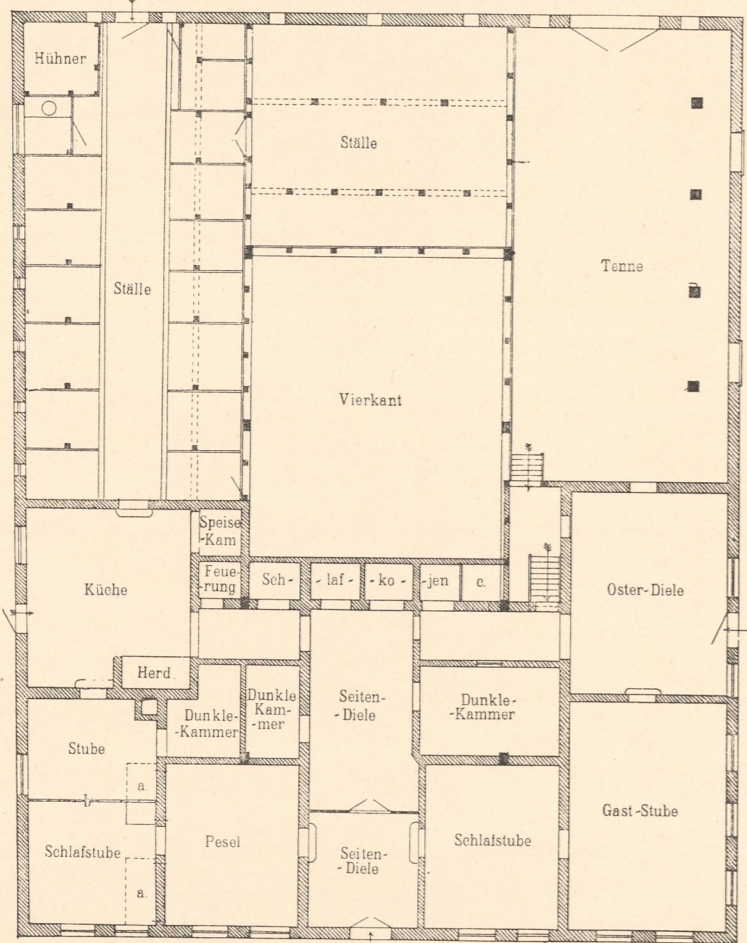

Abb. 6. Rother Hauberg. Längenschnitt.

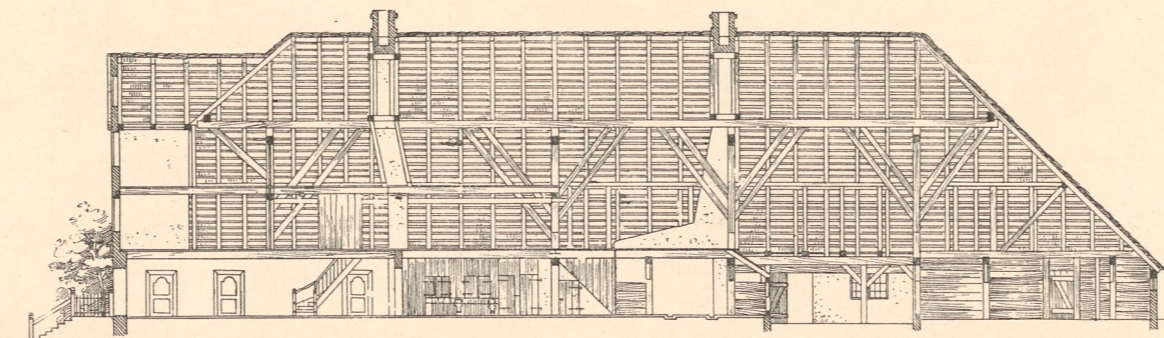

Abb. 11.

Masstab zu Abb. 1 und 2.
10 m = 6 cm.

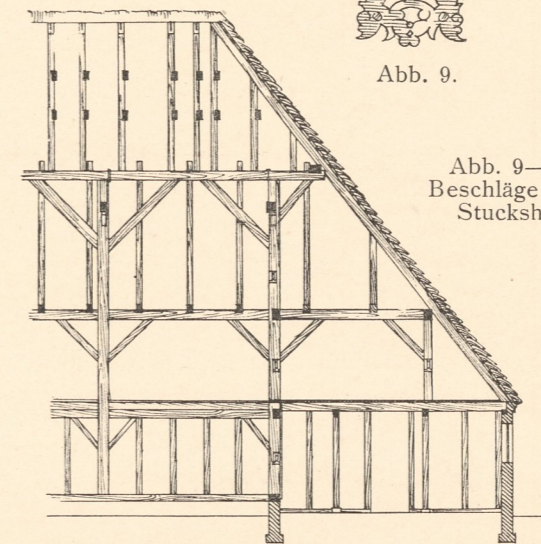
Masstab zu Abb. 12 und 13.

Masstab zu Abb. 12 und 13.

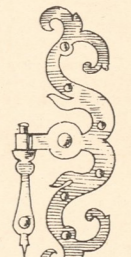

Inventar
Abth E
Nr. 1204