

Abb. 3. R. Schulz in Vissum. Erdgeschoss.



Abb. 5. Altenteil.



Abb. 4. R. Schulz in Vissum. Obergeschoss.

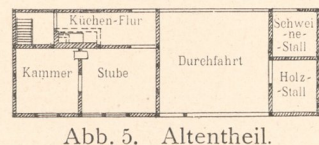

Abb. 8. Sallenthin. Schnitt A B.

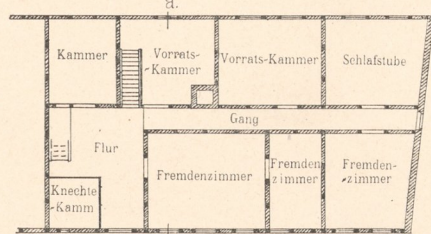

Abb. 9. Sallenthin. Grundriss der Scheune.

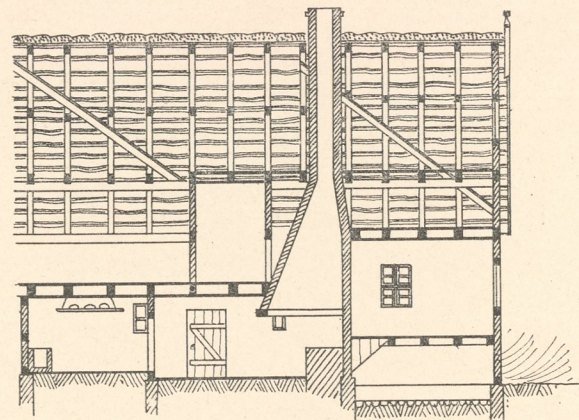

Abb. 10. Sallenthin. Grundriss des Wohnhauses.

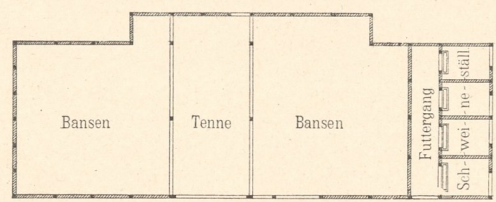

Abb. 15. Detail des Einganges.
Abb. 15 und 16. Vom Kuhstall des Joachim Baade in Vissum, erb. 1825.

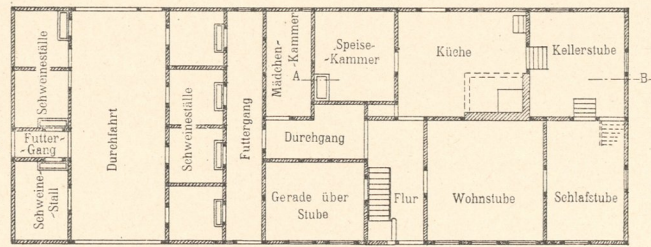

Abb. 13. Sallenthin. Lageplan.

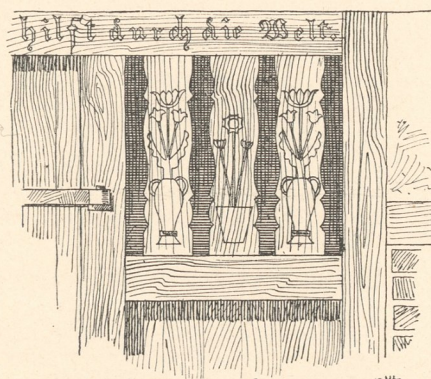

Abb. 16. Hexenkreuz.

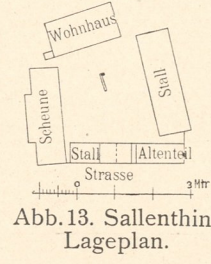

Abb. 14. Sallenthin. Detail des Einganges.

Abb. 8-14. Bauernhaus des H. Pfennigsdorf in Sallenthin, Kreis Salzwedel.

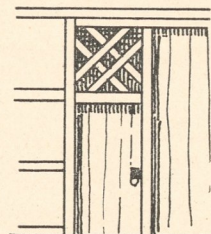

Querschnitt durch den Stall.

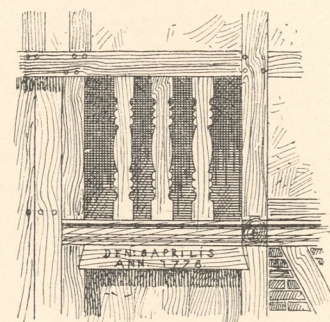
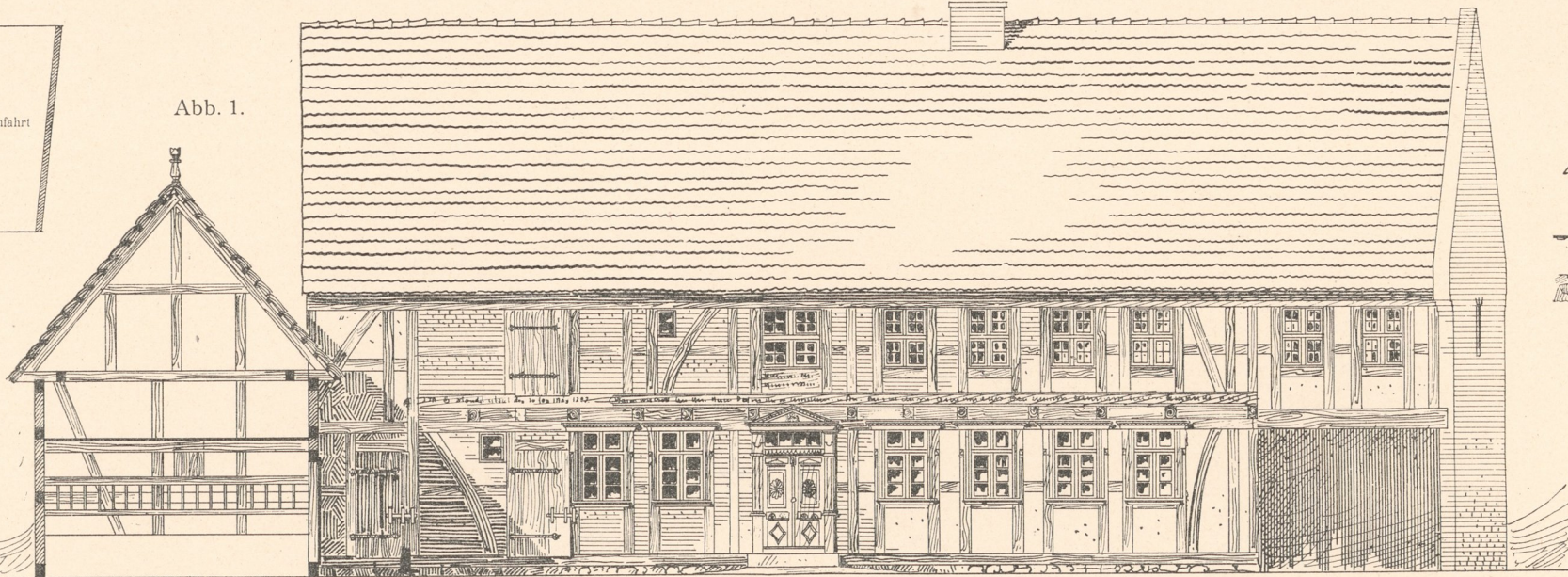
Abb. 1-7. Gastwirtschaft des Rudolf Schulz in Vissum, Kreis Salzwedel (früher Bauernhaus).



Abb. 7. R. Schulz in Vissum. Altenteil. Strassenansicht.



Abb. 19. A. Schulze Ww. in Vissum. Lageplan.

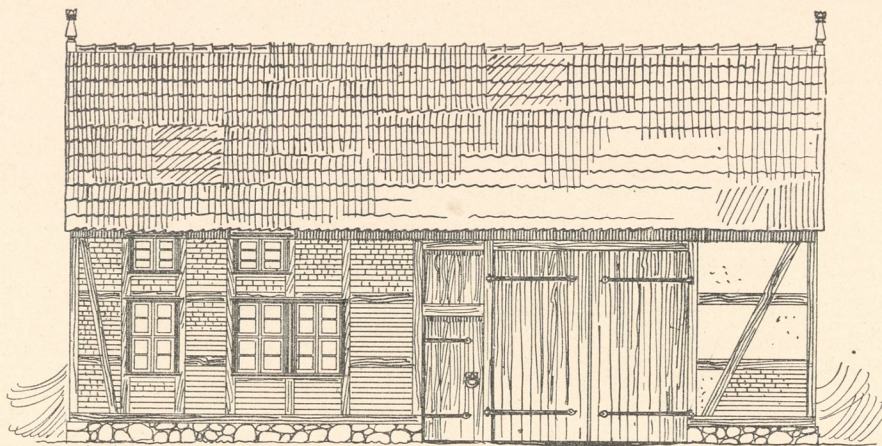

Abb. 17. Strassenseite des Pferdestalles.

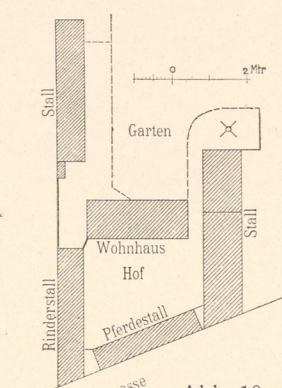

Abb. 17-19. Bauernhaus der Aug. Schulze Wwe. in Vissum.

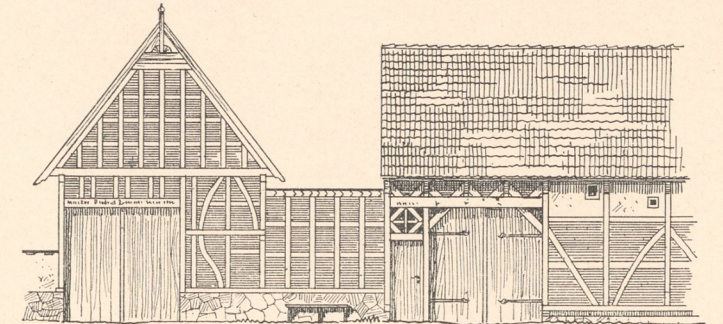

Abb. 20. Förderstedt. Ostfront.

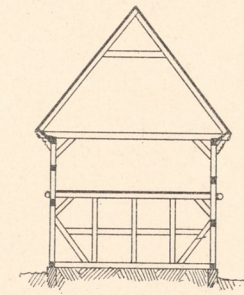

Abb. 11. Sallenthin. Grundriss des Altenteils.

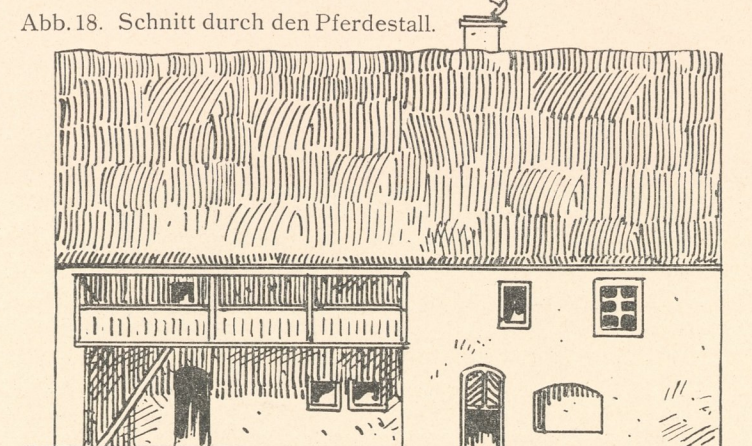

Abb. 21. Förderstedt. Obergeschoss.

Abb. 20-24. Wohnhaus Förderstedt.

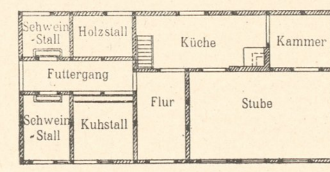

Abb. 23. Förderstedt. Schnitt e f.

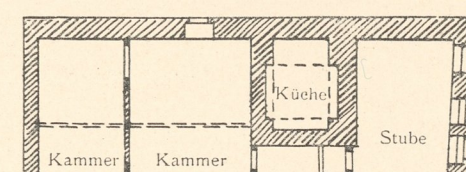

Abb. 22. Förderstedt. Schnitt a b.

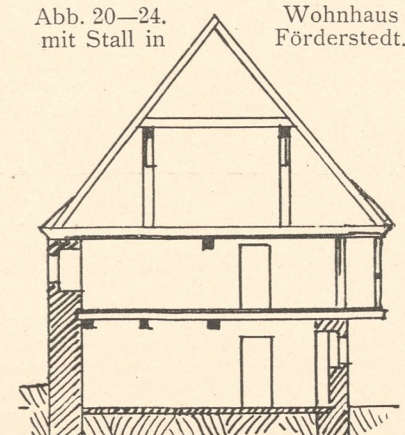

Abb. 24. Förderstedt. Erdgeschoss.

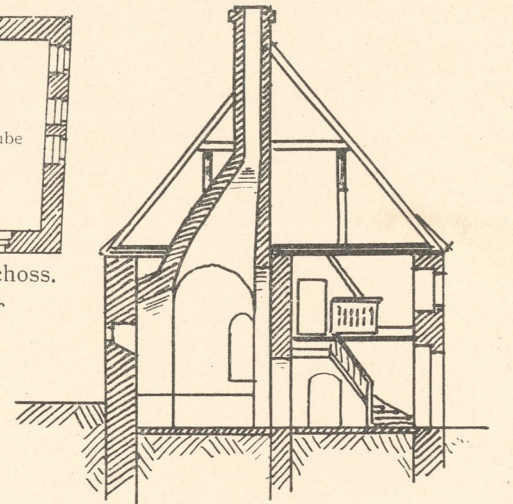

Abb. 2. R. Schulz in Vissum. Querschnitt a b durch das Wohnhaus.

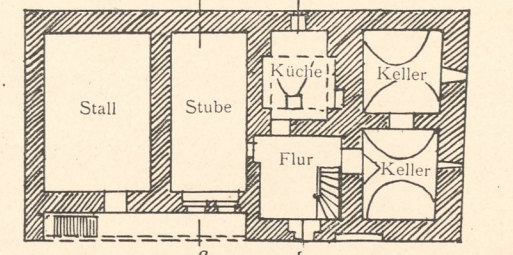

Abb. 12. Sallenthin. Grundr. des Stalles.

Inventar
Abth. E
Nr. 1204

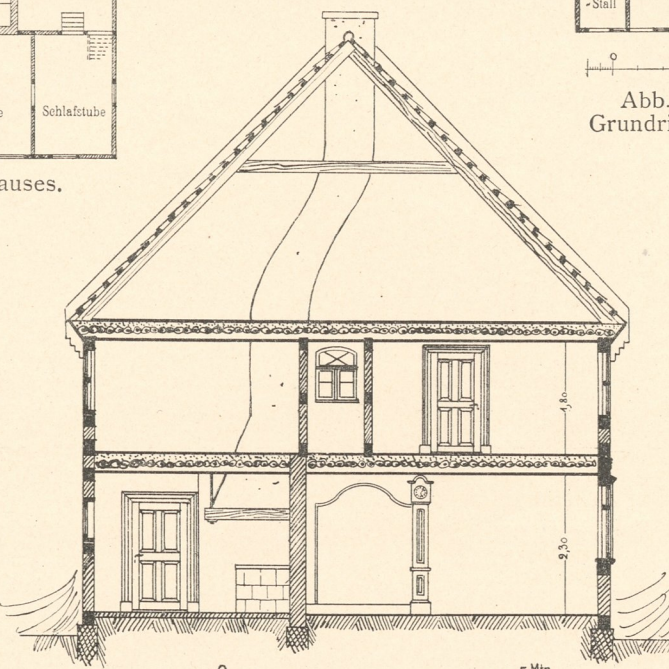
Verlag von Gerhard Küttmann, Dresden.

Zinkhochätzung von Albert Frisch, Berlin W.

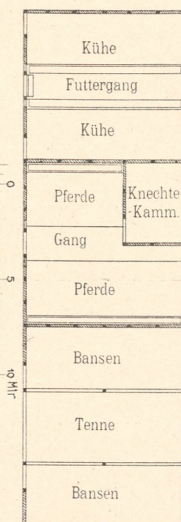