

Abb. 1. Nordansicht des Gehöftes.



Abb. 3.



Abb. 2. Nördliche Hofecke.

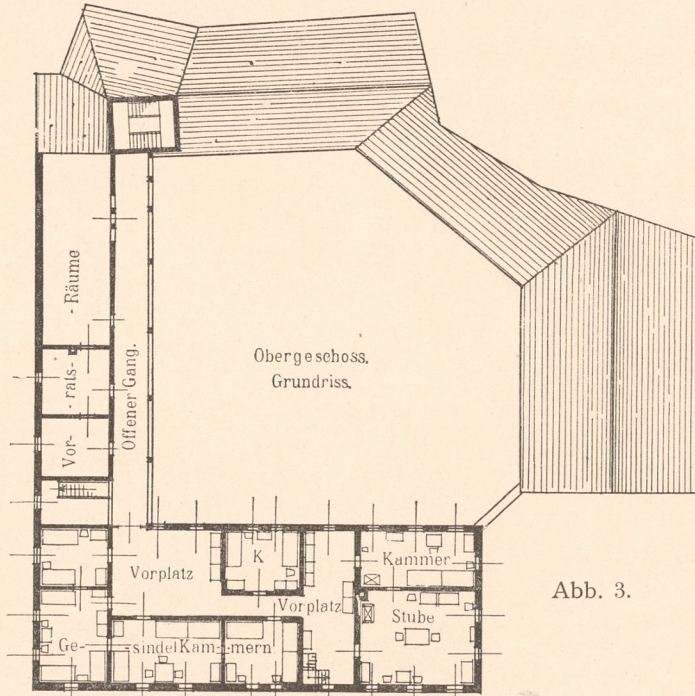

Abb. 9.

Abb. 7. Wohnhaus. Hofthüre.



Abb. 5. Wohnhaus. Südfront.

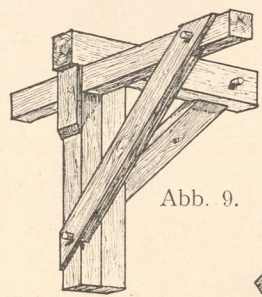

Abb. 4.

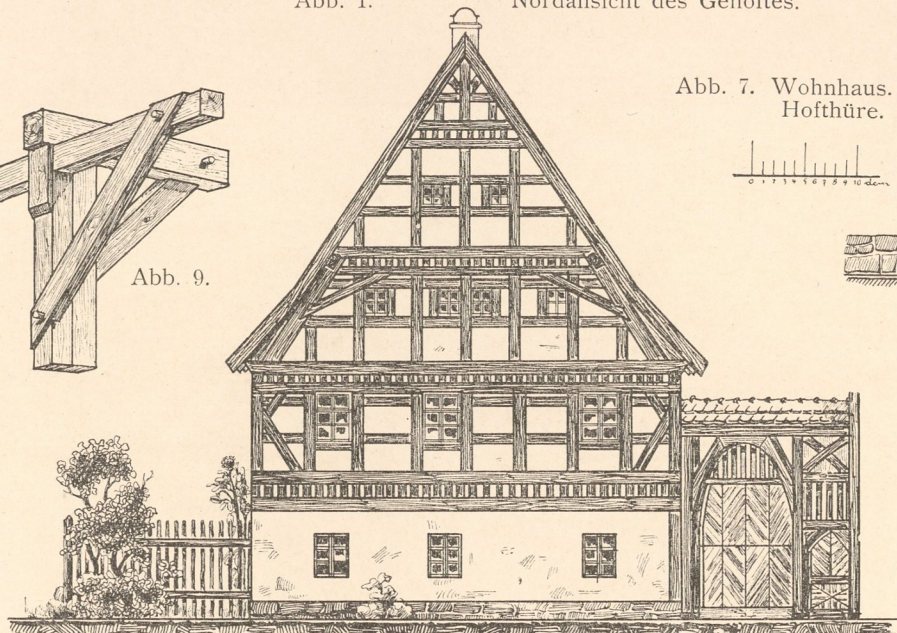
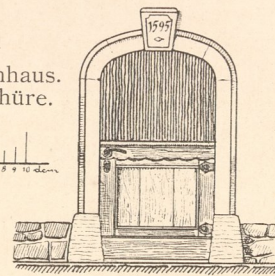

Abb. 8. Hofgalerie.

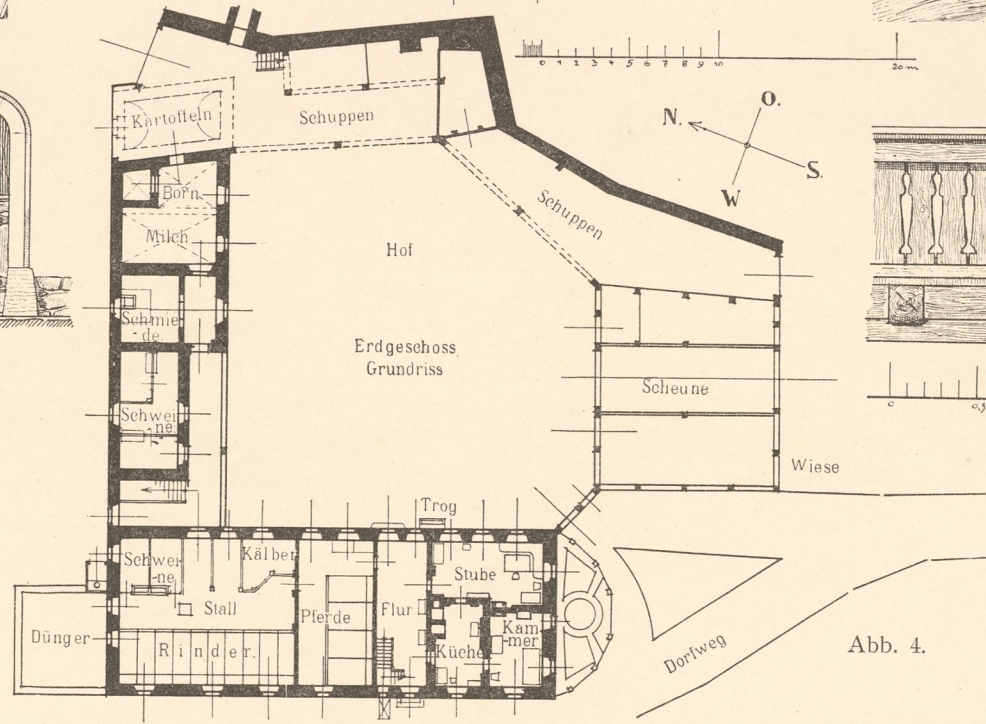

Abb. 6. Wohnhaus. Querschnitt.

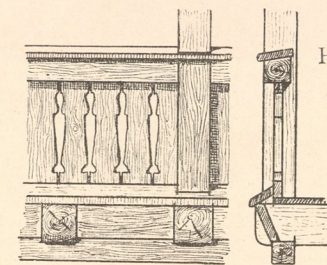

Abb. 10. Nordwestliche Hofecke.

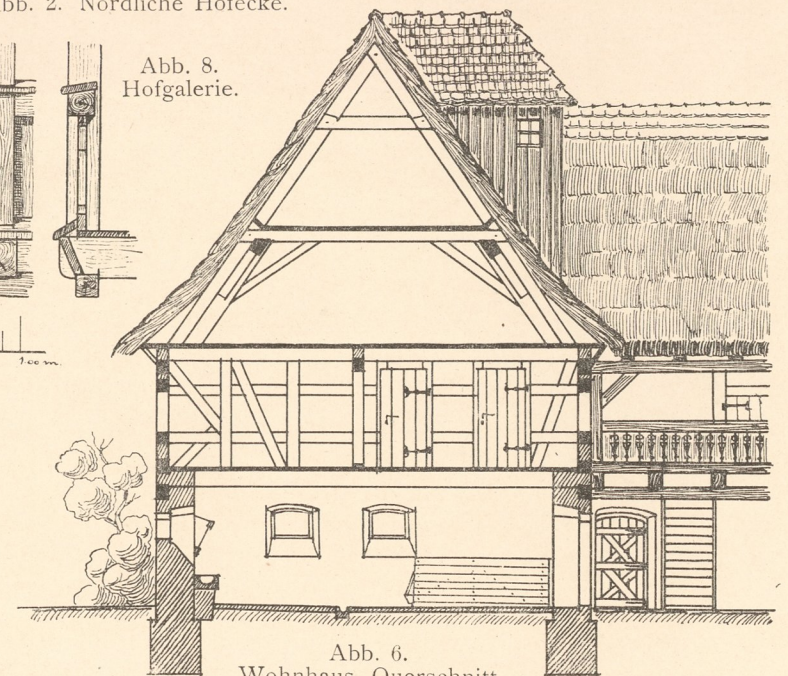

Abb. 11. Wohnhaus. Ostfront.

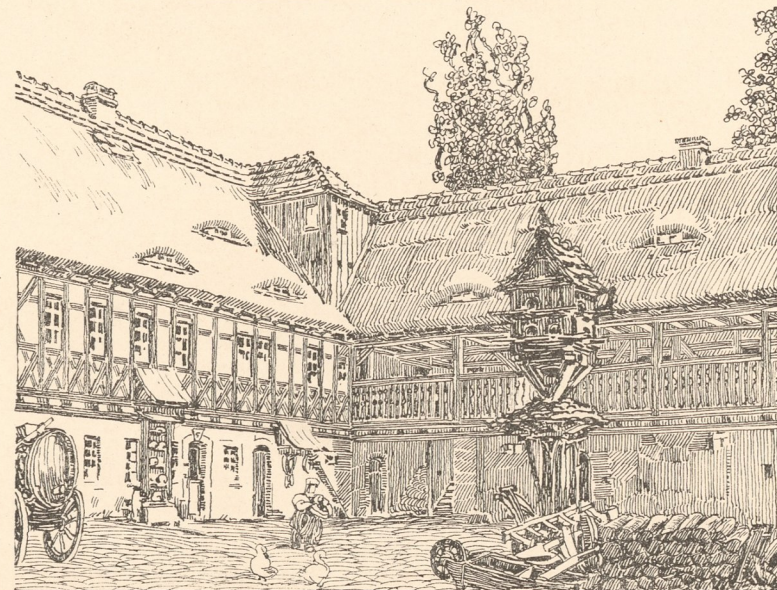
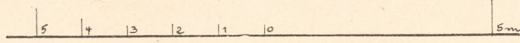

Abb. 12. Einfahrtsthor mit Pfortchen.

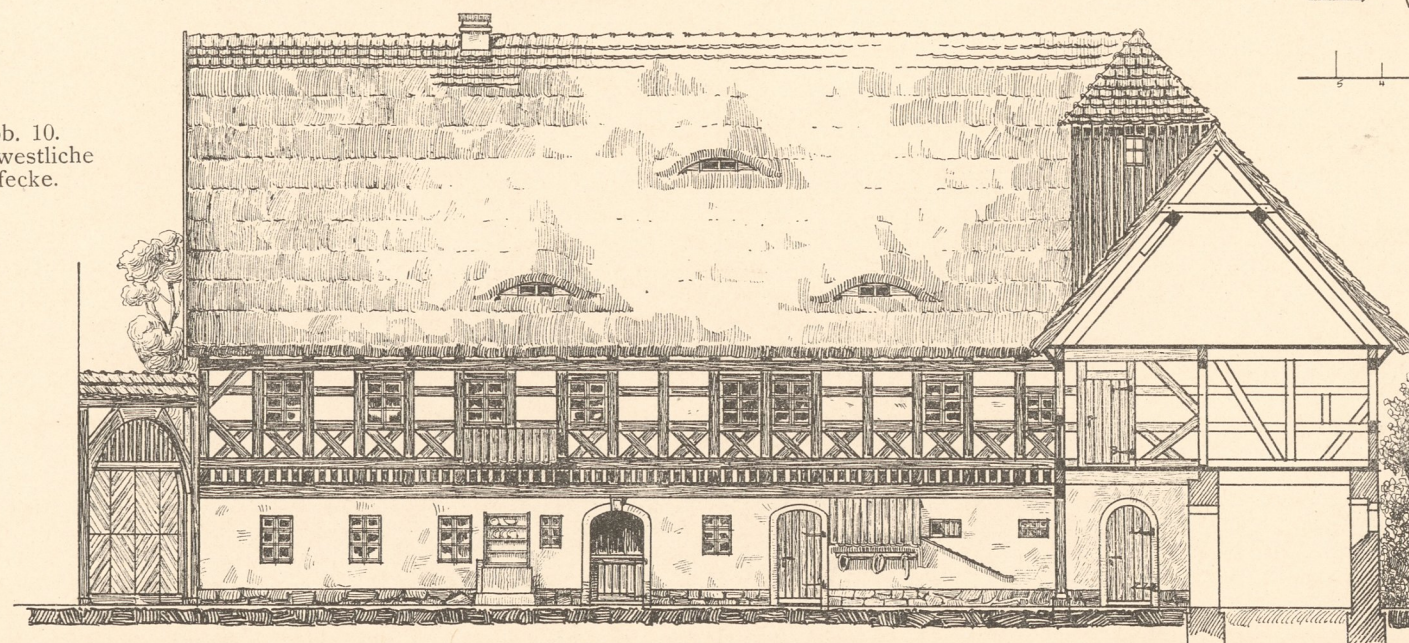
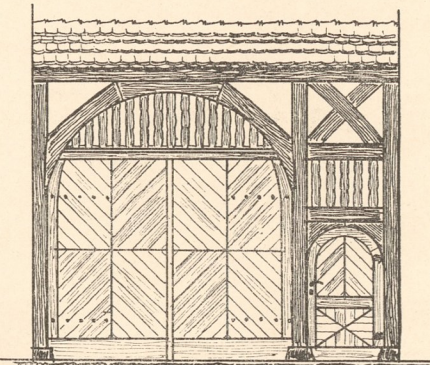
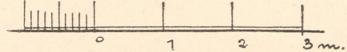
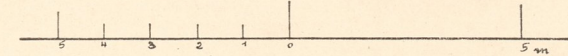

Inventar  
Abth E  
Nr. 1204