

Abb. 3. Wohnhaus zum Gehöft eines Grossbauern in Ebersbach bei Braunsberg.



Abb. 1. Ermländisches Wohnhaus für einen Grossbauern. Strassenseite.



Abb. 8. Giebelansicht.

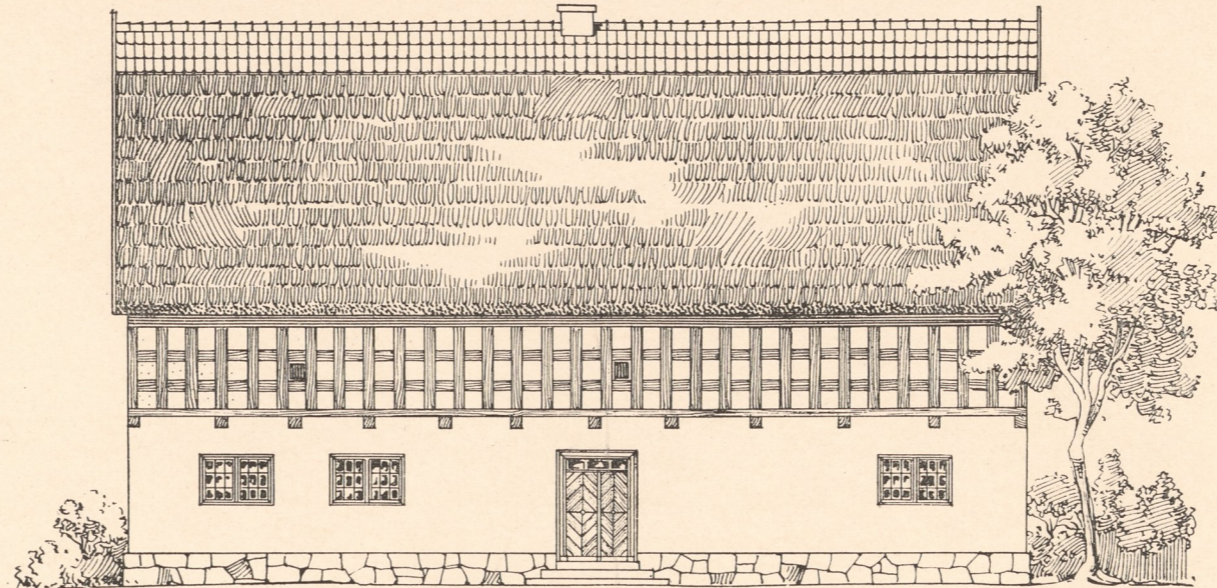
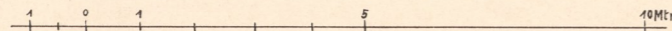

Abb. 2. Grundriss zu Abb. 1.

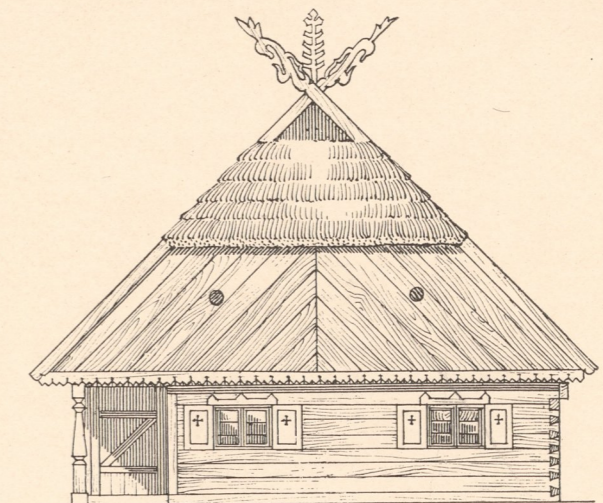
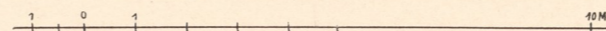

Abb. 4. Gehöft eines Grossbauern in Ebersbach bei Braunsberg. Längenschnitt durch das Gehöft.

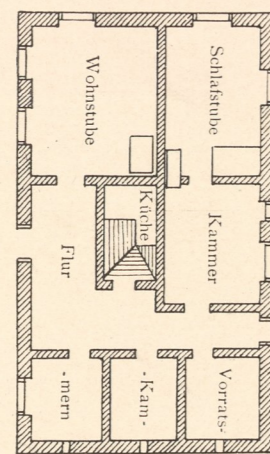
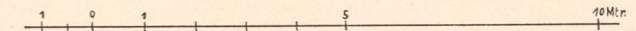

Abb. 9. Querschnitt.

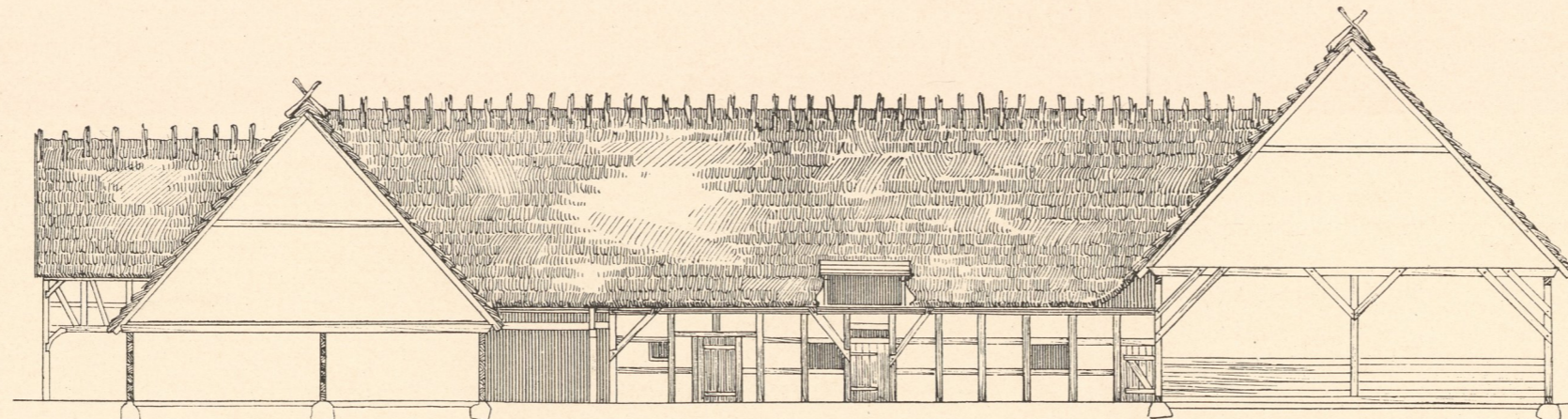
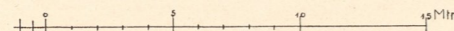

Abb. 5. Grundriss.

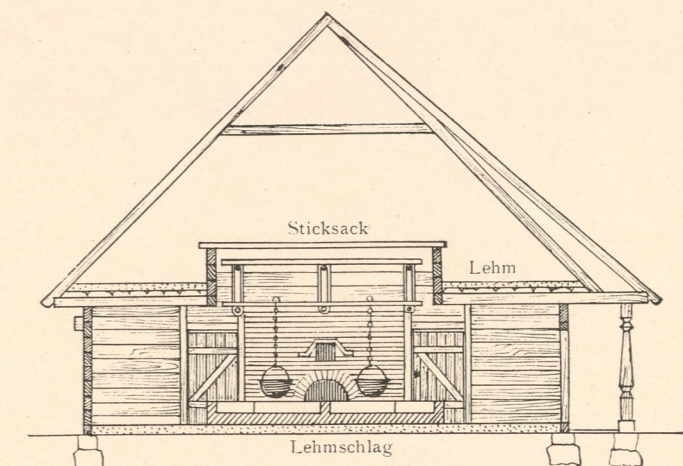
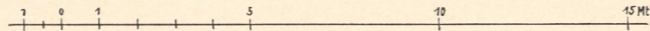

Abb. 6. Längsansicht. Strassenseite.

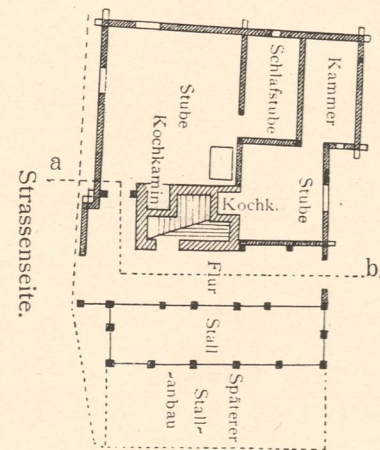
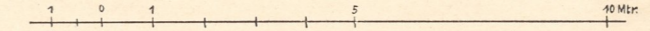

Abb. 7. Querschnitt a b.

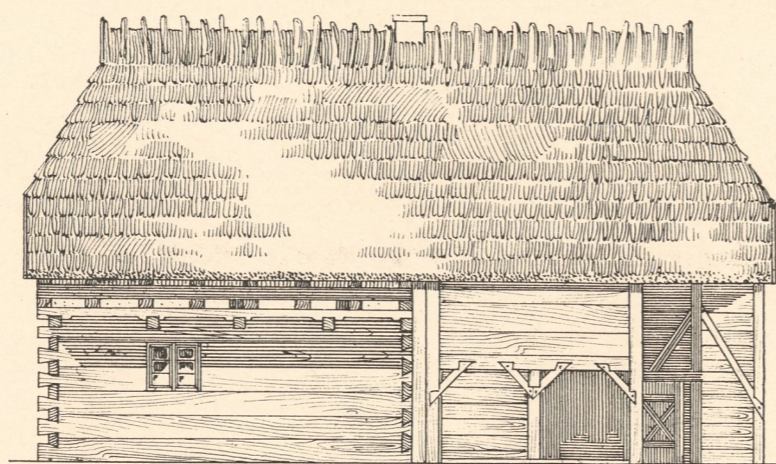
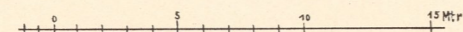

Abb. 10. Längsansicht.

Abb. 8—10. Litthaisches Bauernhaus.

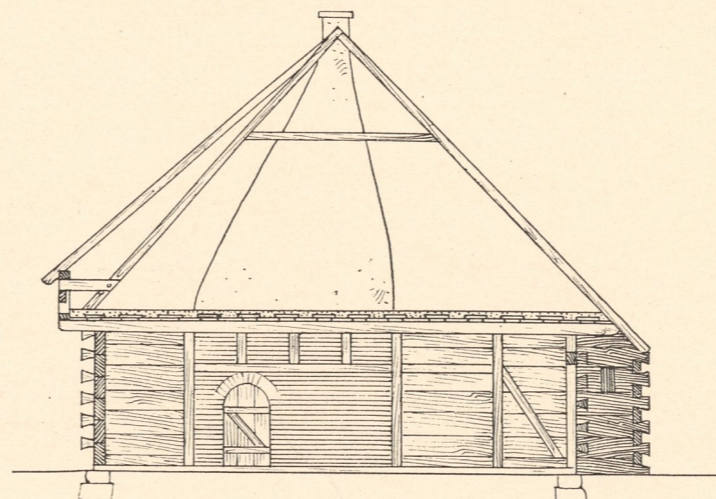
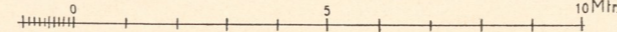
Abb. 5—7. Wohnhaus eines ermländischen Kleinbesitzers.

Antar
Abn E
Nr. 1204

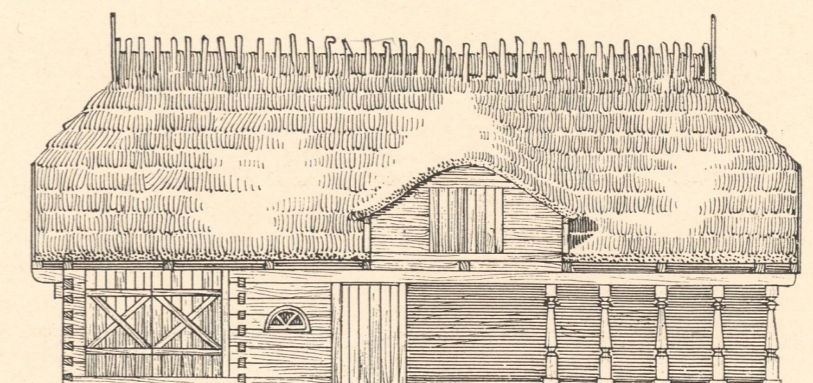