

Abb. 1. Seitenansicht.



Abb. 3. Giebelansicht.



Abb. 2. Längenschnitt a-b.

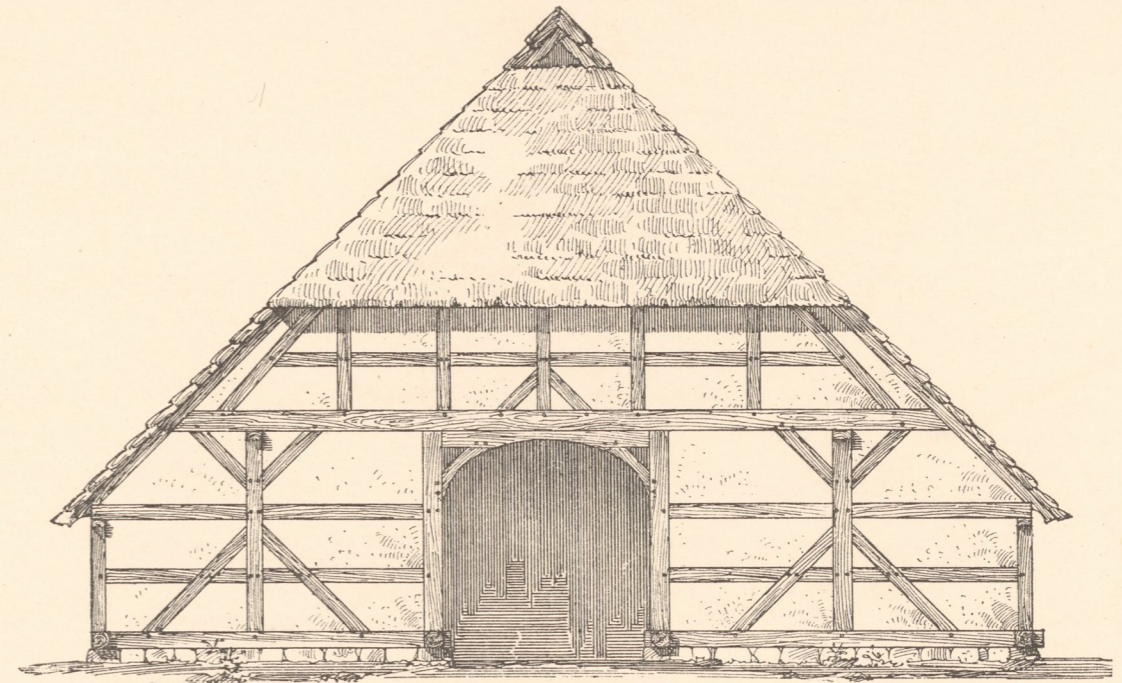

Abb. 7.
Verbindung von
Kopfband u. Ständer.

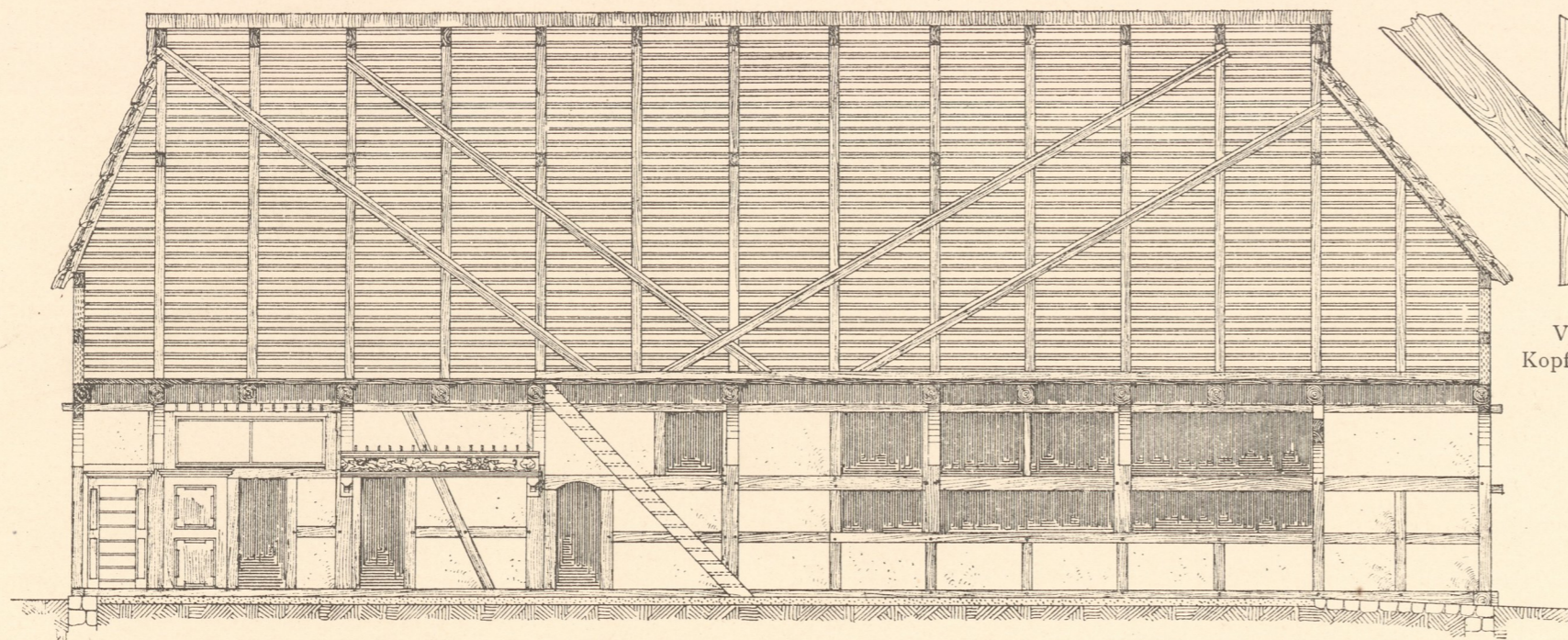

Abb. 4. Querschnitt c-d.

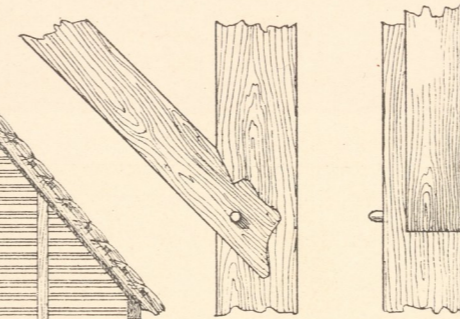

Abb. 6. Geschnitzte Holztafel auf der Diele.

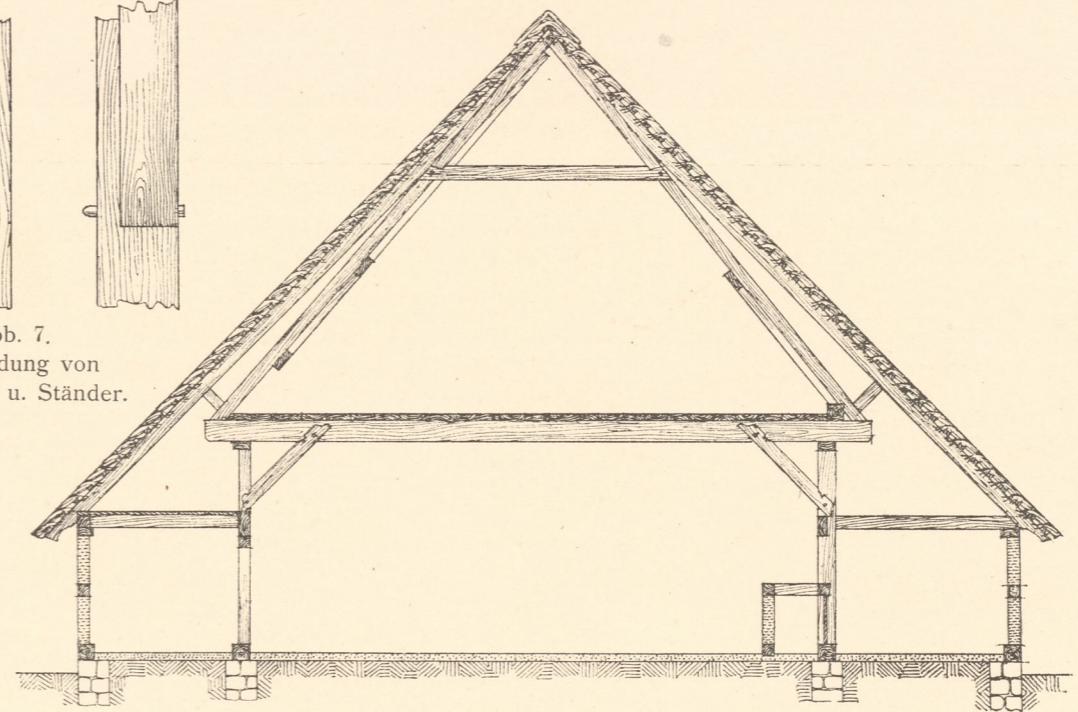

Abb. 8. Verbindung von Wandstiel
Rähm, Balken u. Sparren.

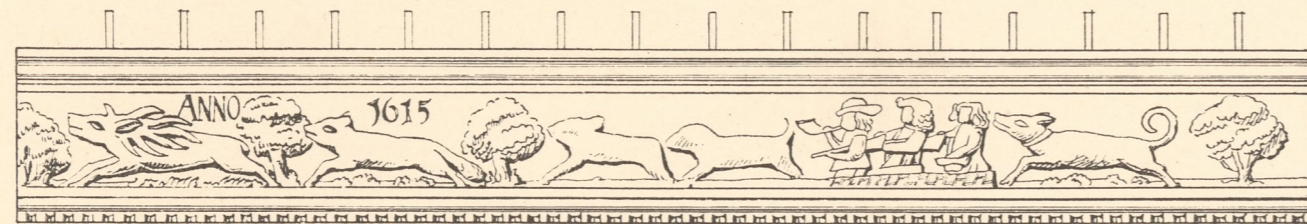

Masstab zu Abb. 1-4
" " Abb. 5
" " Abb. 6

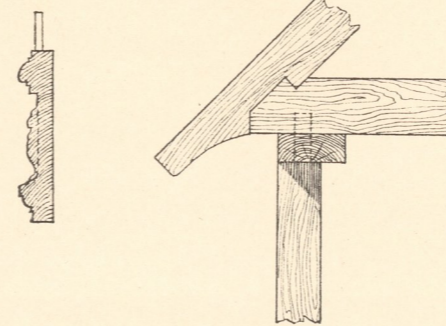
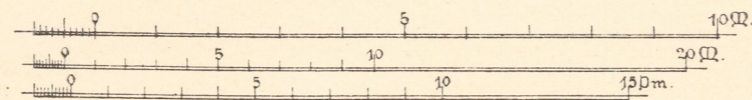
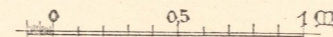

Masstab zu Abb. 7 u. 8.



Abb. 5. Grundriss.

Inventar
Abth E
Nr. 1204

Aufgen. von Krempien.

Zinkhochätzung von Albert Frisch, Berlin W.

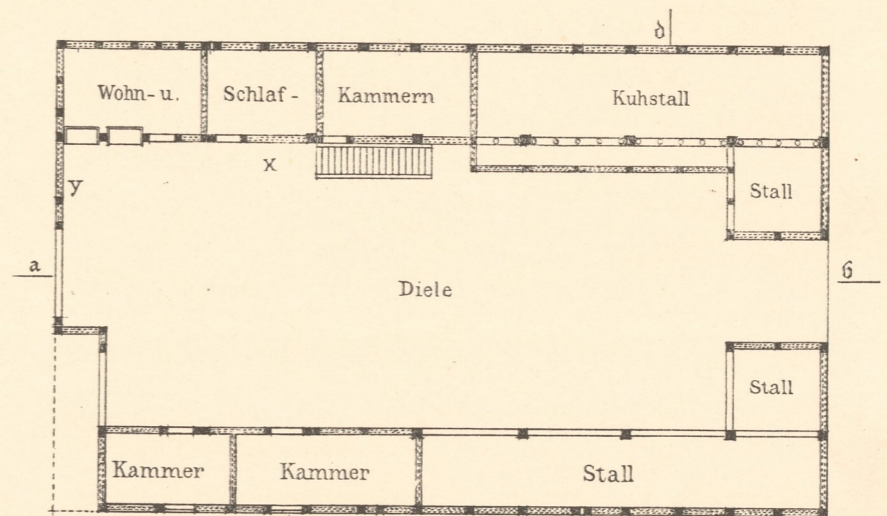
Verlag von Gerhard Kühtmann, Dresden.

