

Abb. 4 und 5.  
Haus Maurer in Brandobberndorf.  
Fensterbrüstungen  
an der Strassenseite.

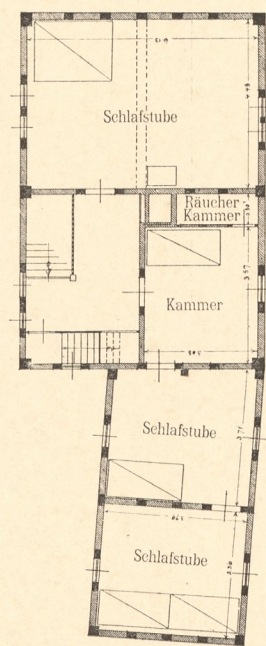

Haus Maurer in Brandobberndorf.  
Wohn- und Thorhaus.  
Grundriss vom I. Stock.

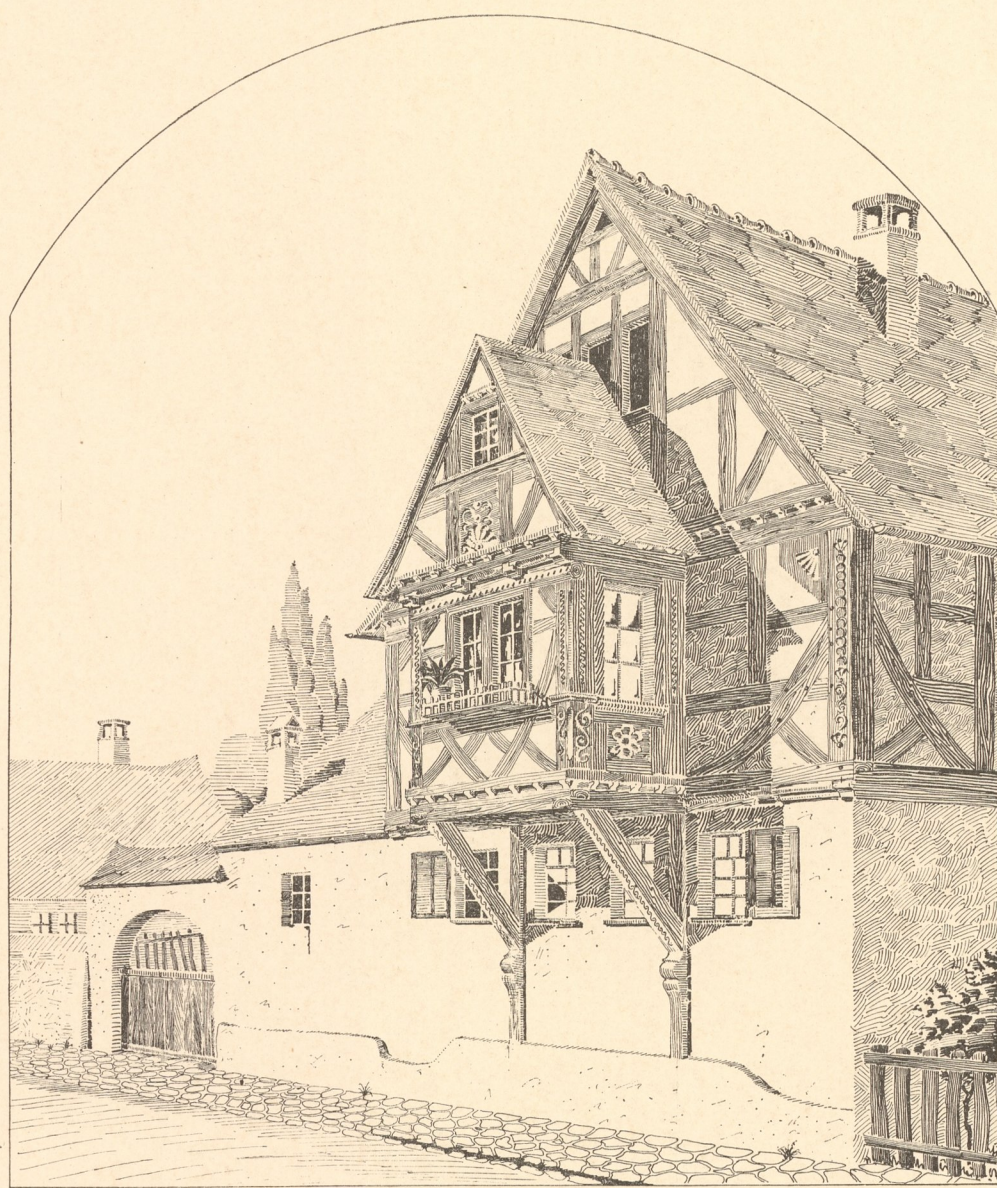
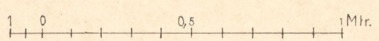
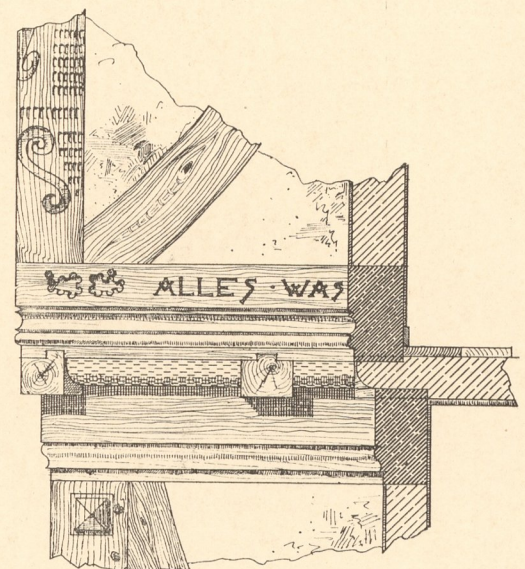

Abb. 8. Haus Maurer in Brandobberndorf.  
Gebälk an der Strassenseite. Aelterer Theil.

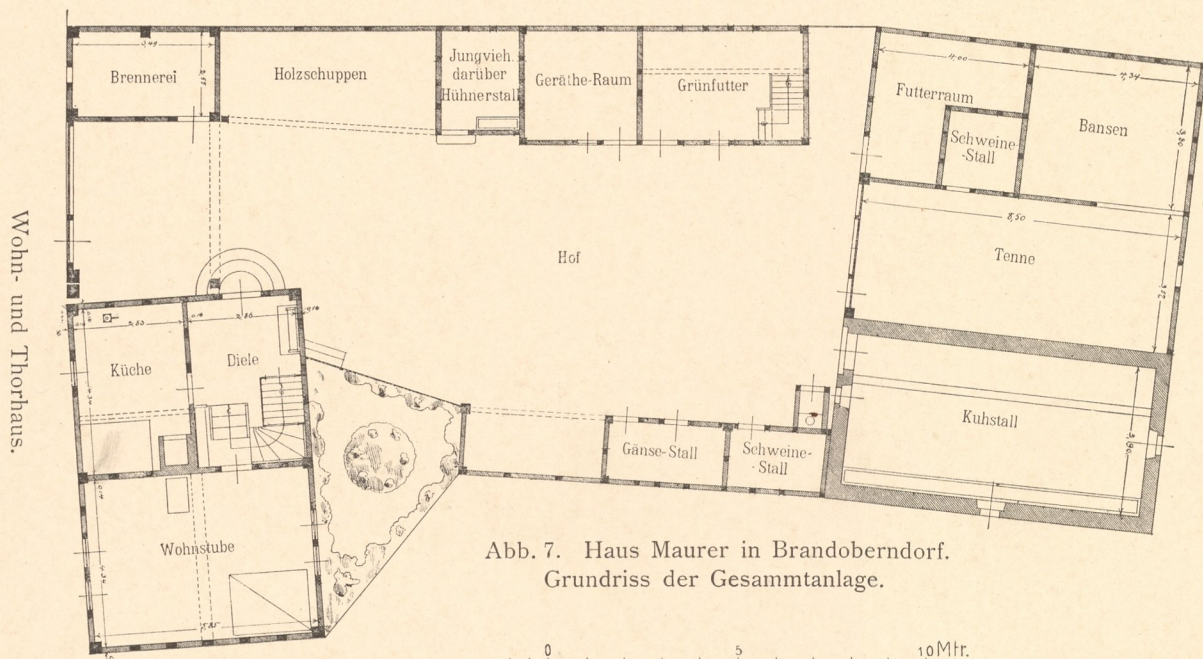
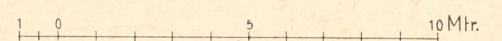