

Abb. 1. Ansicht von der Strasse.



Abb. 2. Giebelansicht.



Abb. 6.
Lageplan. 1:1000.

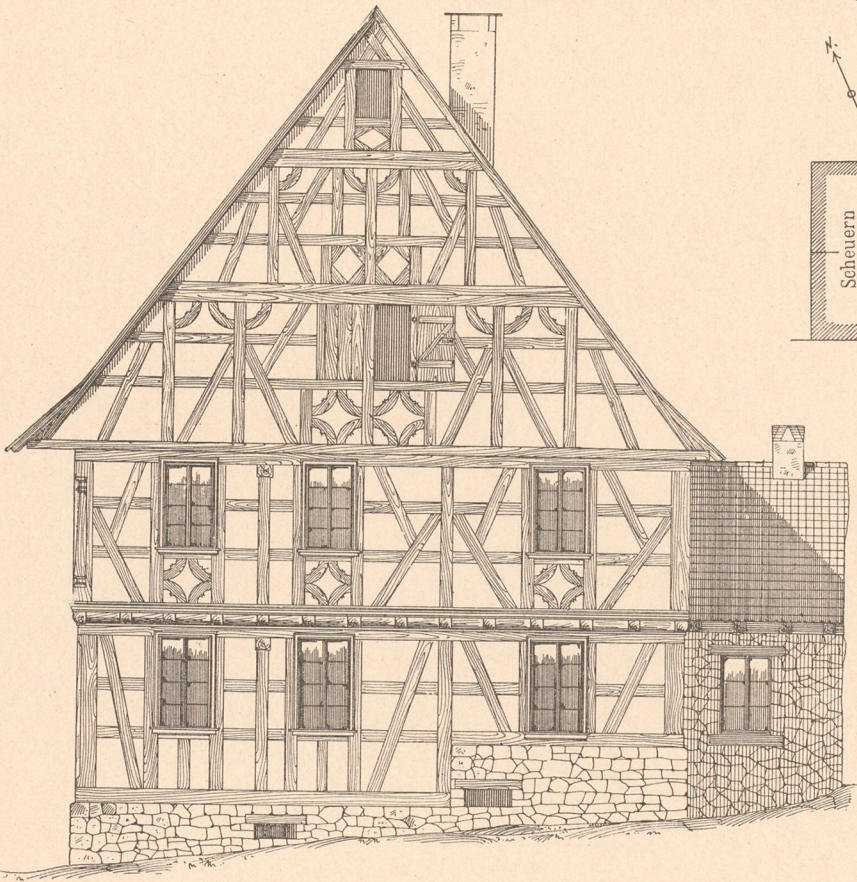

Abb. 10.
Backofen. 1:300.

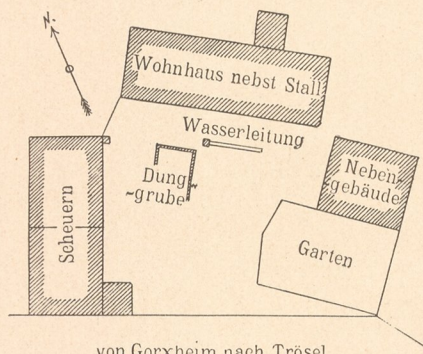

Abb. 3. Querschnitt.

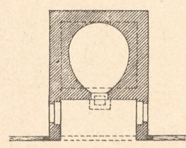

Abb. 9.
1:30.

Balkenschloss
zwischen Unter-
und Oberstock.

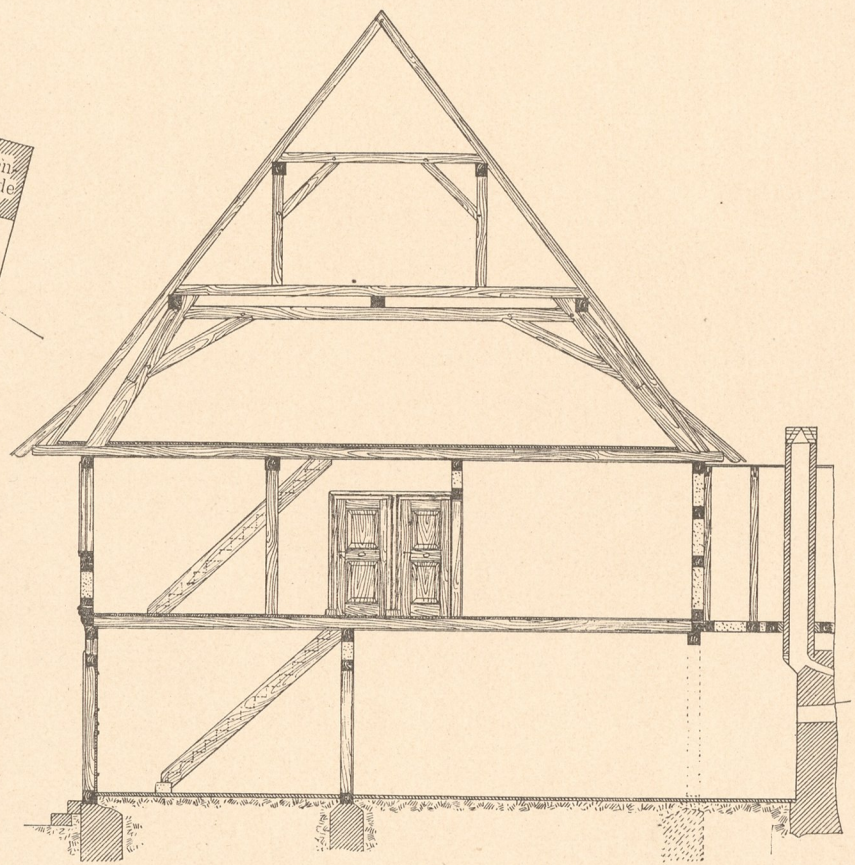
Abb. 11. Sturz über der Kellerthür.

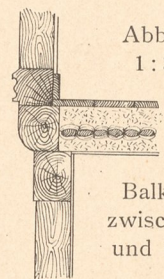

Abb. 7. Hausthür.

0 5Mtr.
Massstab zu Abb. 1-3.



Abb. 4. Grundriss vom oberen Stock.

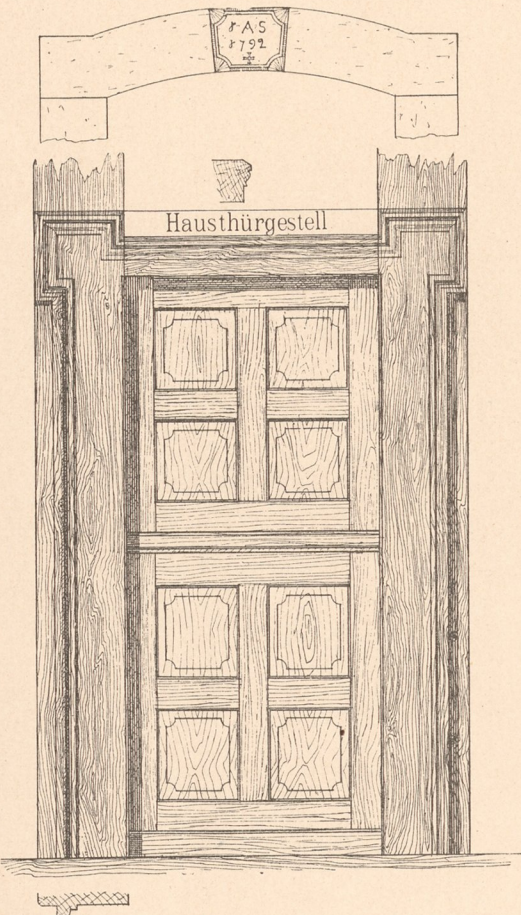

Abb. 5. Grundriss vom unteren Stock.

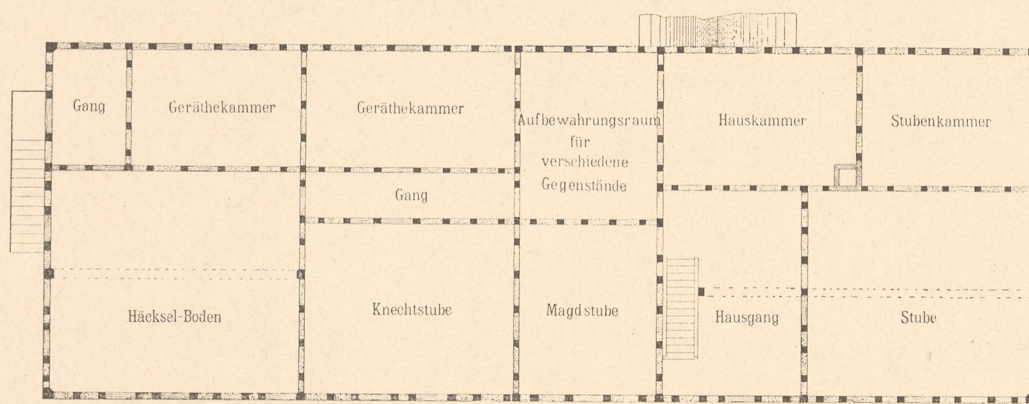

Abb. 8. Eckpfosten.

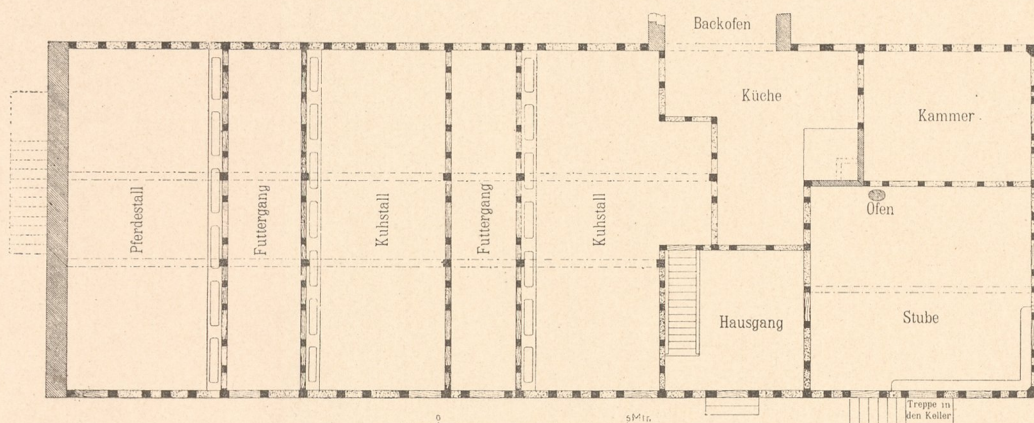
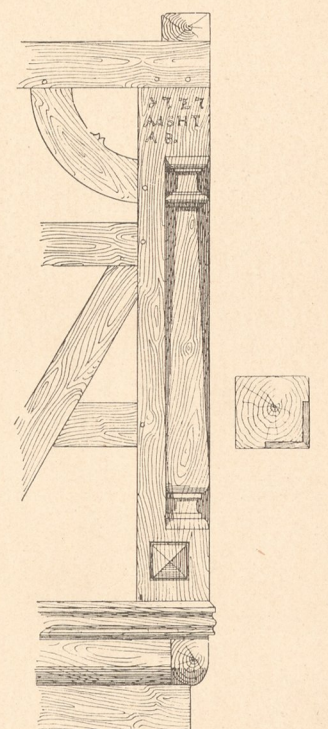