

Abb. 1. Isernhagen. Stall.



Abb. 2. Isernhagen. Stubenthür.



Abb. 3. Langlingen. Längenschnitt.

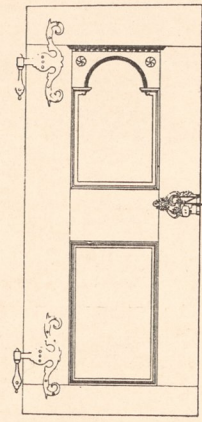

Abb. 4. Isernhagen. Scheune Giebelansicht.

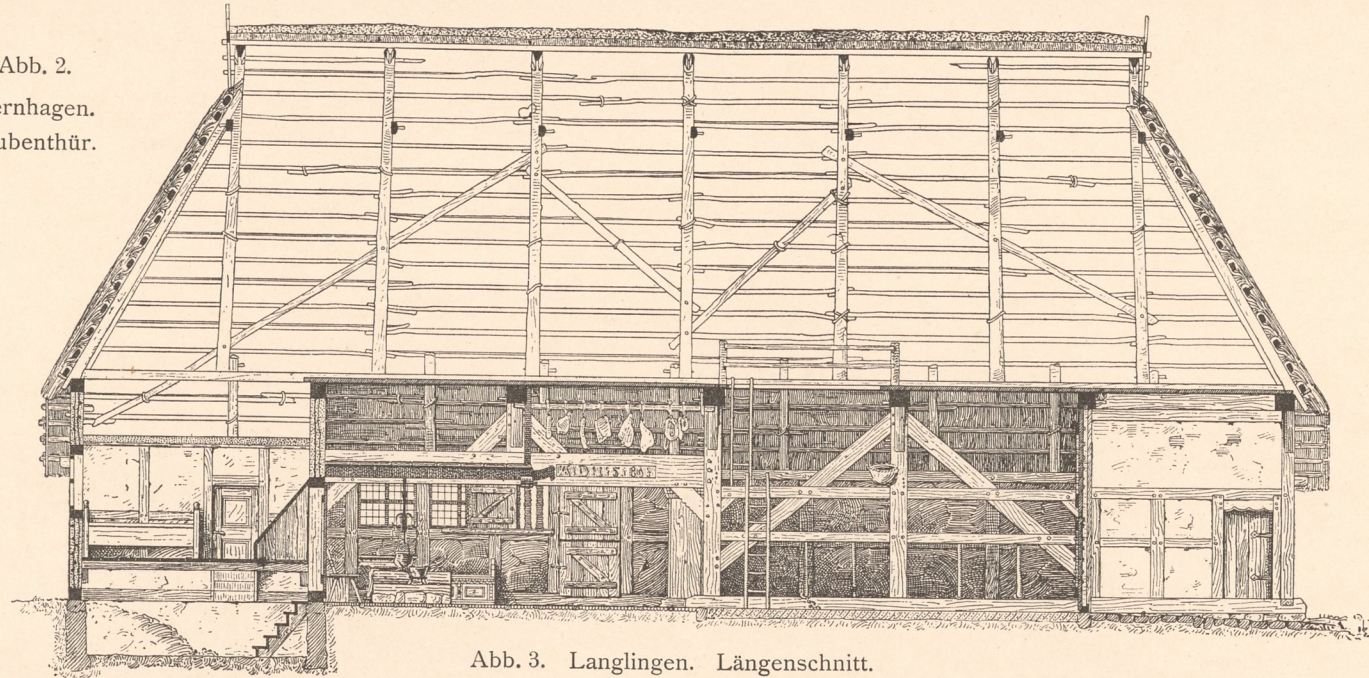

Abb. 6. Loccum. Haus von 1558. Längenschnitt.

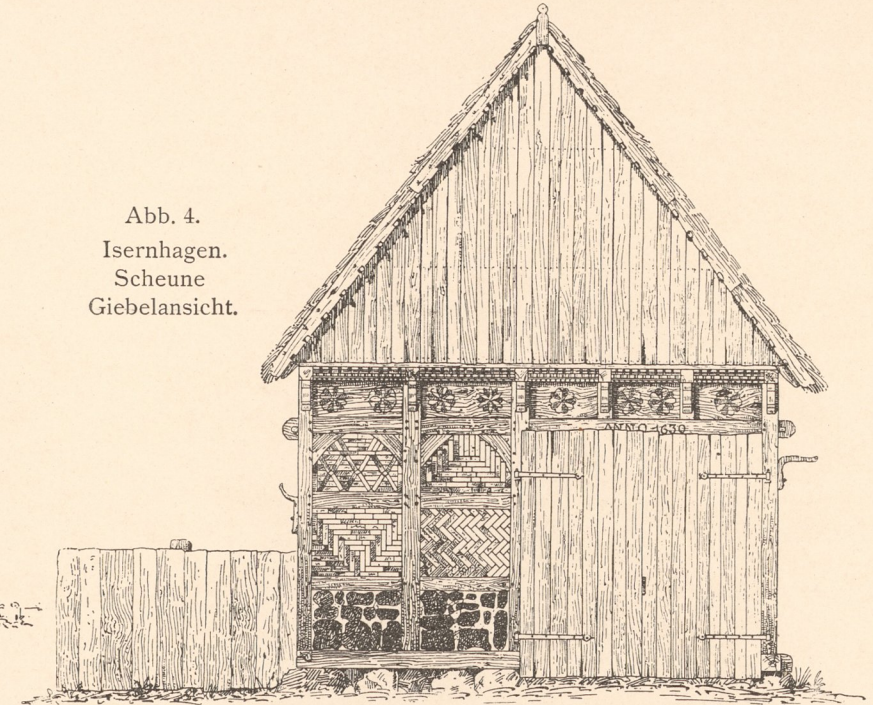

Abb. 5. Isernhagen. Lageplan.

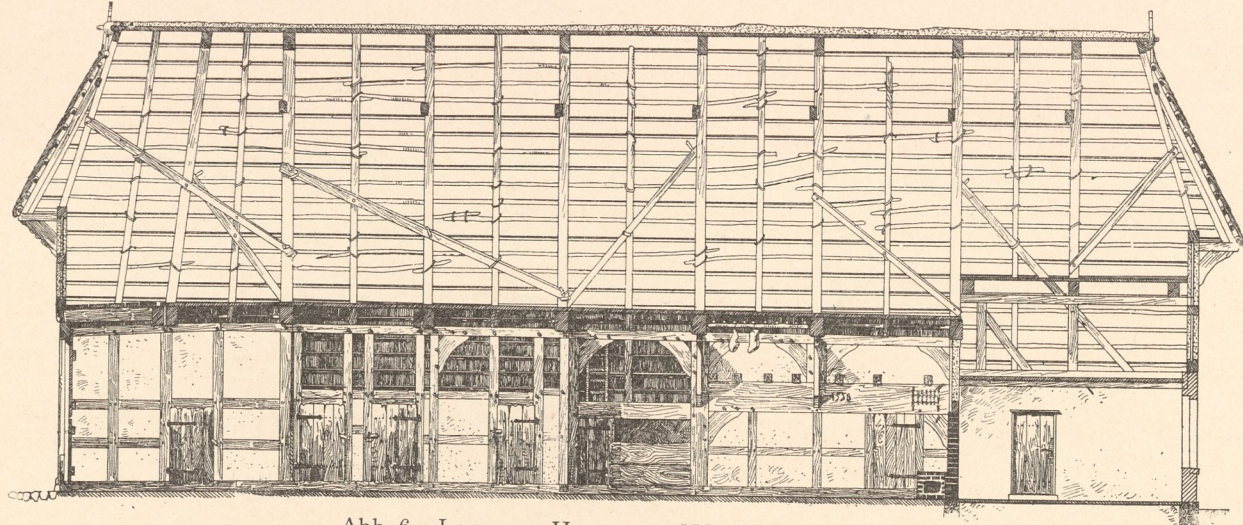

Abb. 7. Loccum. Haus von 1558. Längsansicht.

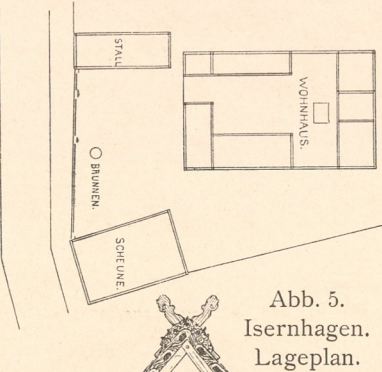

Abb. 11. Brackel. Grundriss.

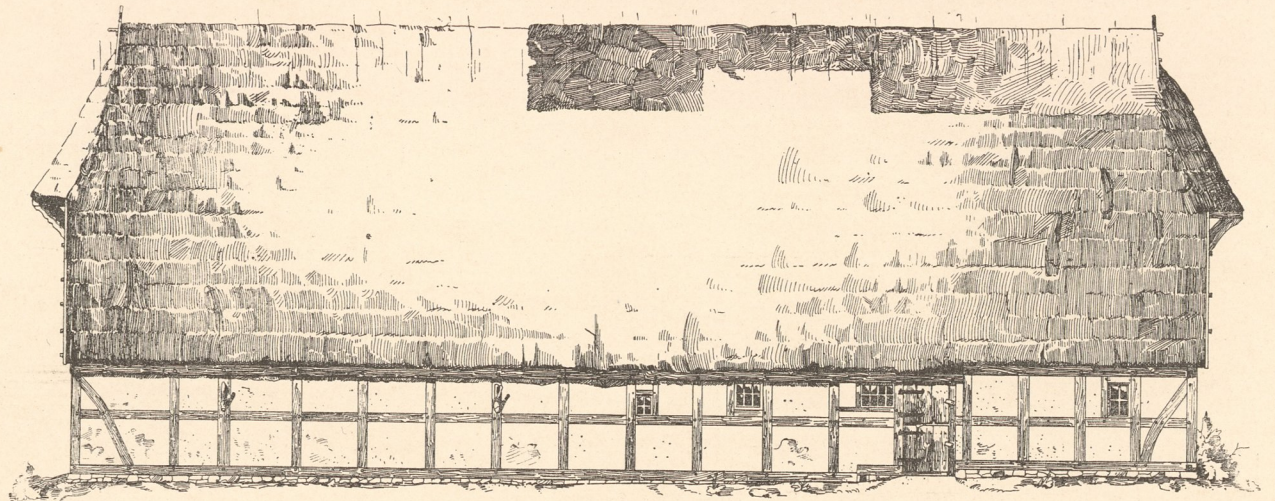

Abb. 9. Isernhagen. Butzenwand.

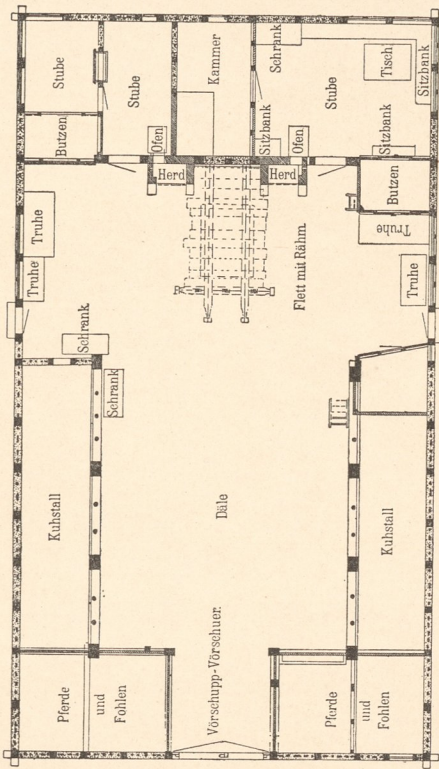

Abb. 8. Langlingen. Querschnitt.

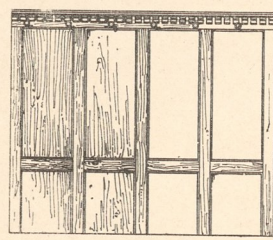

Abb. 10. Isernhagen. Kellereingang.

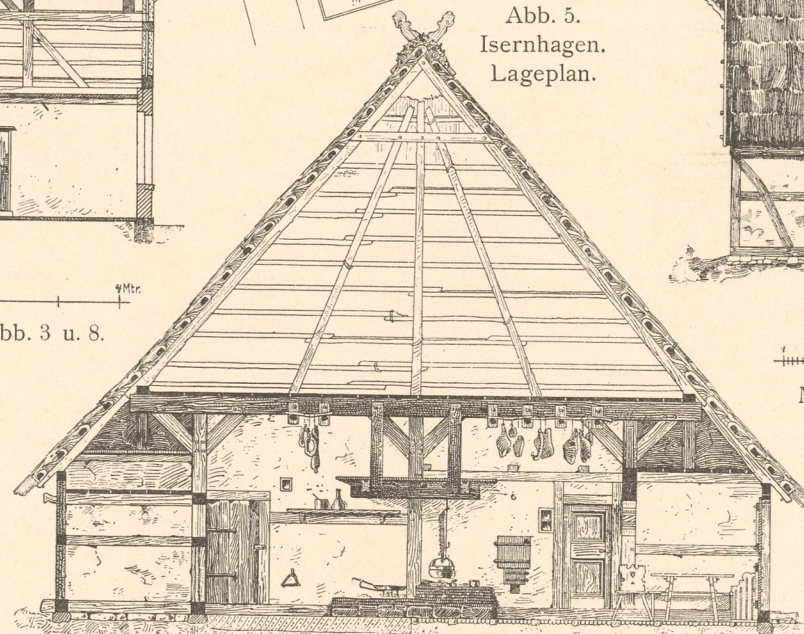

Abb. 12. Loccum. Haus von 1558. Querschnitt.

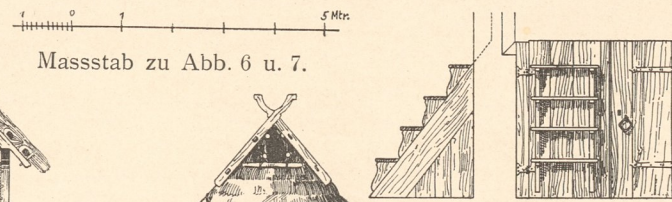

Abb. 13. Loccum. Thür von einer Scheune. 1699. (ohne Eisen).

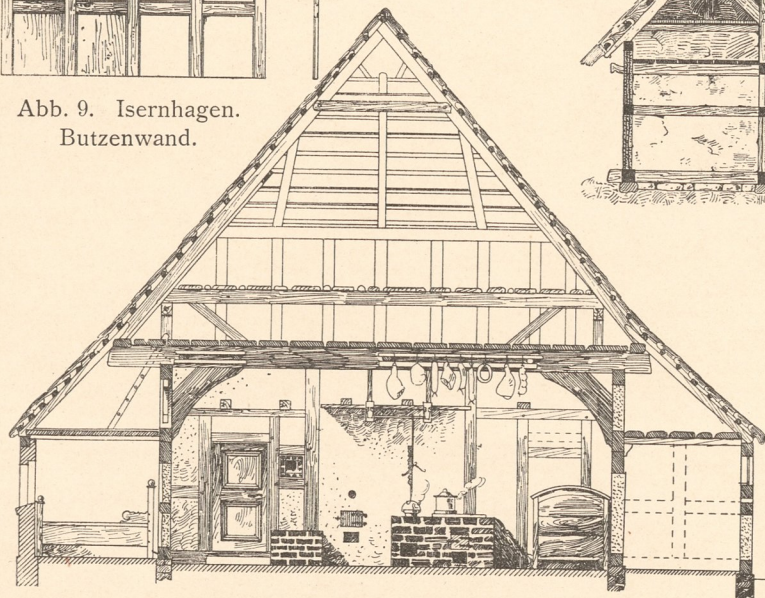

Abb. 14. Loccum. Haus von 1558. Giebelseite.

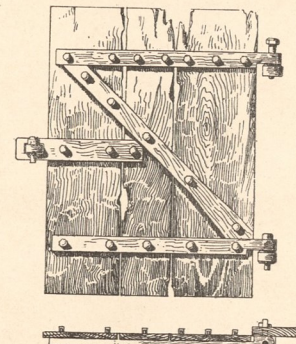

Abb. 15. Langlingen. Grundriss.

Massstab zu Abb. 3 u. 8.

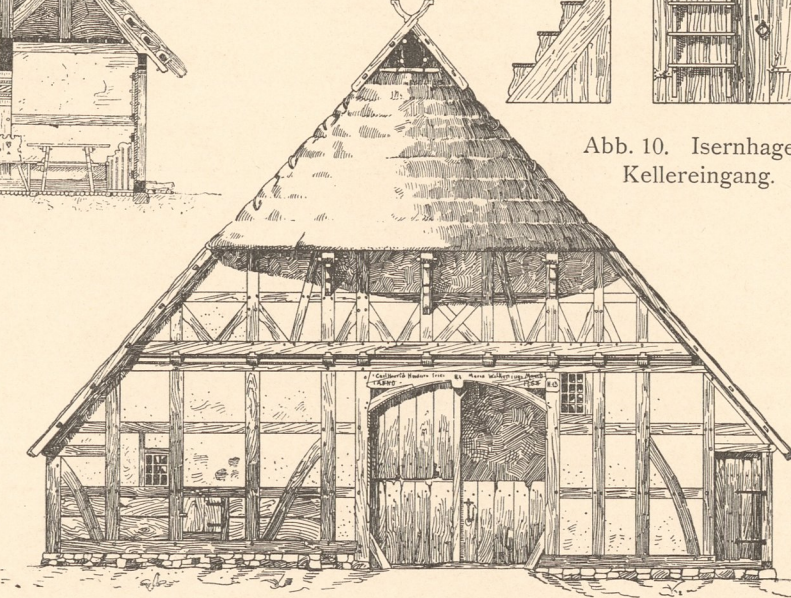
Massstab zu Abb. 6 u. 7.

Aufgen. u. gez. von Schlöbcke, Meyer, Hakenholz u. Wissmann.

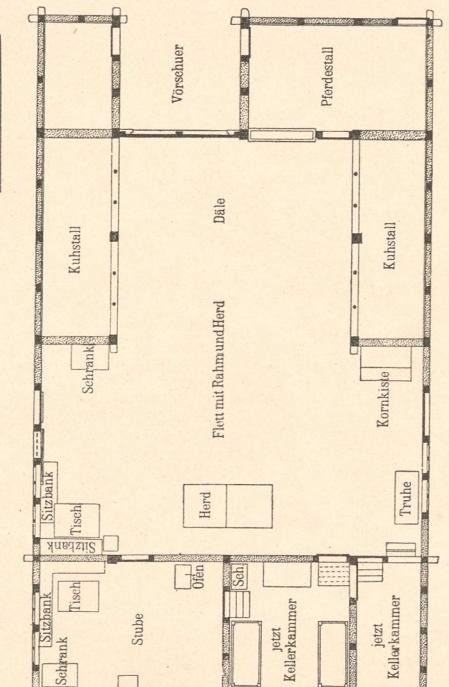
Zinkhochätzung von Albert Frisch, Berlin W.

Verlag von Gerhard Kühtmann, Dresden.



US TUG

Inventory
Abt. E
Nr. 1204