

1. HAUS HEIN HEITMANN IN NEUENGAMME 216 (VIERLANDE).

2. HAUS MAGNUS STÖCKELE IN LAMSTEDT, KR. NEUHAUS A. OSTE (HADELN).



Abb. 1. Neuengamme 216, Schnitt CD.



Abb. 5. Neuengamme 216, Lageplan.

Masstab zu Abb. 1.

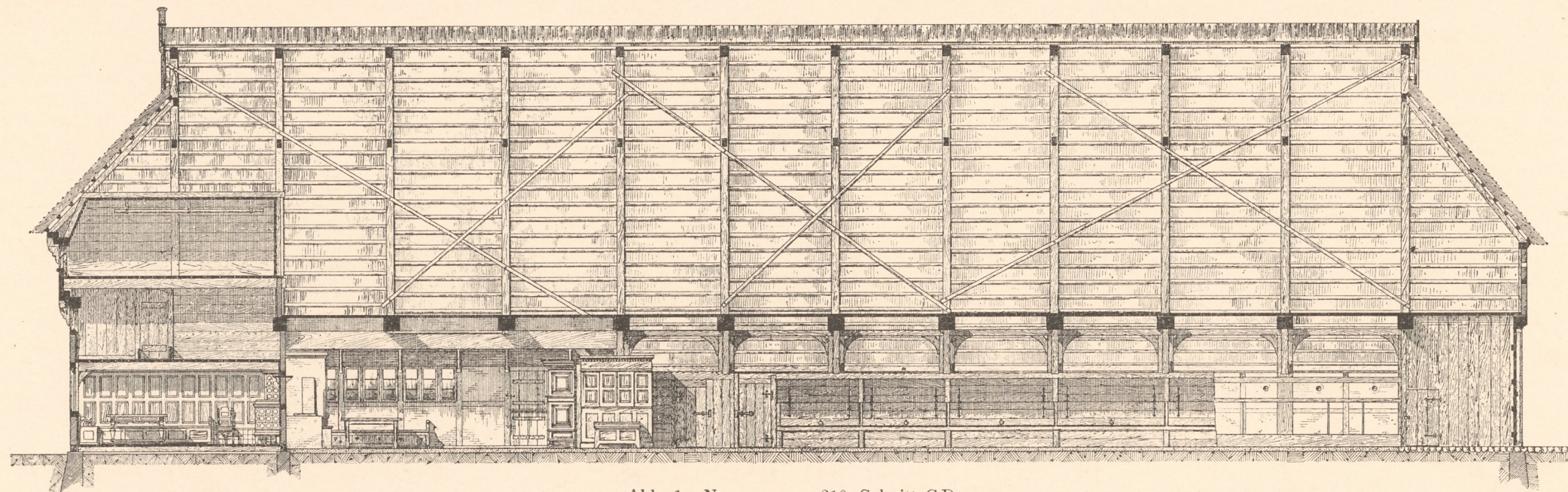
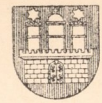
Masstab zu Abb. 2, 3, 6 u. 7.

Masstab zu Abb. 4 u. 8.

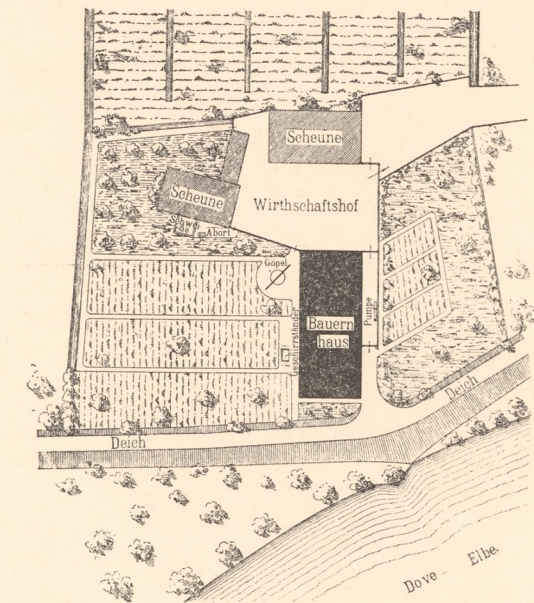
Masstab zu Abb. 5 u. 10.



Abb. 2. Neuengamme 216, Vorderansicht.



Abb. 9. Lamstedt, Einzelheit des Thorweges.

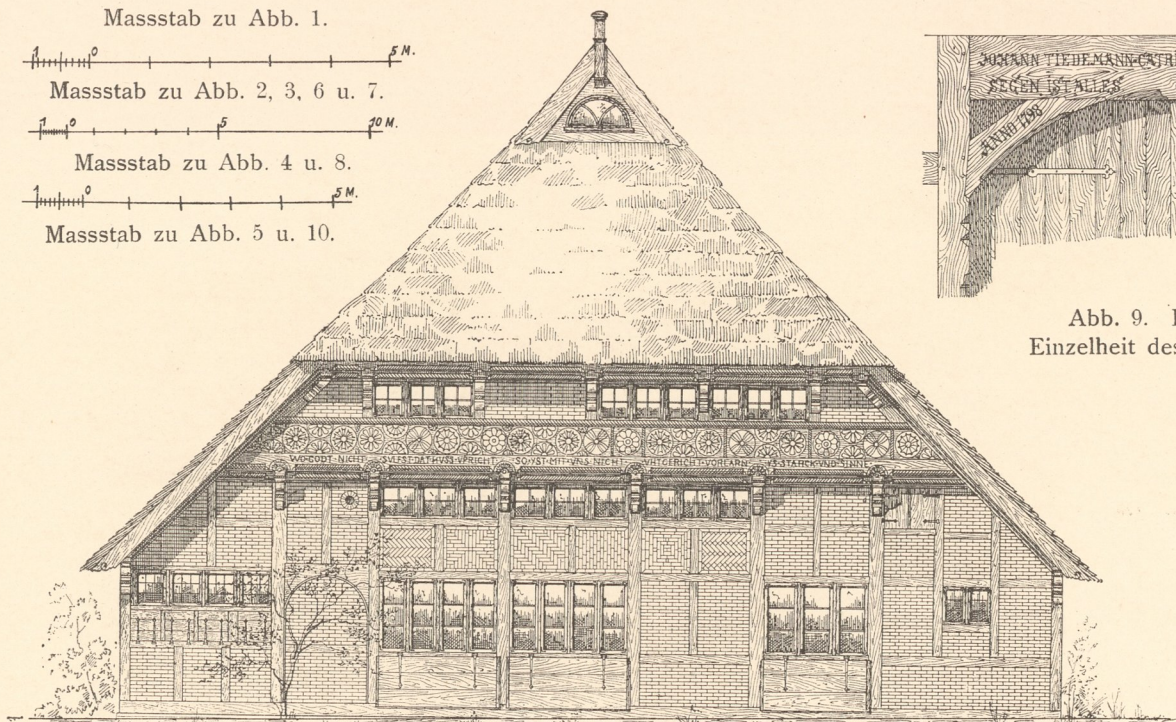

Abb. 3. Neuengamme 216, Schnitt A B.



Abb. 10. Lamstedt, Lageplan.

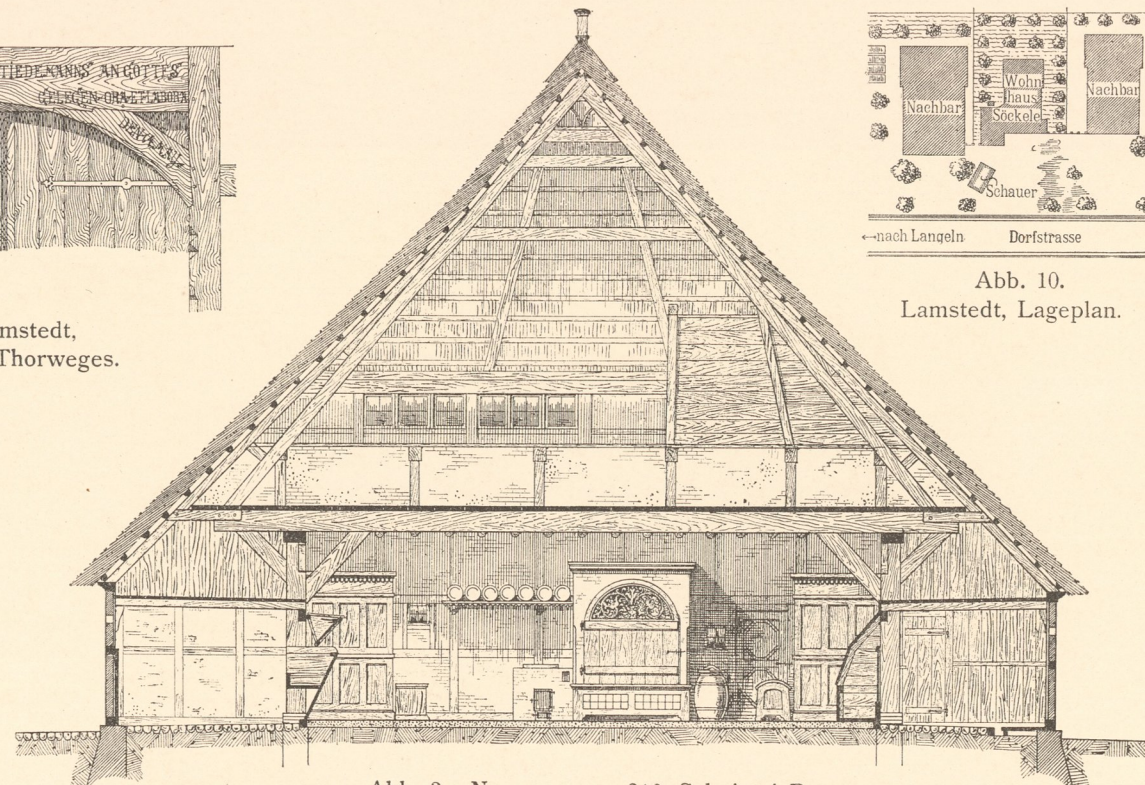

Abb. 6. Lamstedt, Vorderansicht.

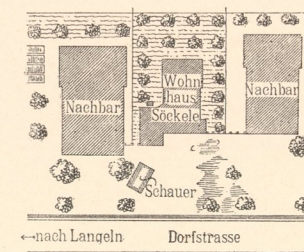

Abb. 7. Lamstedt, Schnitt A B.

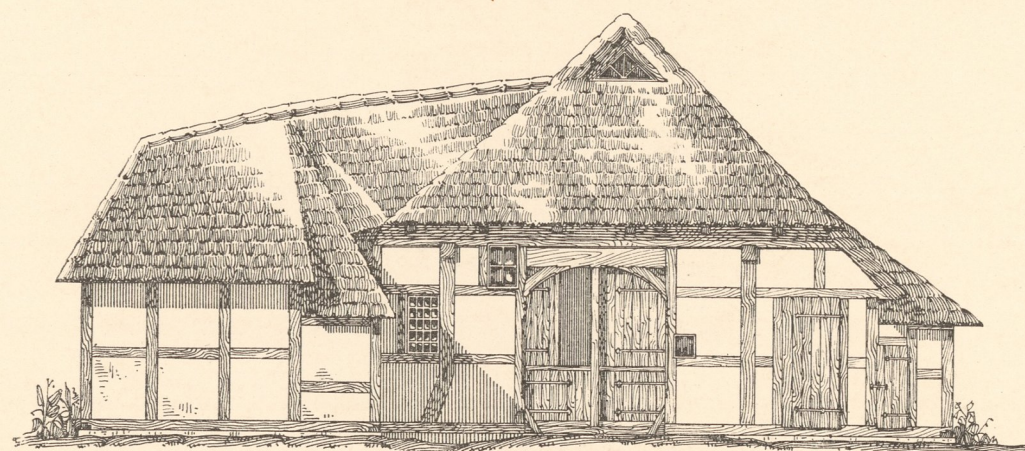

Abb. 8. Lamstedt, Grundriss.

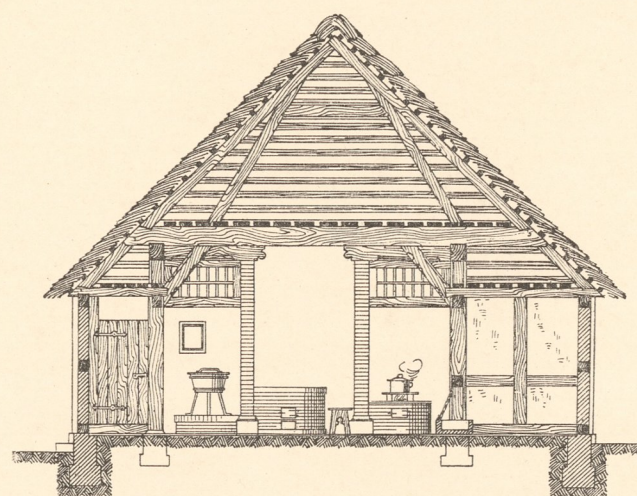

Abb. 4. Neuengamme 216, Grundriss.

Inventar
Abth E
Nr. 1204

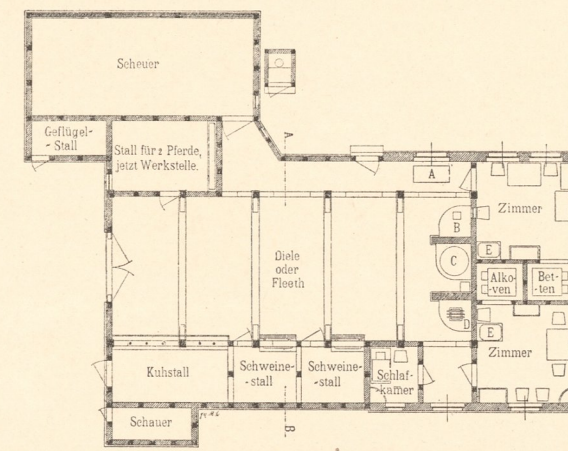
Aufg. von W. Cohn, I. Faulwasser und M. Löhner.
(Architekten- u. Ingenieur-Verein in Hamburg.)

Zinkhochätzung von Albert Frisch, Berlin W.

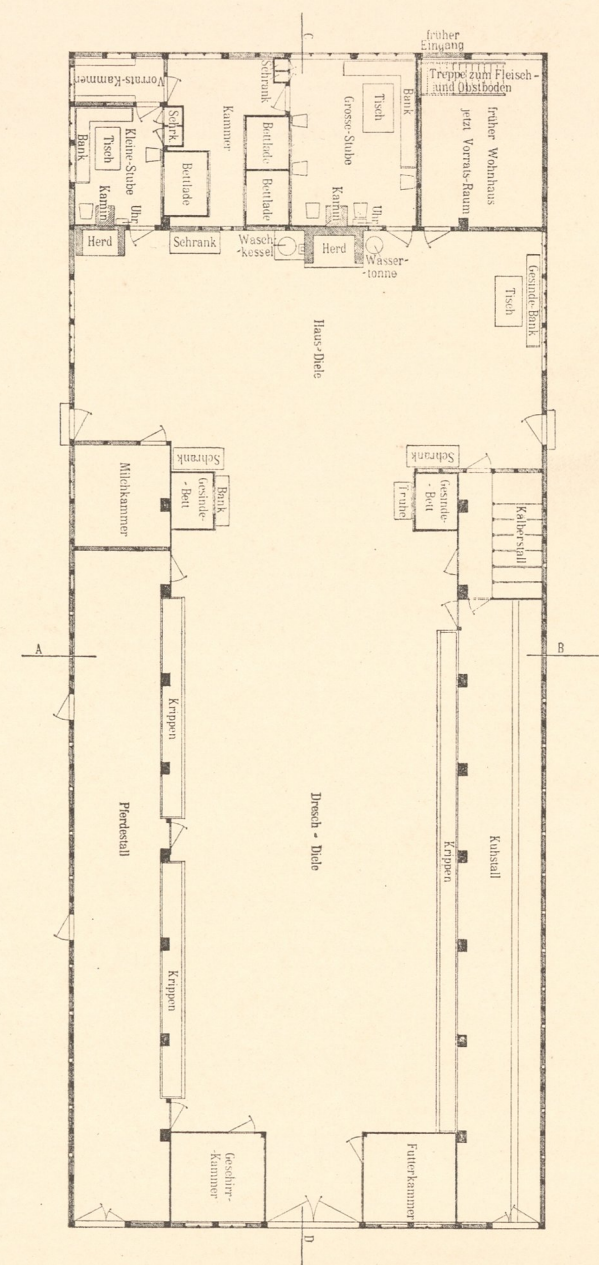
Verlag von Gerhard Kühtmann, Dresden.



UB
TUG