

Abb. 1.



Abb. 2.



Abb. 3.

Abb. 1—8. Bauernhaus in Dlugi.

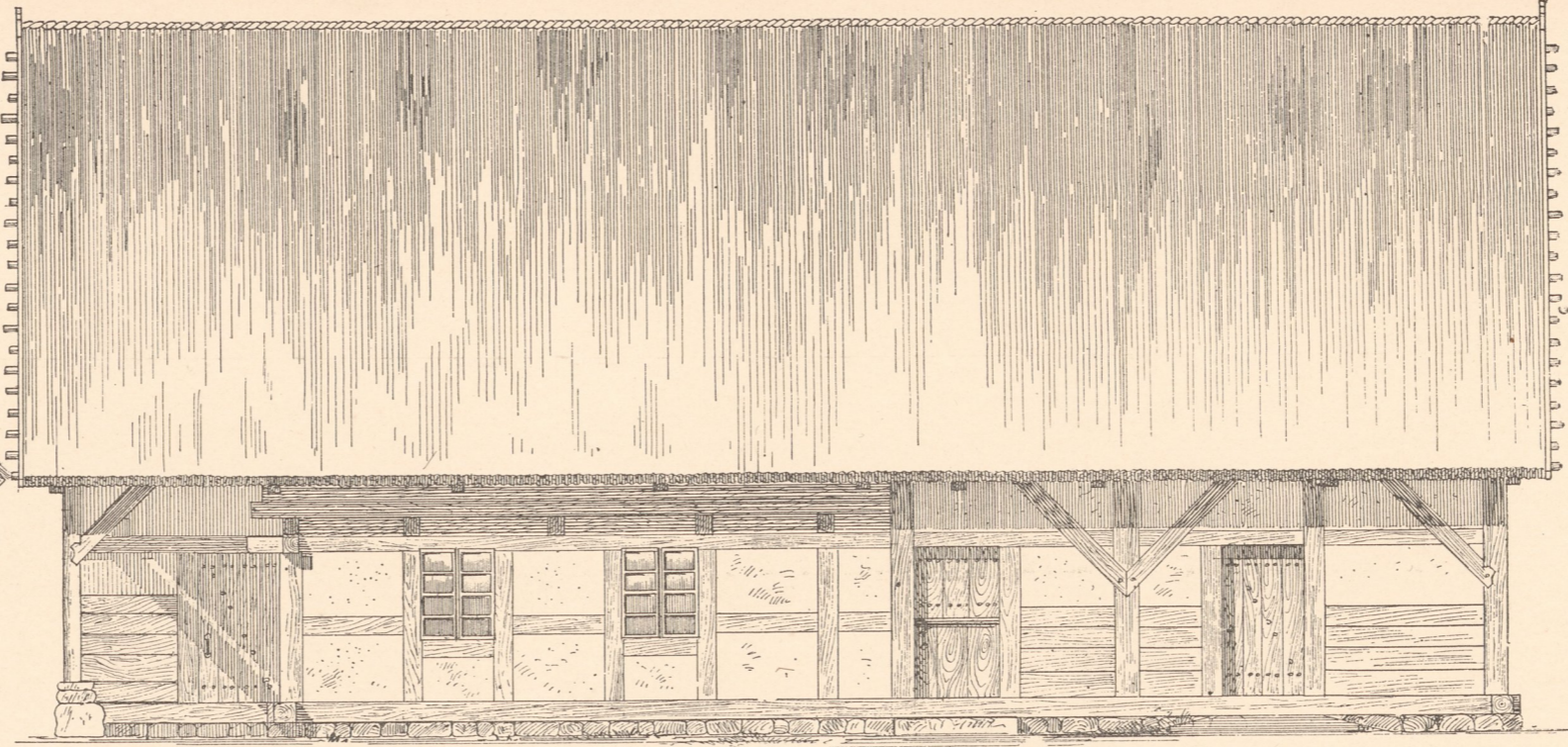

Abb. 4.

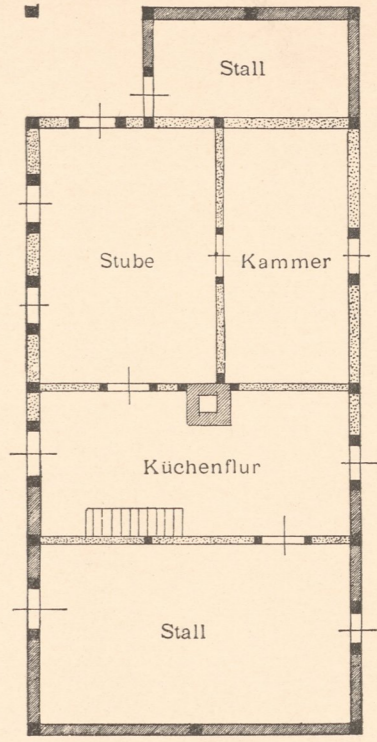

Abb. 5.

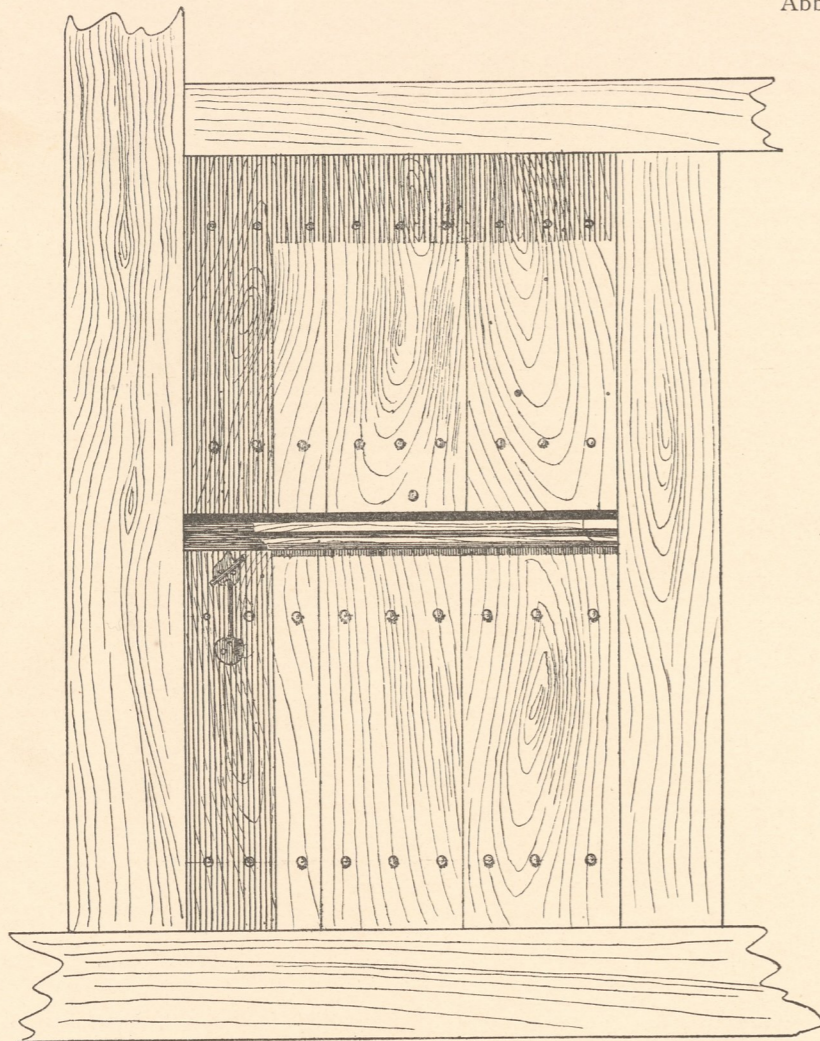

Abb. 7. Bauernhausgiebel aus Dlugi.

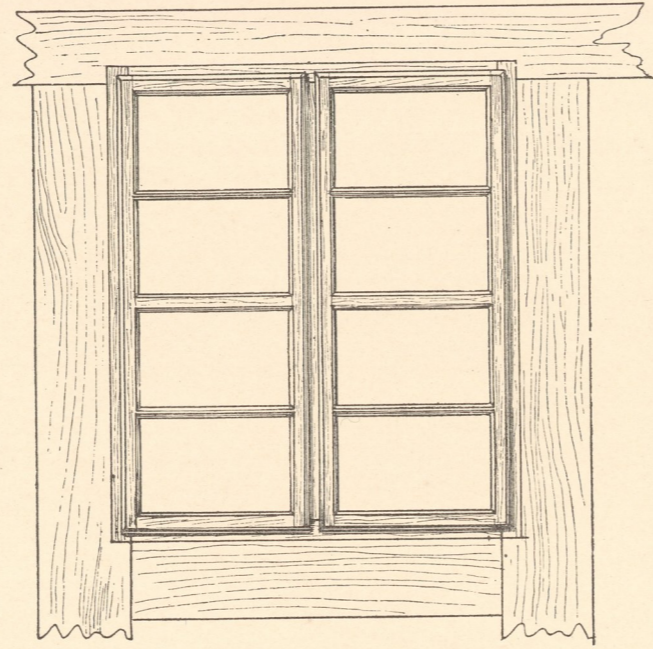

Abb. 12.

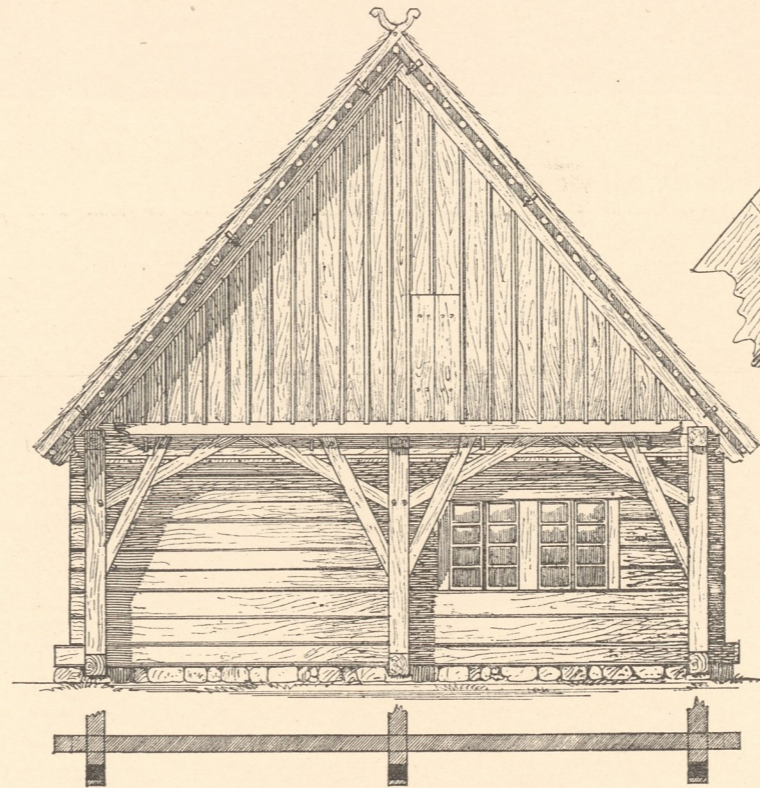

Abb. 8.

Construction der Giebelsanordnung Abb. 7.

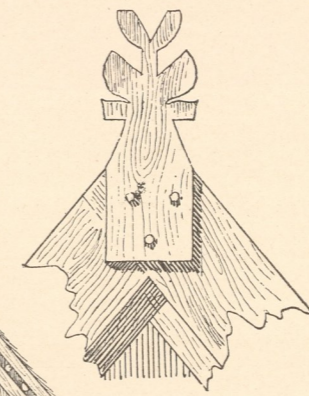

Abb. 4, 5, 6, Thür, Fenster und Dachbord des Hauses aus Dlugi.

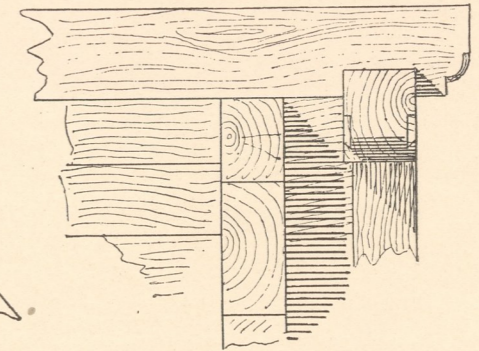
Abb. 6.



Abb. 9. Leipe.

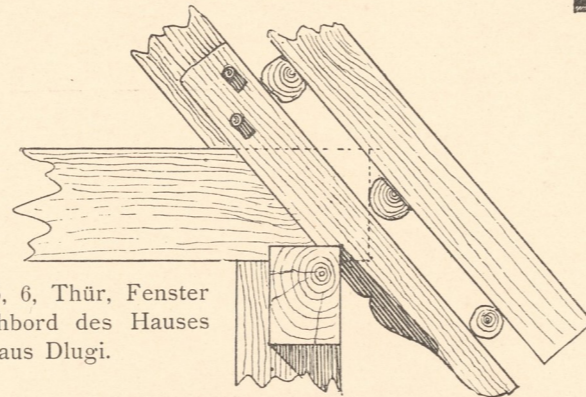

Abb. 10. Burg.

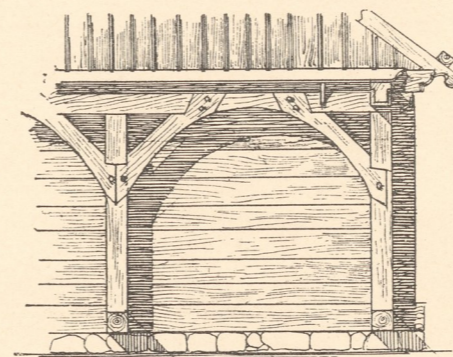

Abb. 11 u. 12. Giebelbegründungen aus Podelzig.

Zu Abb. 3.
Zu Abb. 1, 2, 7, 9 u. 10.
Zu Abb. 4—6, 8, 11 u. 12.

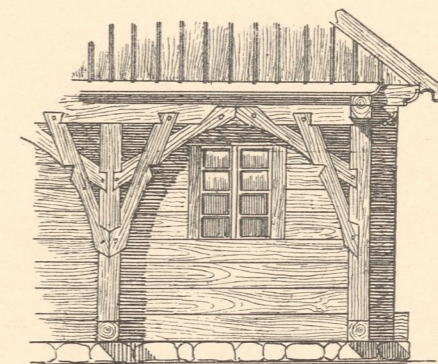
Inventory
Abb. E
Nr. 1204

Aufgen. und gez. von Ludwig Hercher unter Leitung von Hugo Hartung.

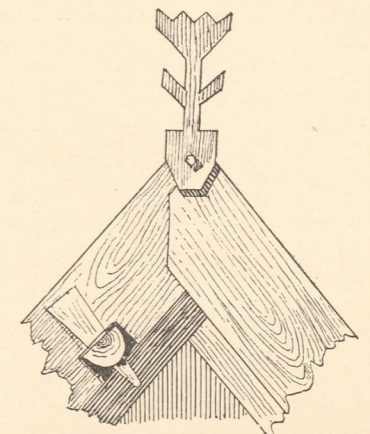
Zinkhochätzung von Albert Frisch, Berlin W.

Verlag von Gerhard Kühtmann, Dresden.



UB
TUG