

Abb. 7. Galeriedetail.

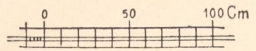

Masstab zu Abb. 7.



Abb. 8. Balkenkopf der Giebelaltane.



Masstab zu Abb. 8 und 9.

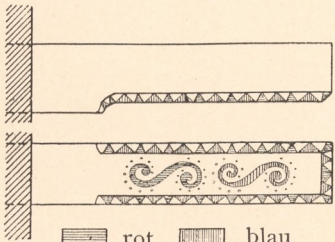
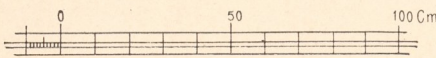

Abb. 1. Vorderansicht.



Masstab zu Abb. 1, 2, 3, 4 und 5.

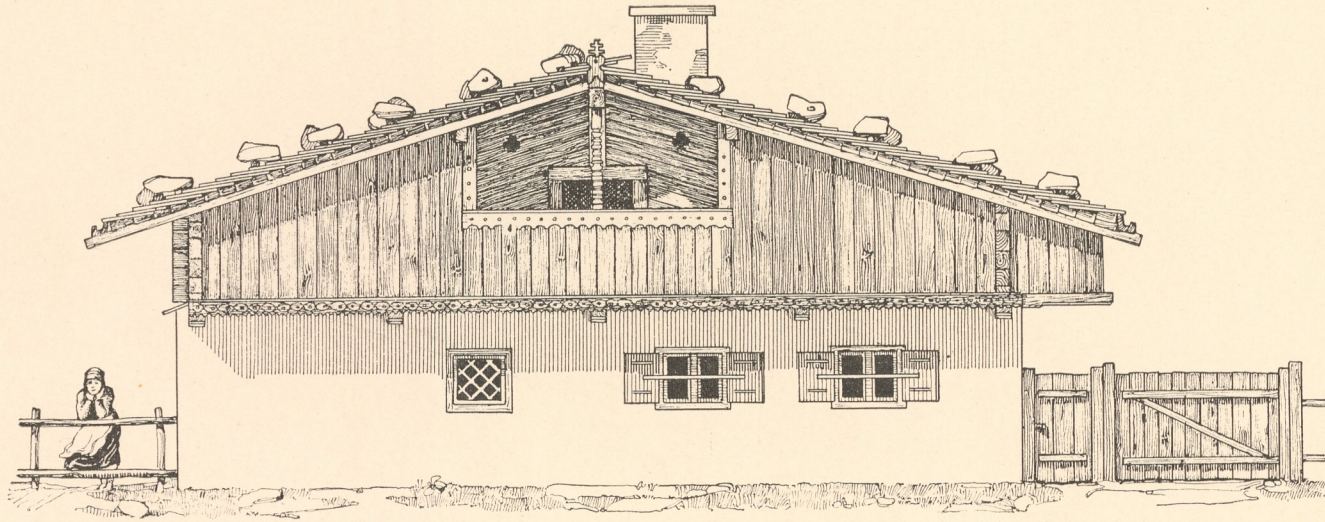
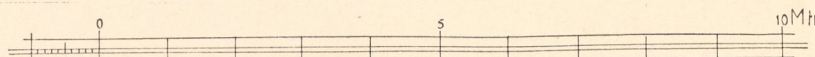

Abb. 5. Frontschnitt.

Abb. 11. Holzdecke im Bauernhaus des M. Renner in Prennberg H. N. 11.



Masstab zu Abb. 11 und 12.

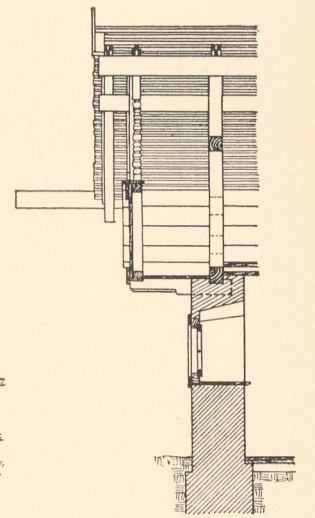
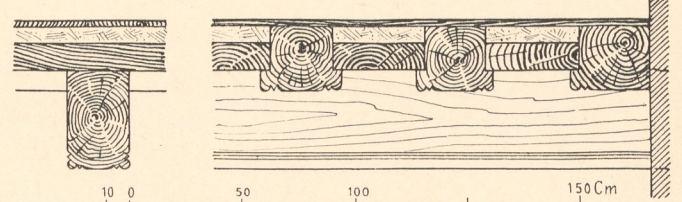

Abb. 2. Schnitt durch die Wohn- und Schlafstube.



Abb. 6. Grundriss.

Masstab zu Abb. 6.

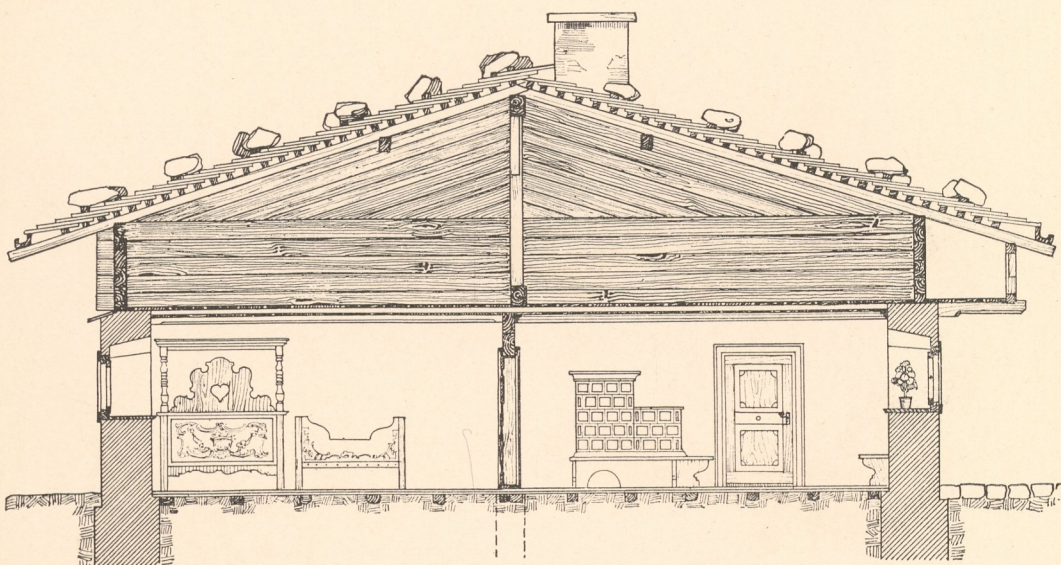

profiliertes Brett, schwarz gebeizt.

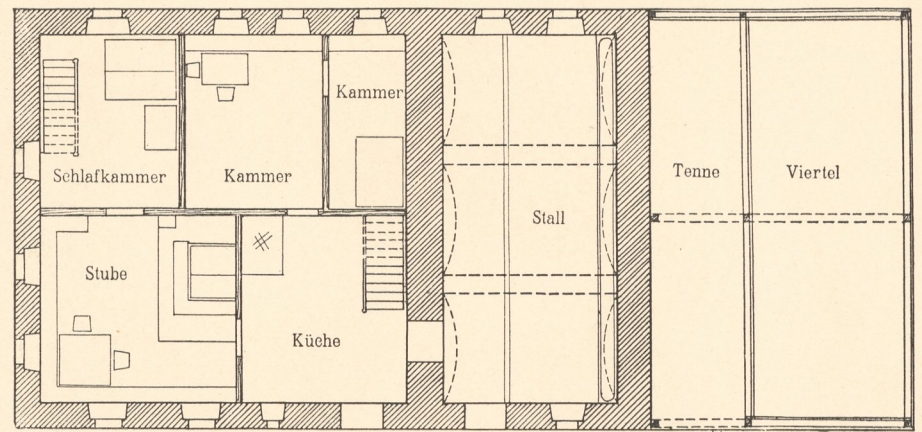
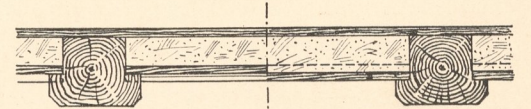
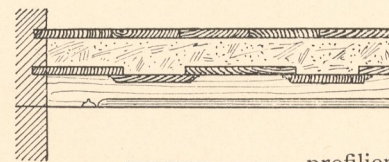
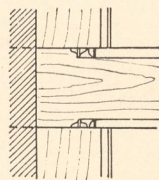
Abb. 12. Holzdecke im Wirtshaus in Windischbergersdorf, Bez.-Amt Cham.



Abb. 3. Längsansicht.



Masstab zu Abb. 10.

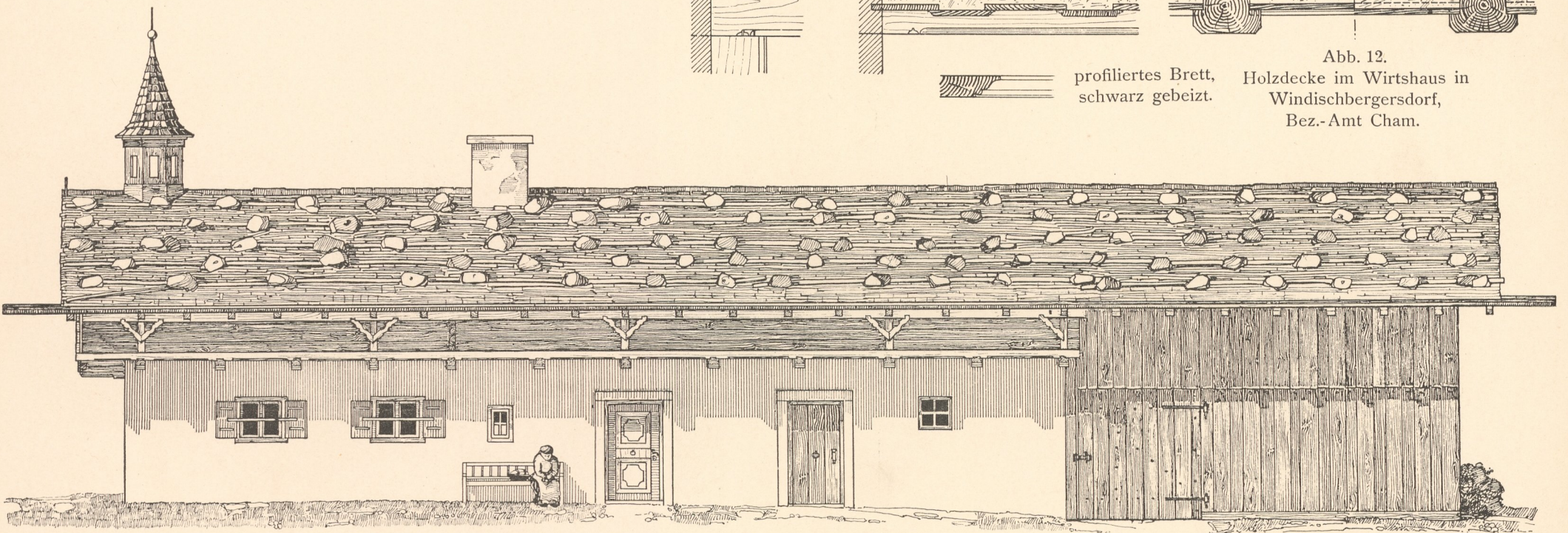
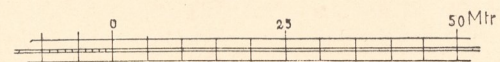

Abb. 4. Schnitt durch den Stall.



Abb. 9. Säulchen der Giebel-Altane, rot, blau und grün gemalt.

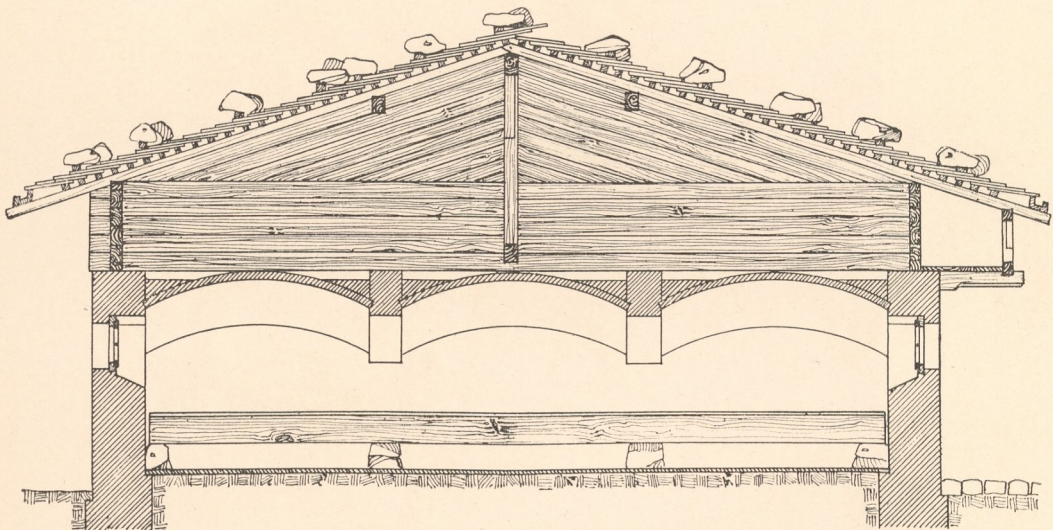

Abb. 10. Lageplan.

Aufgen. von A. Niedermayer
gez. von Aumer und Feller.

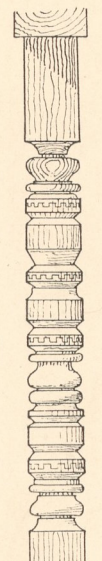
Zinkhochätzung von Albert Frisch, Berlin W.

Verlag von Gerhard Kühtmann, Dresden.

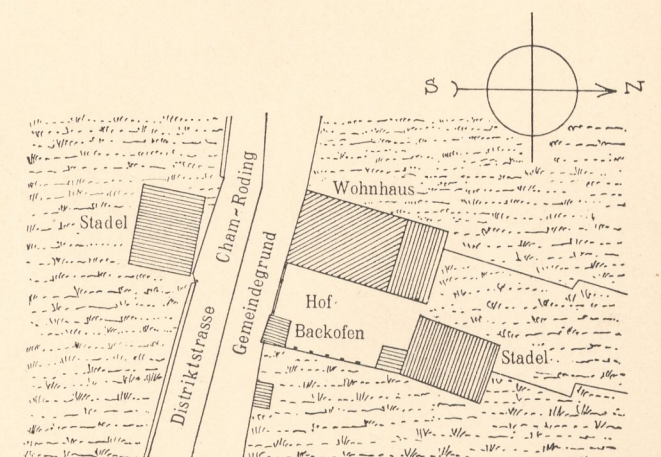