

Abb. 1. Westansicht.



Abb. 2. Vorderansicht.



Abb. 18. Kehlbalcken-Aufhängung bei A (Abb. 4).

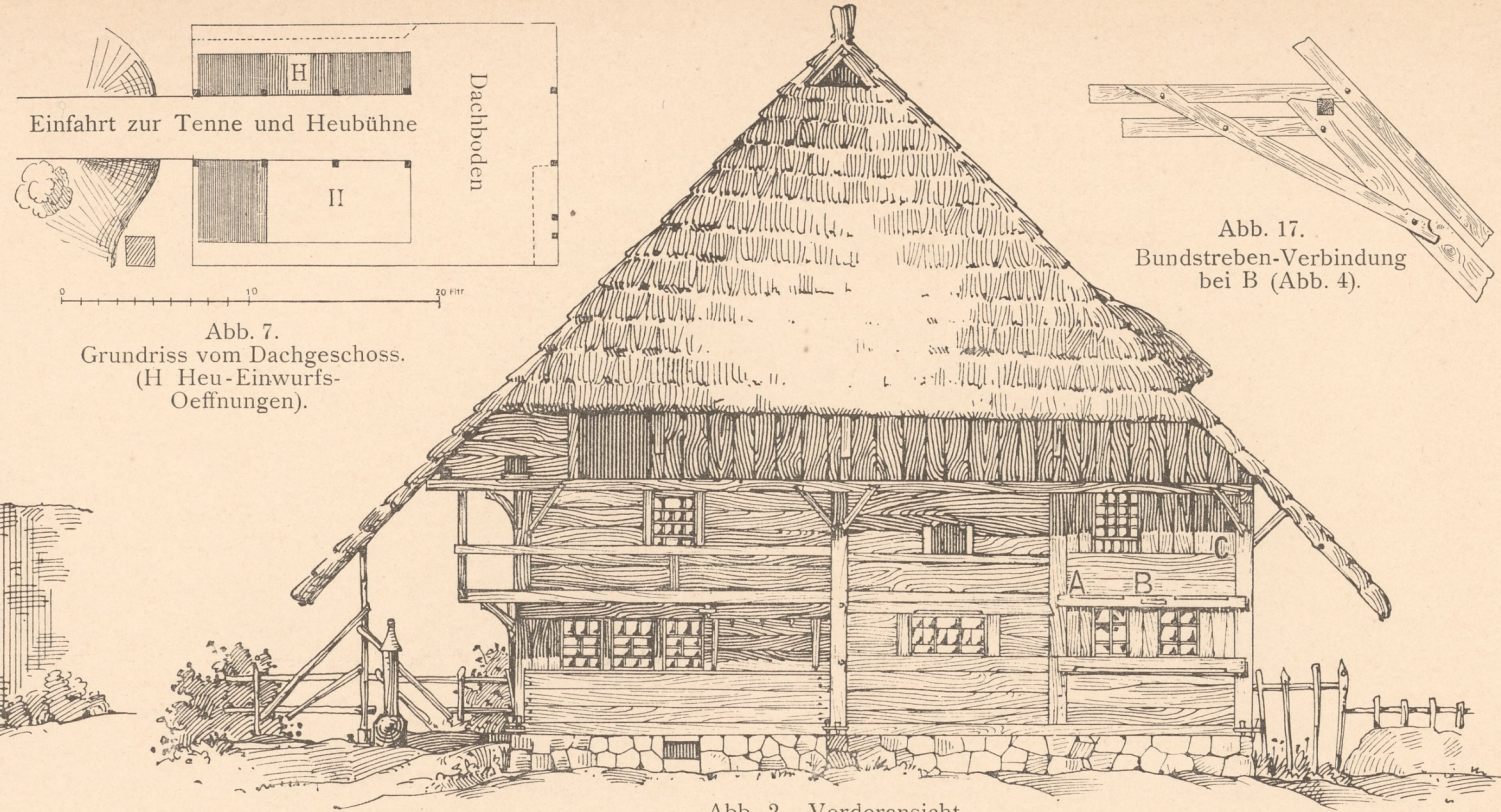

Abb. 7. Grundriss vom Dachgeschoss. (H Heu-Einwurfs-Oeffnungen).

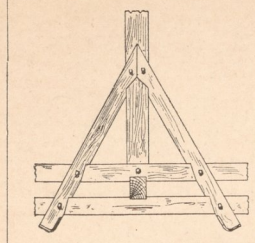

Abb. 17. Bundstreben-Verbindung bei B (Abb. 4).

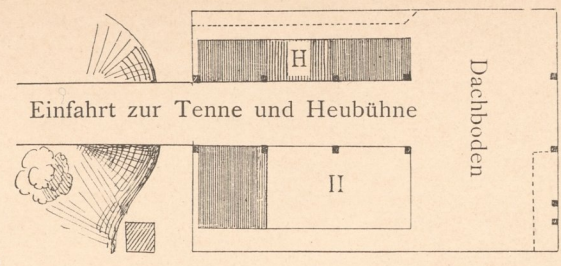

Massstab zu Abb. 1-4.

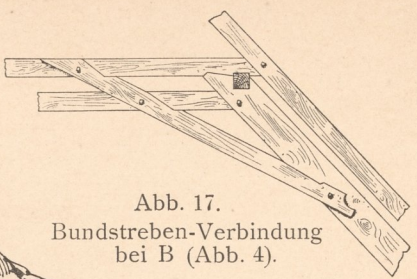
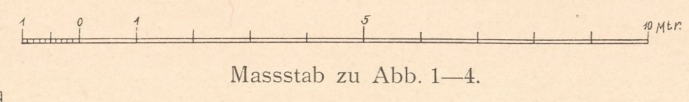

Abb. 8. Schnitt durch die Küche.

Abb. 9. Konstruktion des Küchen-Rauchfanges R in Abb. 8.



Abb. 11. Deckenunterzug in der Stube.

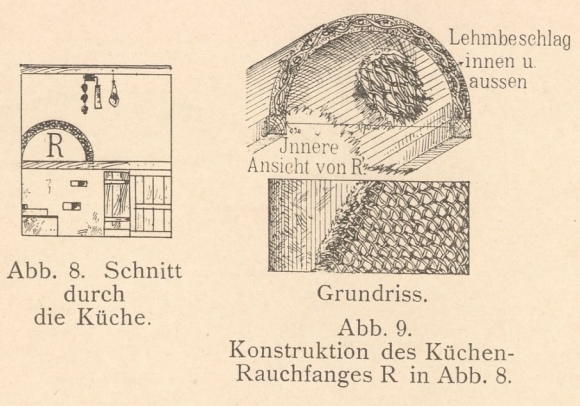

Abb. 12. Tennen-Einfahrtsthor und Verschluss bei A (Abb. 3).

Abb. 10. Deckleiste (zu Abb. 11).

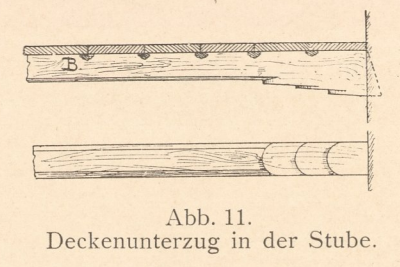

Abb. 13. Holzschloss der Küchentür.

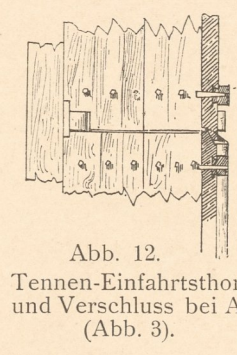

Abb. 15. Keilbohlen bei B (Abb. 2).

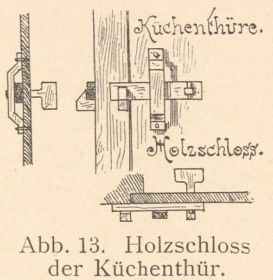
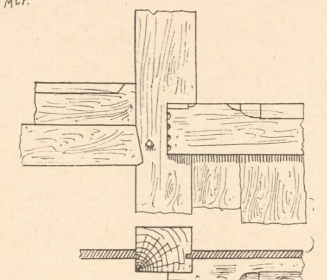

Abb. 14. Detail bei A (Abb. 2).

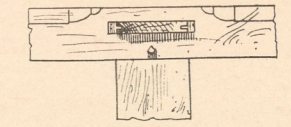

Abb. 16. Kopfband bei C (Abb. 2).

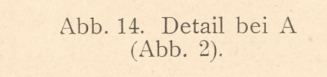

Abb. 6. Obergeschoss.

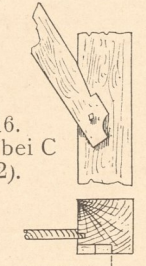

Abb. 5. Erdgeschoss.

Massstab zu Abb. 5 und 6.

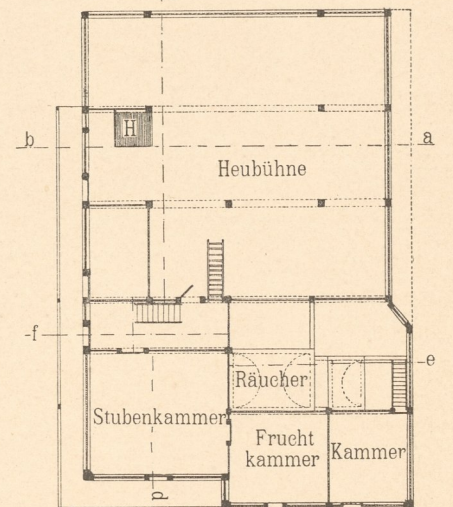

Abb. 3. Längenschnitt c d.

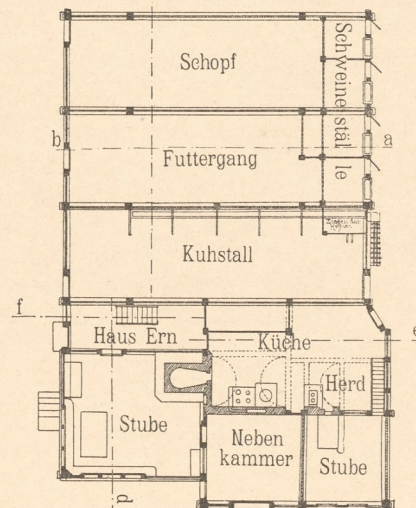

Abb. 4. Querschnitt a b.

inventar
Abth E
Nr. 1204

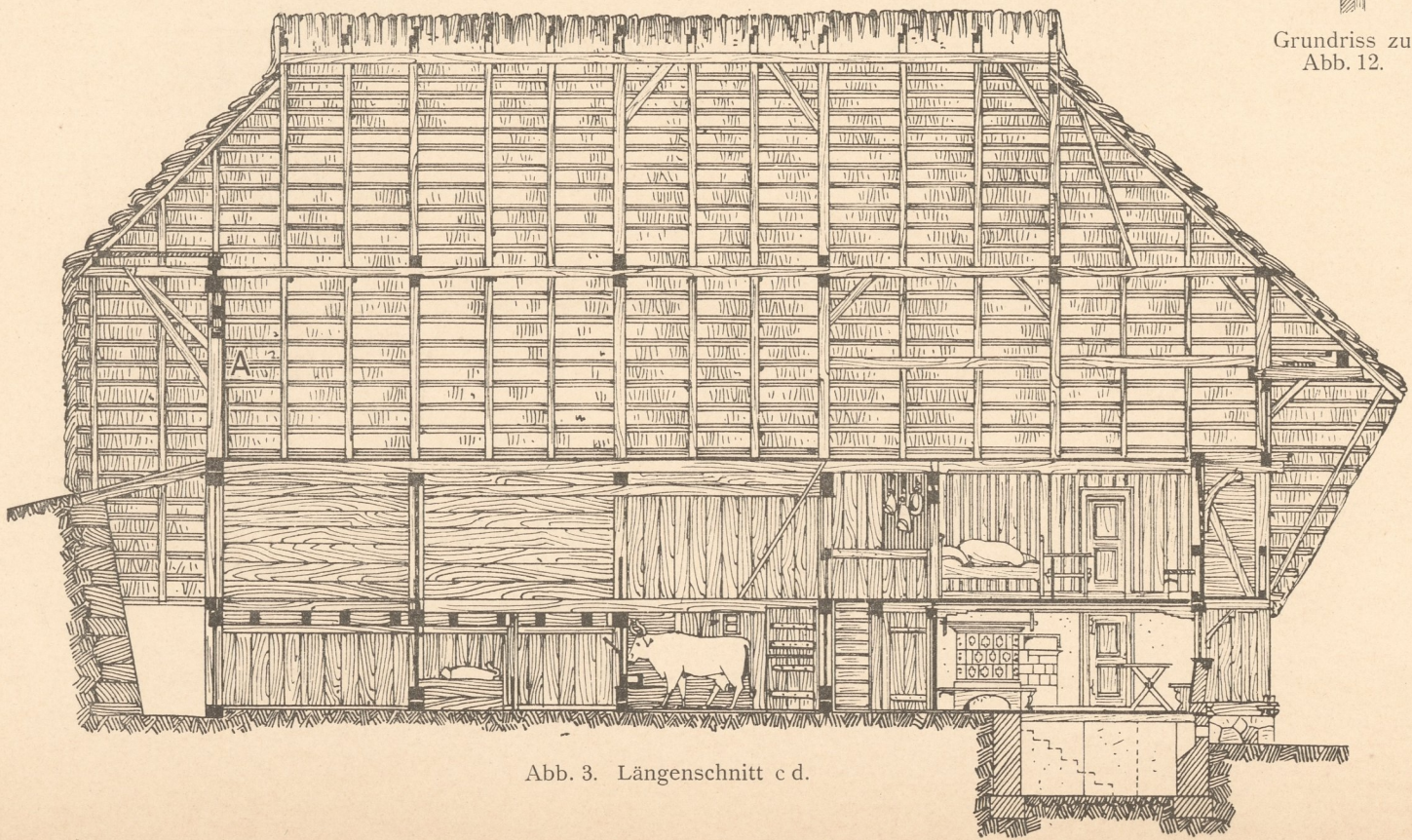
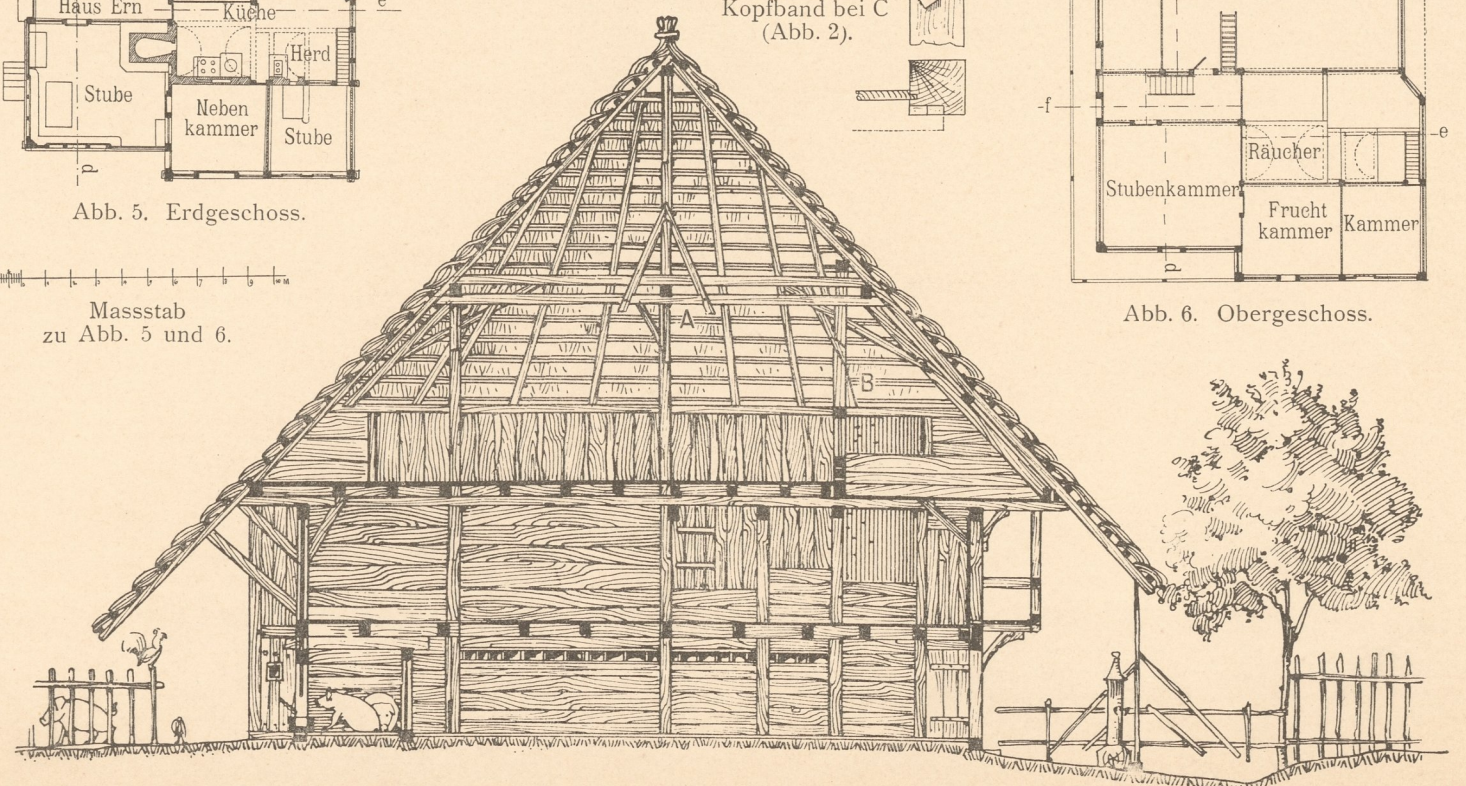