

Abb. 1. Vordere Ansicht.



Abb. 11.



Abb. 12.

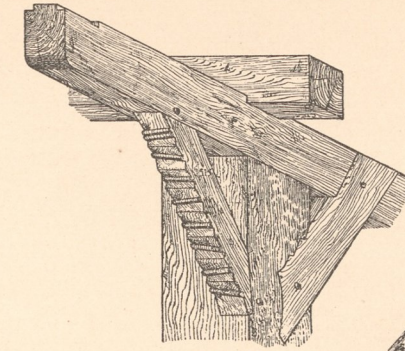

Abb. 3. Ansicht gegen das Thal.

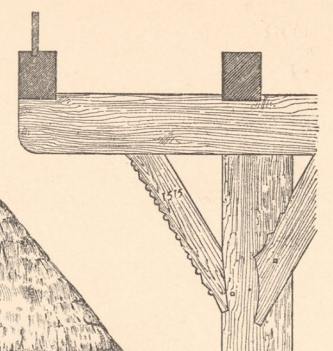

Abb. 2. Längenschnitt.

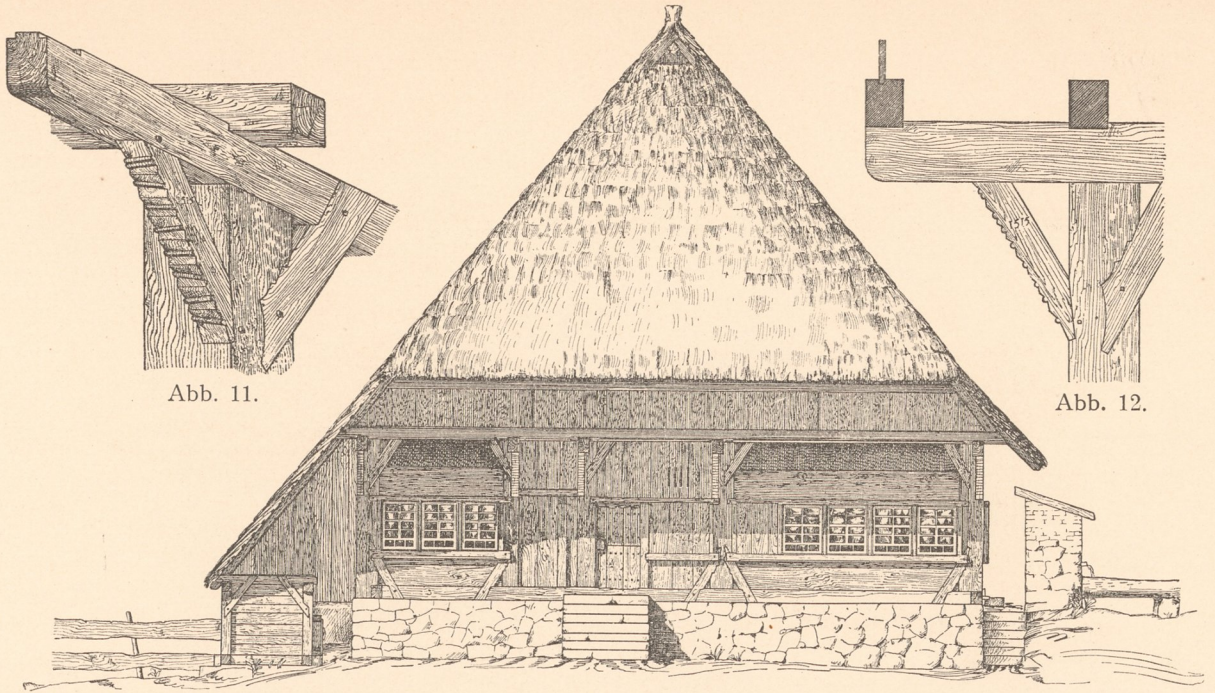

Abb. 5.

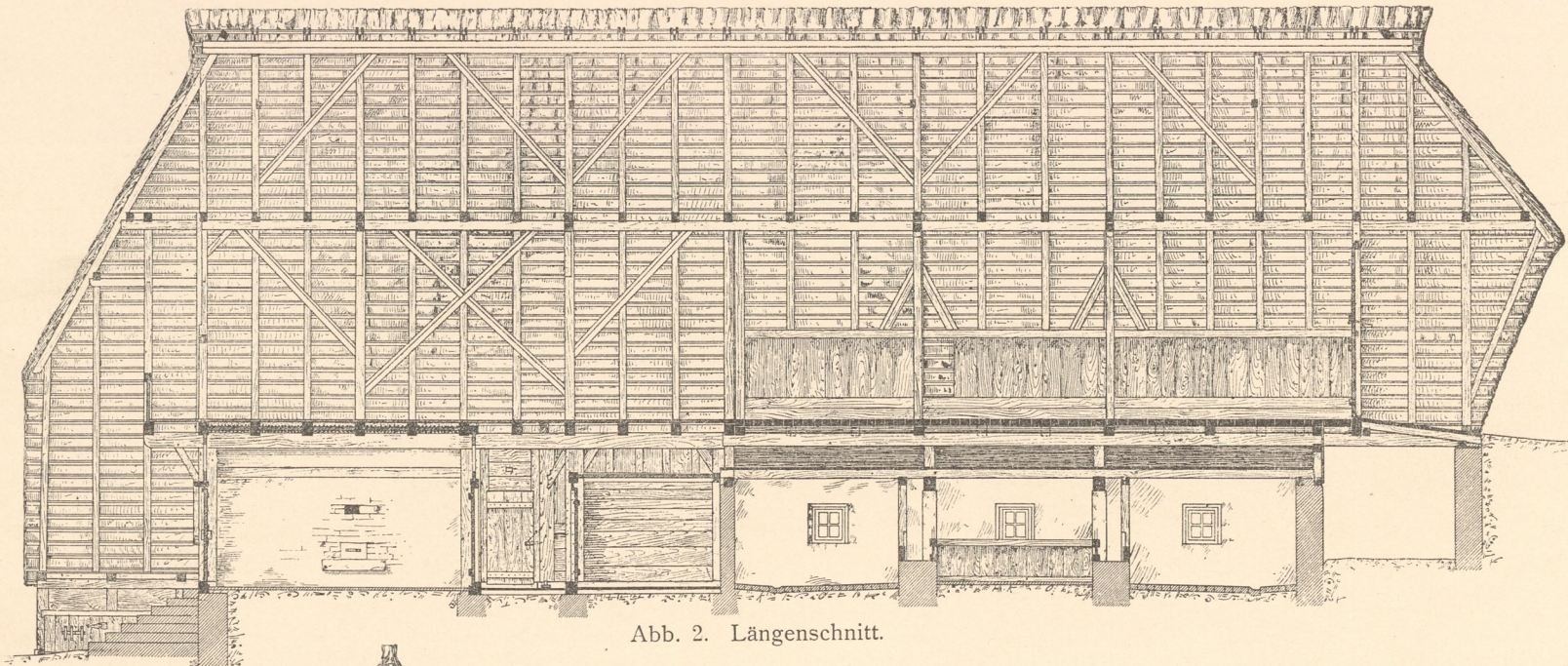

Abb. 6. Schnitt C E.

X. Schieber.

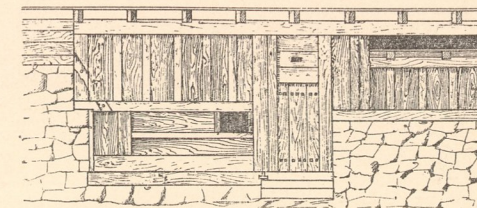

Abb. 4. Schnitt A B.

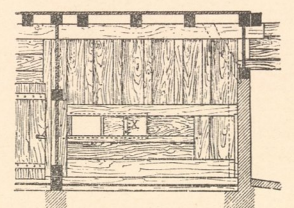

Abb. 7. Schnitt B C.

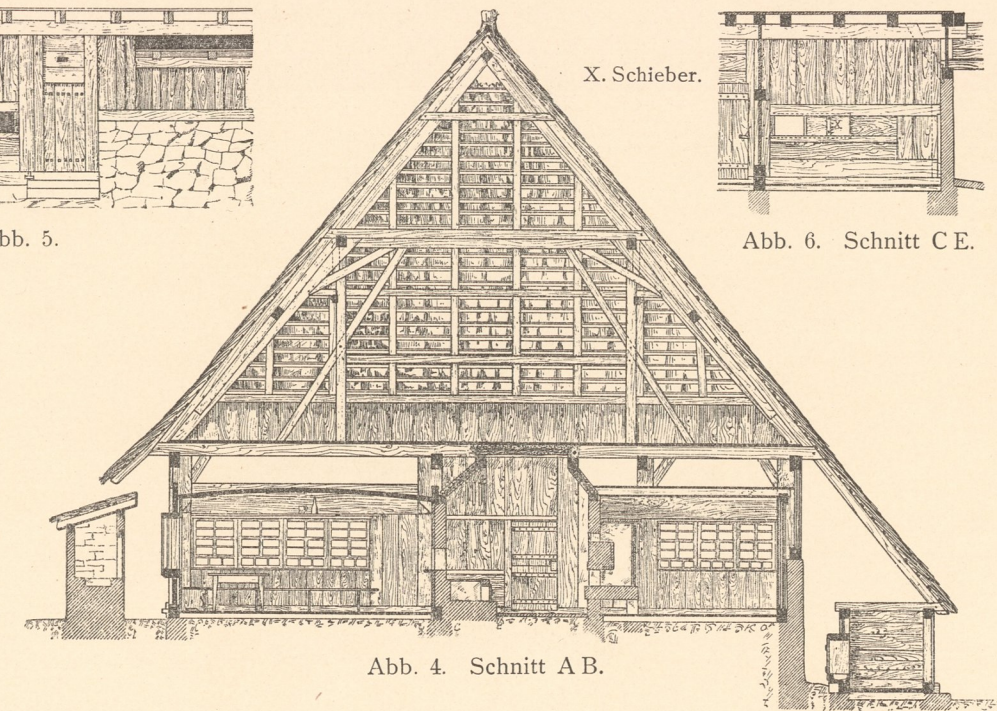

Abb. 8. Ansicht gegen das Thal. Speicherbau.

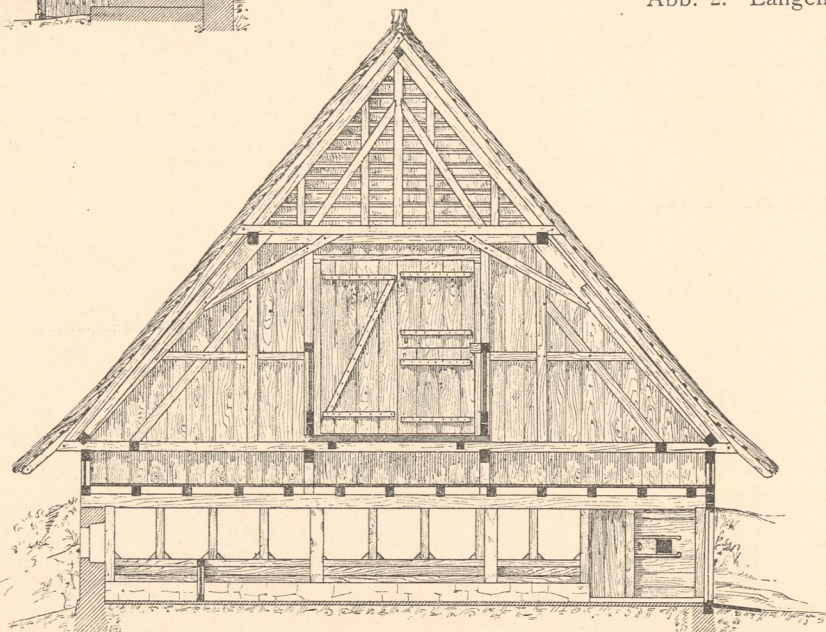

Abb. 9. Giebelansicht.

Zu Abb. 10.

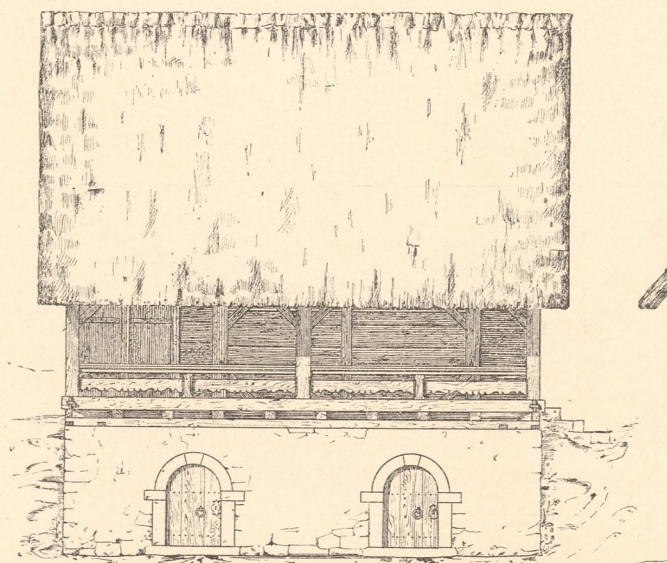
„ „ 11 und 12.

„ „ 1—9.

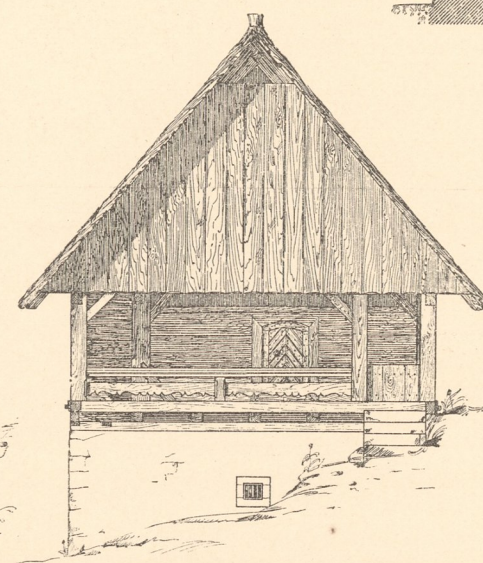

Abb. 10. Grundriss.



Inventar
Abth. E
Nr. 1204

Aufgen. unter Leitung von Kossmann.

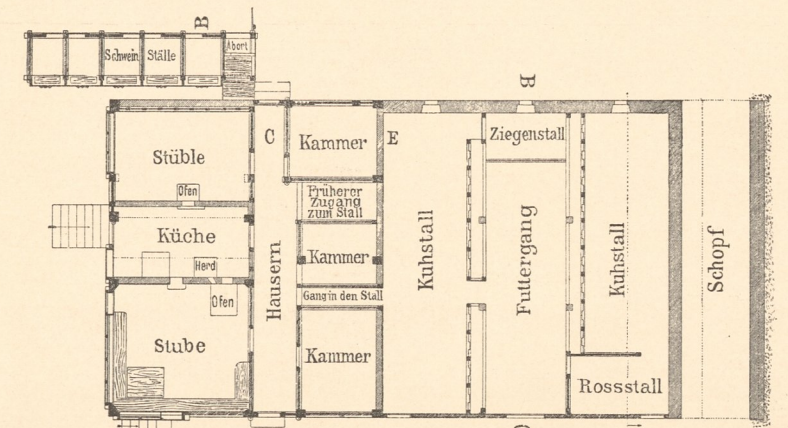
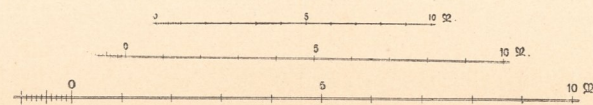
Zinkhochätzung von Albert Frisch, Berlin W.

