

1:500
0 1 2 3 4 5 10 15 20m

Fig. 338. Erdgeschoss.

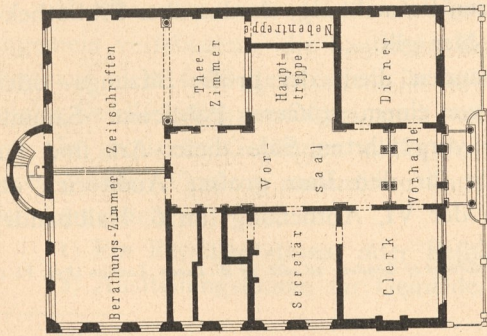

Arch.: Wyatt.

Haus der Institution of civil engineers in London 338).

Fig. 339. Obergeschoss.

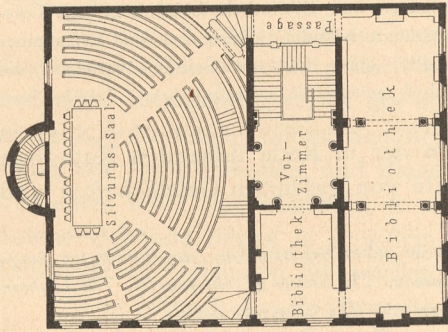
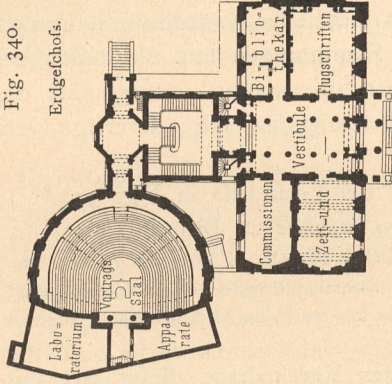

Fig. 340.

Erdgeschoss.



Arch.: Brooks.

Fig. 341.

Obergeschoss.

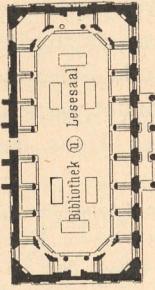

Haus der London institution zu London 336).

Fig. 342.

I. Obergeschoss.

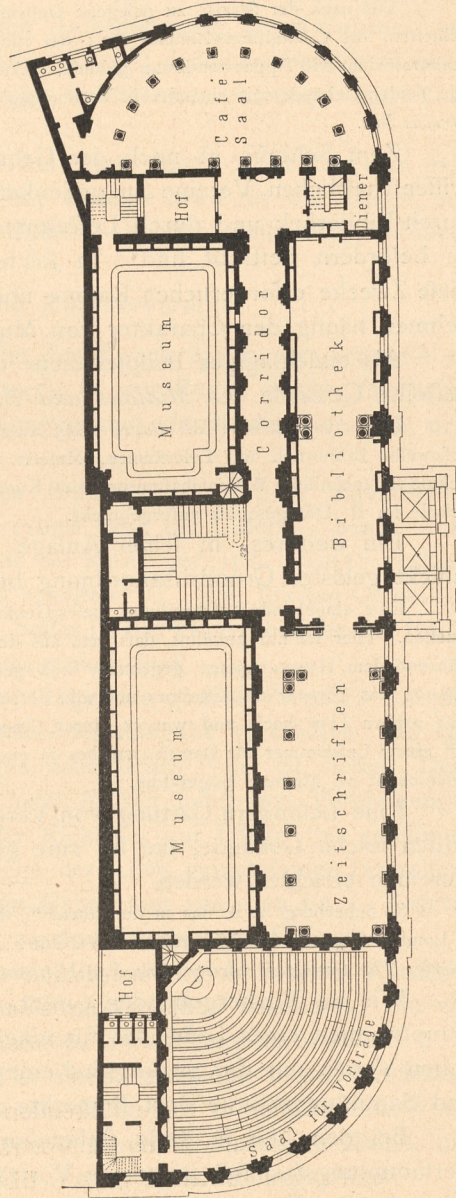

Arch.:

Edward M. Barry.

Haus des Midland and Birmingham institute in Birmingham 337).