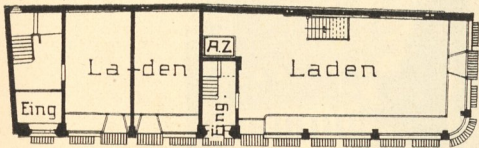

Fig. 162.



Schaubild.

Fig. 163.



Erdgeschoss.

Fig. 164.

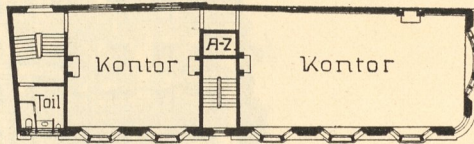

I. Obergeschoss.

1:500

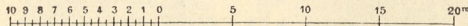

Geschäftshaus zu Birmingham, *Bullstreet*²⁹⁾.

Arch.: *Effex, Nicol & Goodman.*

Literatur

über »Geschäfts-, Kauf- und Warenhäuser«.

α) Anlage und Einrichtung.

Architecture chinoise. Maisons pour le commerce, boutiques. Revue gén. de l'arch 1859. S. 97.

ROBERTON, J. *The arrangement of warehouses. Builder*, Bd. 18, S. 521.