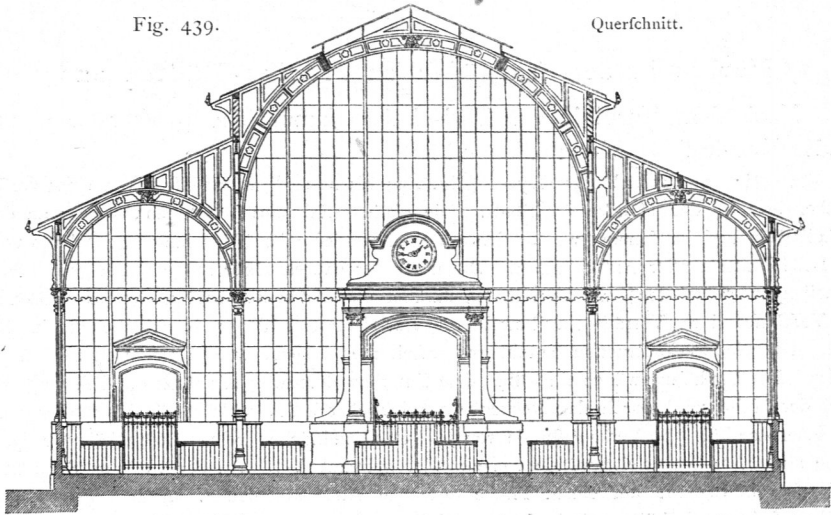

Fig. 439.

Querschnitt.

Arch.:
Desjardins.



Facf.-Repr.
nach:
Allg. Bauz.
1862, Bl. 513.

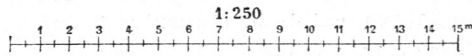
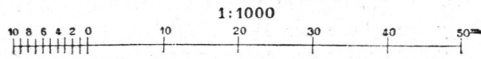
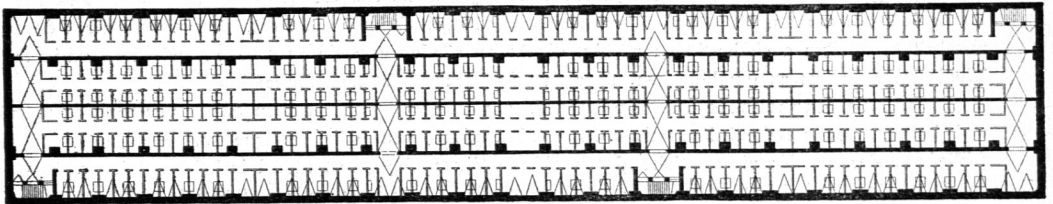
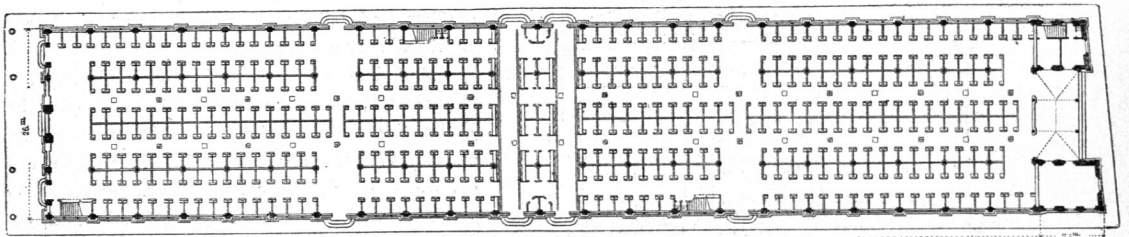

Fig. 440. Kellergeschofs.



Facf.-Repr. nach: HENNICKE, J. Mittheilungen über Markt-
hallen etc. Berlin 188r. Bl. XV.

Fig. 441. Erdgeschofs.



134 m

Fig. 442. Längenanficht.

Fig. 443. Längenschnitt.

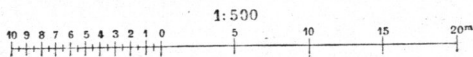
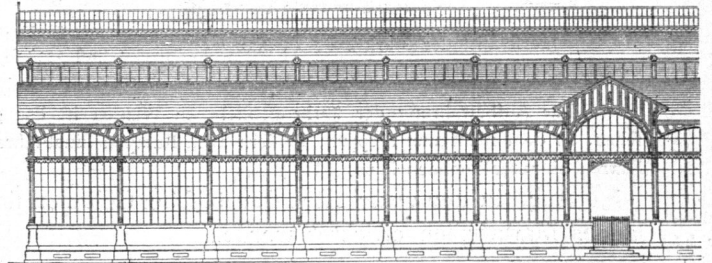
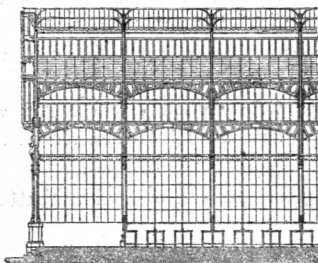

Nach: Allg. Bauz. 1862, Bl. 511.

Markthalle zu Lyon.