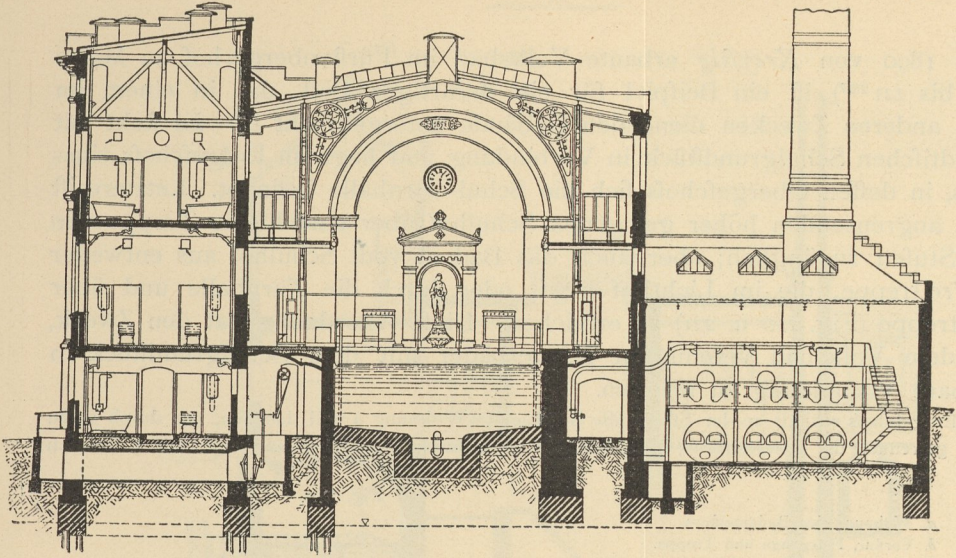
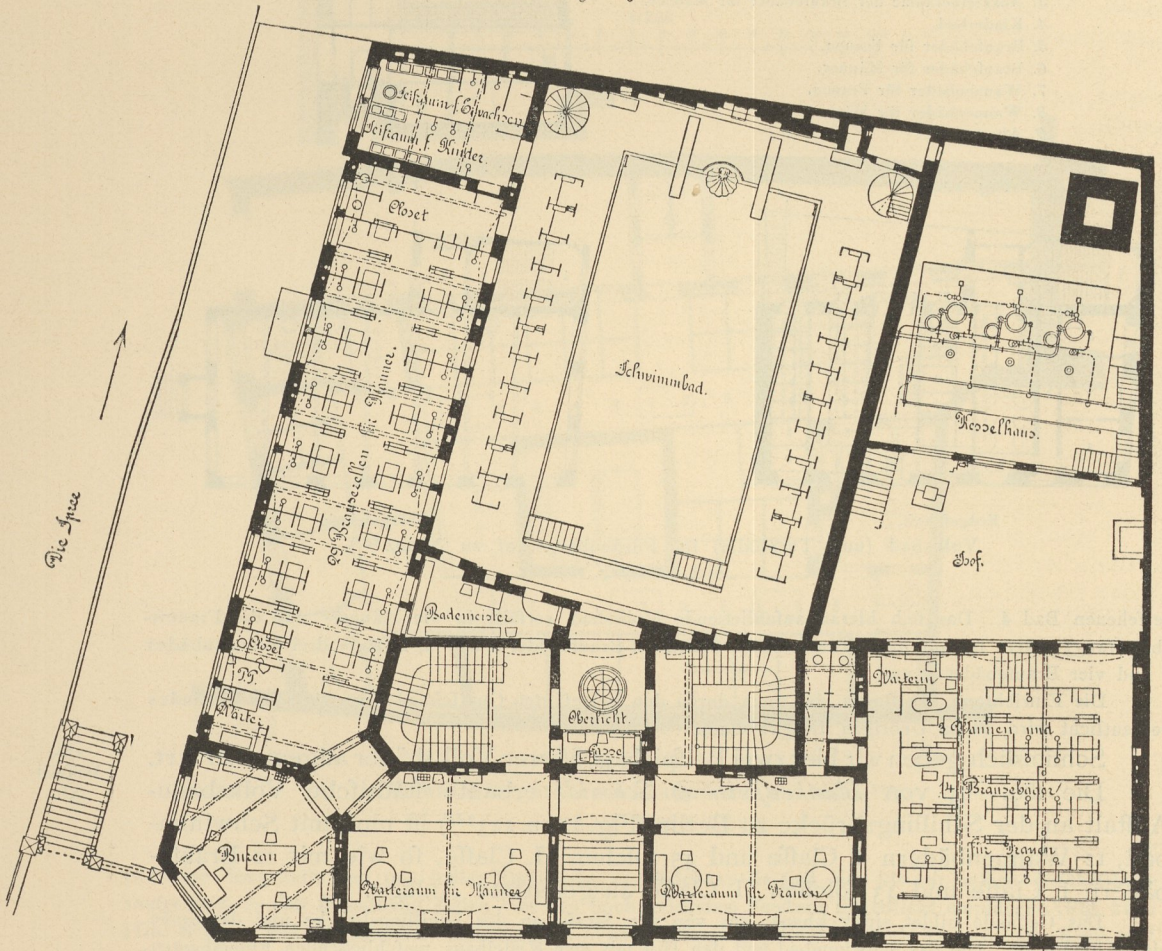

Fig. 222.



Schnitt. —  $\frac{1}{300}$  n. Gr.

Fig. 223.



Erdgeschoss. —  $\frac{1}{300}$  n. Gr.

Städtische Volksbade-Anstalt an der Schillingsbrücke zu Berlin<sup>228</sup>.

Arch.: Blankenstein & Schmidt.