

Eiserne Brücken:

Balkenbrücken.

Fig. 1.
Längenschnitt.

Brücke über den Oosbach in Baden.

Fig. 2.
Längenschnitt.

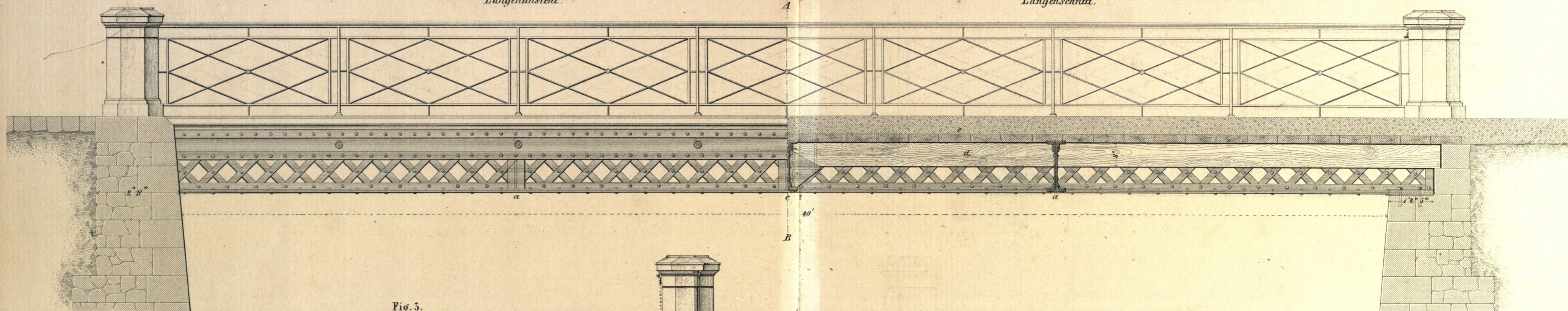

Fig. 3.
Querschnitt.

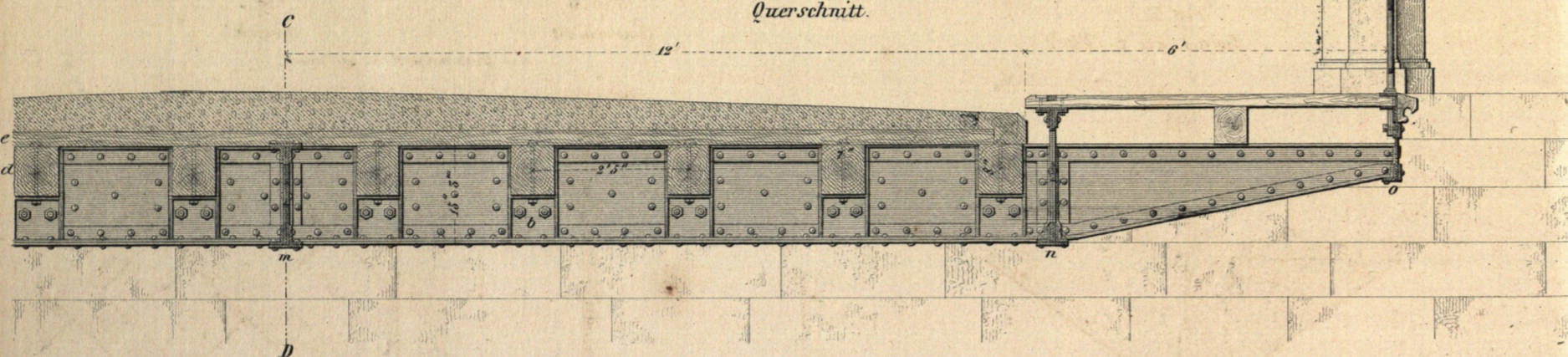
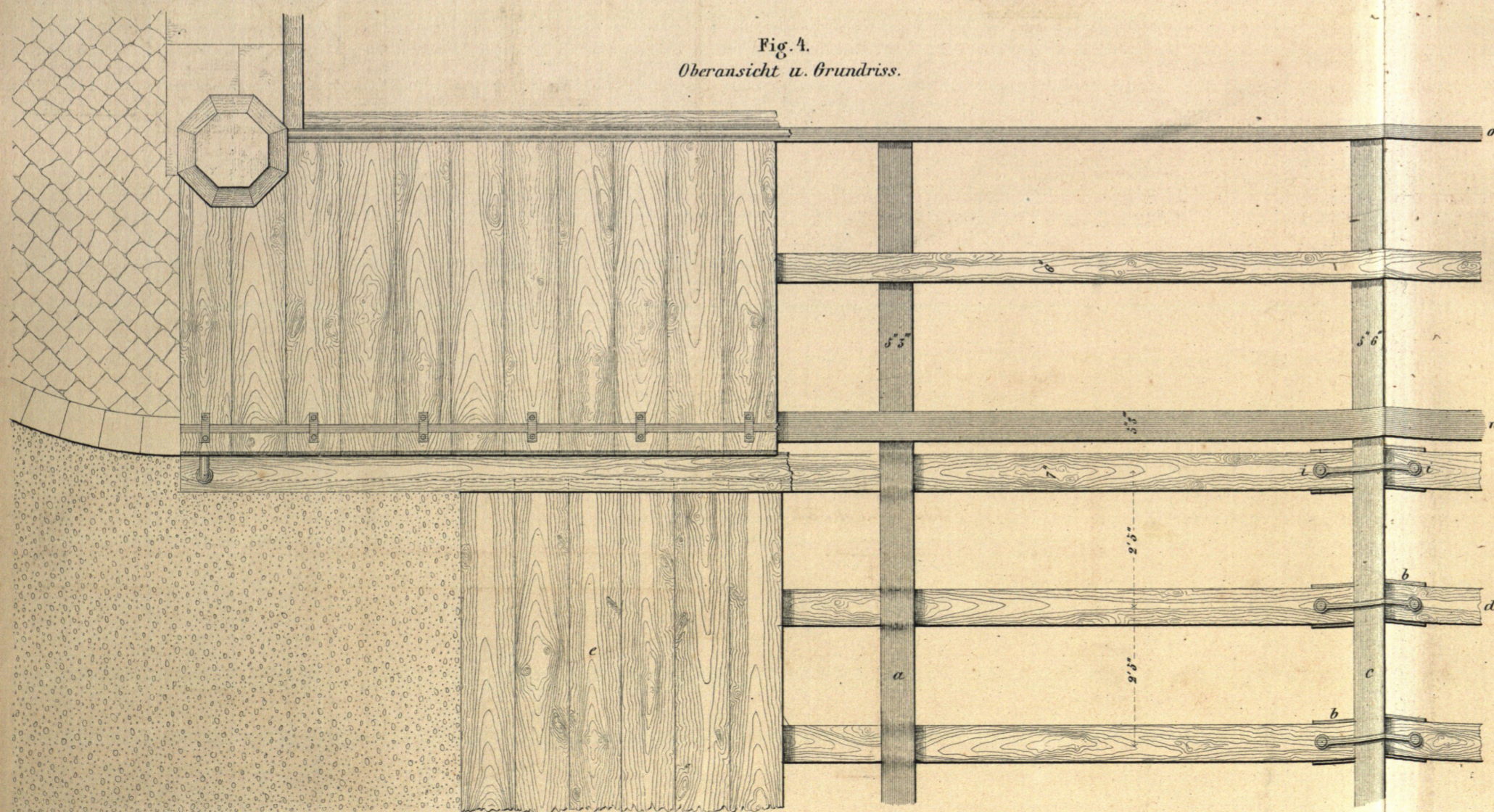

Fig. 4.
Oberansicht u. Grundriss.



Zu Fig. 1-4. 10 20 30 40 50 60 70 80 90 100 110 120 130 140 150 160 170 180 190 200 Fuss bad. / M = 1,50/

10 dm. 5 0 1 2 3 Meter

Fig. 5.
Detail zu c. (Fig. 2.)

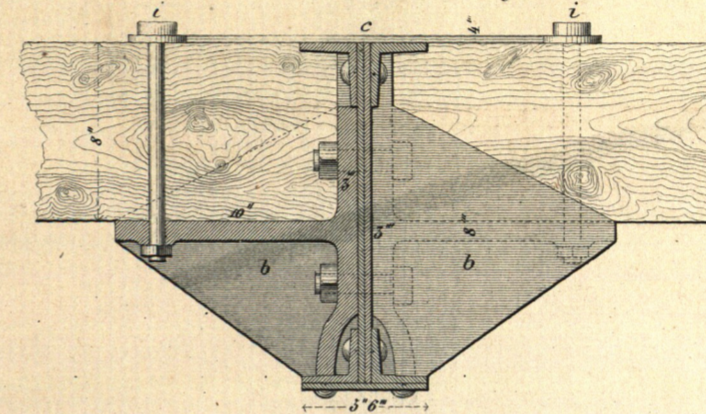

Fig. 6.
Querschnitt

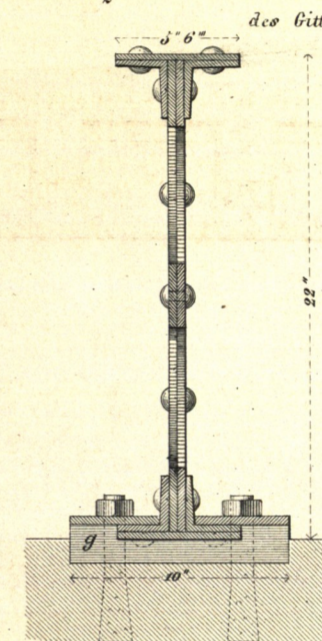

Fig. 7.
Ansicht

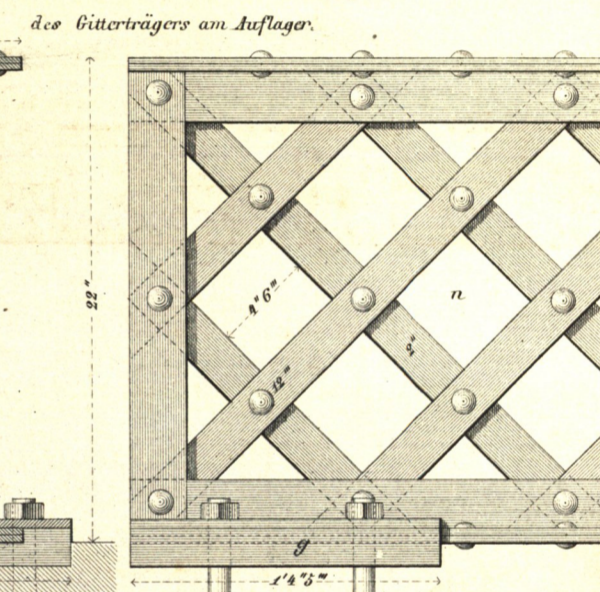

Fig. 10.

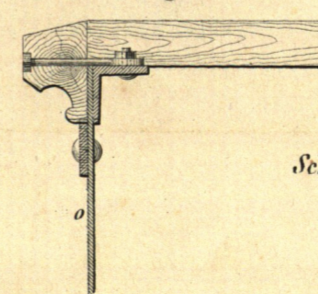
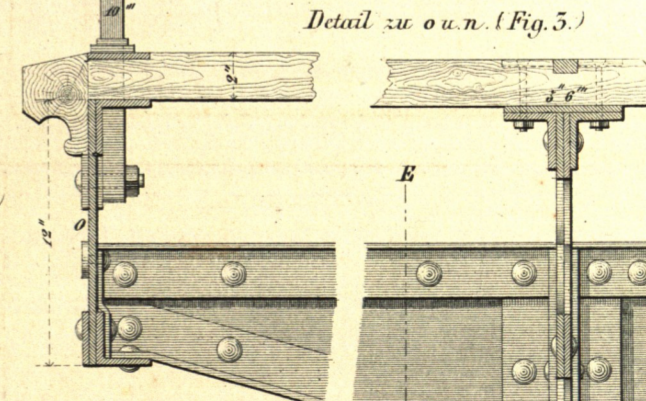

Fig. 11.
Schnitt nach (EF)

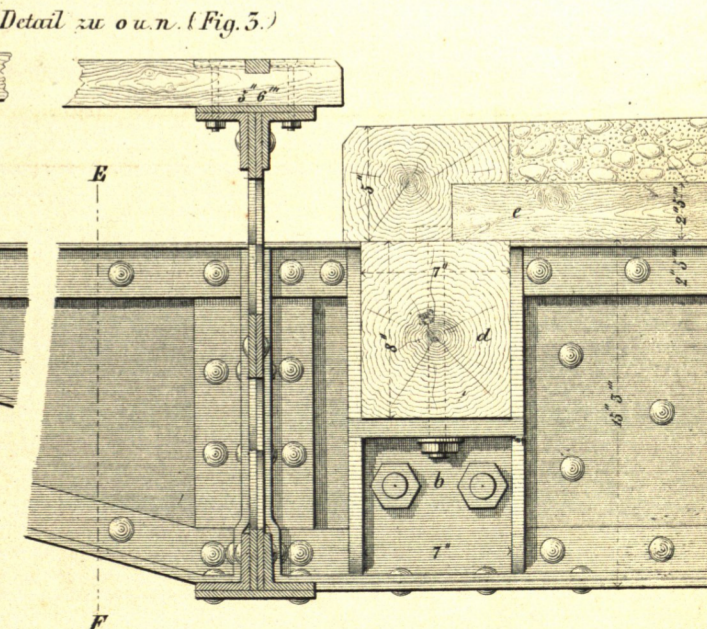

Fig. 8.



Detail zu o u. n. (Fig. 5.)

Fig. 9.



Zu Fig. 5-11. 10 20 30 40 50 60 70 80 90 100 110 120 130 140 150 160 170 180 190 200 Fuss bad. / M = 1,50/

10 dm. 5 0 1 2 3 Decimeter